

SRI

STATE OF INDIANA  
LAKE COUNTY  
FILED FOR RECORD

2000 061309

2000 AUG 24 AM 8:44

MORTGAGE CLERK  
RECORDS

Prescribed by the State Board of Accounts

# TAX TITLE DEED TO COUNTY

Whereas the LAKE County Board of Commissioners did the 3rd day of April, 2000 produced to the County of LAKE, in the State of Indiana, a certificate of sale dated the 20th day of September, 1999, signed by PETER BENJAMIN who, at the date of sale, was Auditor of the County, from which it appears that said County on the 20th day of September, 1999, obtained, pursuant to law, the real property described in this indenture for the sum of THREE THOUSAND, TWO HUNDRED THIRTY-FIVE AND 83/100 DOLLARS (\$3,235.83) being the amount due on the following tracts of land returned delinquent in the name LAKE COUNTY TRUST CO., TR., TR.NO. for 1998 and prior years, namely:

Property ID: 25-45-0079-0030  
Property Address: 162-64 TIPPECANOE GARY, IN 46403  
LOT 30, BLOCK D, INLAND MANOR 1ST ADDITION, IN THE CITY OF GARY, LAKE COUNTY, INDIANA.

Such real property has been recorded in the Office of the LAKE County Auditor as delinquent for the nonpayment of taxes and proper notice of the sale has been given. It appearing that LAKE County is the owner of the certificate of sale, that the time of redeeming such real property has expired, that the property has not been redeemed, that the LAKE County Commissioners have demanded a deed for the real property described in the certificate of sale, that the records of LAKE County Auditor's Office state that the real property was legally liable for taxation, and the real property has been duly assessed and properly charged on the duplicate with the taxes and special assessments for 1998 and prior years:

Therefore, this indenture, made this 3rd day of April, 2000 between the State of Indiana by PETER BENJAMIN, Auditor of LAKE County, of the first part, and LAKE County of the second part, witnesseth; That the party of the first part, for and in consideration of the premises, has granted and bargained and conveyed to the party of the second part, the real property described in the certificate of sale, situated in the County of LAKE, and the State of Indiana, namely and more particularly described as follows:

Property ID: 25-45-0079-0030  
Property Address: 162-64 TIPPECANOE GARY, IN 46403  
LOT 30, BLOCK D, INLAND MANOR 1ST ADDITION, IN THE CITY OF GARY, LAKE COUNTY, INDIANA.

to have and to hold such real property, with the appurtenances belonging thereto, in as full and ample a manner as the Auditor of said County is empowered by law to convey the same.

In testimony whereof PETER BENJAMIN, Auditor of LAKE County, has hereunto set his hand, and affixed the seal of the Board of County Commissioners, the day and year last above mentioned.

Witness: Peter Benjamin (L.S)  
PETER BENJAMIN, Auditor of LAKE County

Peggy Katona  
Attest: PEGGY KATONA  
Treasurer: LAKE County

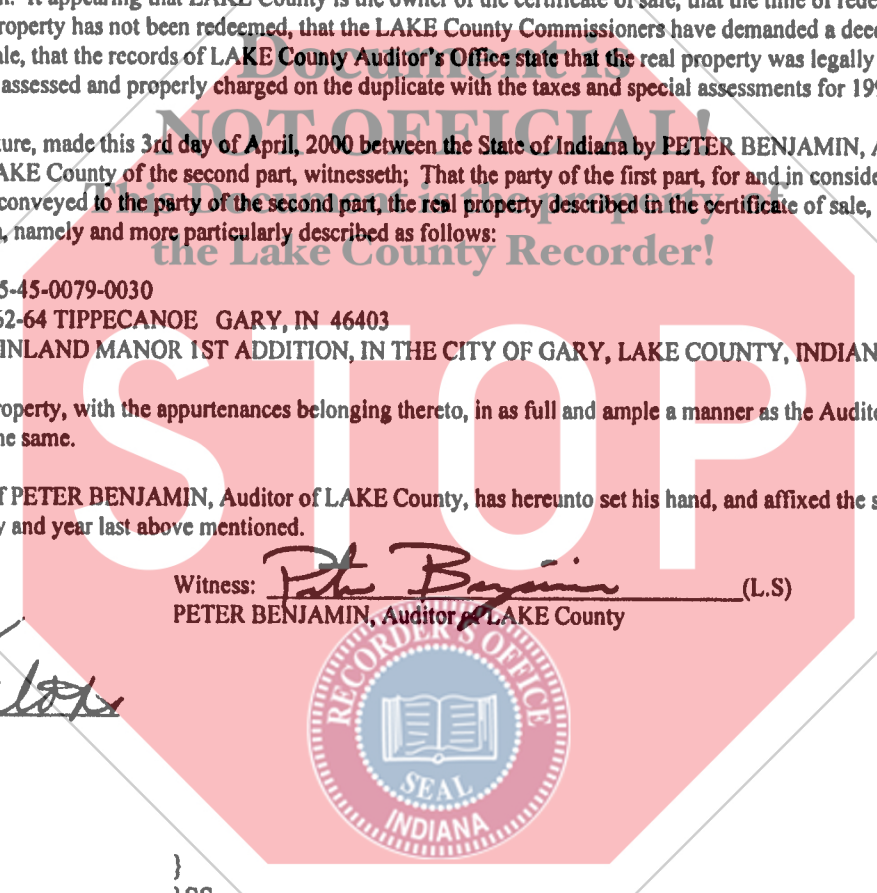

State of INDIANA }  
County of LAKE } SS.

Before me, the undersigned, Anna Anton in and for said County, this day, personally came the above name PETER BENJAMIN of said County, and acknowledged that he signed and sealed the foregoing deed for the users and purposes therein mentioned.

In witness whereof, I have hereunto set my hand and seal this APR 17 day of April, 2000.

Anna N. Anton  
Anna Anton, Clerk of LAKE County

This instrument prepared by Lee J. Christakis, Attorney  
7870 Broadway, Suite G., Merrillville, IN 46410

Post Office Address of grantee: 2293 N. Main Street  
Crown Point, IN 46307

NIC