

STATE OF INDIANA
LAKE COUNTY
FILED FOR RECORD

2000 061104

2000 AUG 23 AM 11:04
FILE NO: 200007454

MAIL TAX
STATEMENT TO:
7510 W 134th Court
Cedar Lake, Indiana 46303

RECORDS & CLERK
CORNER

QUIT-CLAIM DEED

THIS INDENTURE WITNESSETH, That, **Bernadine Perrin N/K/A Bernadine E. Perrin**, Grantor of Lake County, State of Indiana, **QUITCLAIM(S)** to **Bernadine E. Perrin**, Grantee of Lake County, State of Indiana, for the sum of Ten & 00/100 Dollars (\$10.00) and other valuable consideration, the receipt and sufficiency of which is hereby acknowledged, the following described real estate in Lake County, in the State of Indiana

LOTS 14 AND 15 BLOCK 4, RESUBDIVISION OF LOTS 1 AND 2, 69 AND 70, 89 TO 91, BOTH INCLUSIVE, 160, 161, 255 TO 377, BOTH INCLUSIVE, 382 TO 403, BOTH INCLUSIVE, OF CEDAR POINT PARK, IN THE TOWN OF CEDAR LAKE, AS SHOWN IN PLAT BOOK 21 PAGE 42, IN LAKE COUNTY, INDIANA.

Parcel No.: 31-25-0035-0014 and 31-25-0035-0015

* EXEMPT TRANSFER # 7

In Witness Whereof, Grantors have executed this deed this 15th day of August, 2000

Bernadine Perrin NKA Bernadine E. Perrin
Bernadine Perrin N/K/A Bernadine E. Perrin

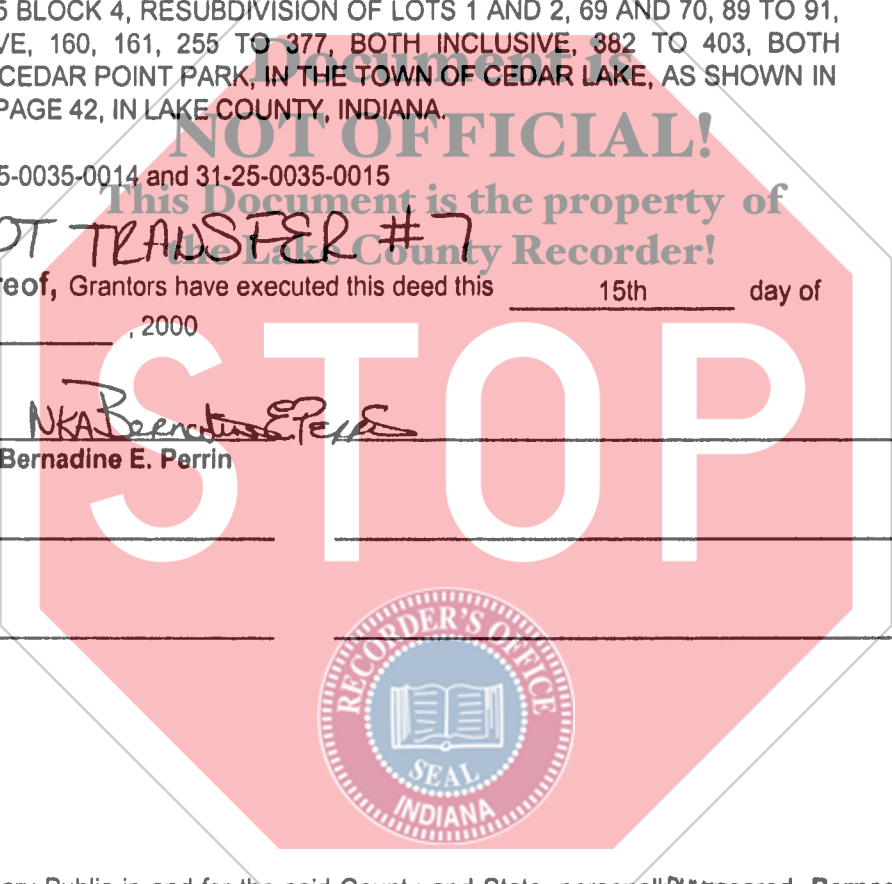

State of Indiana

County of Lake

Before me, a Notary Public in and for the said County and State, personally appeared, **Bernadine Perrin N/K/A Bernadine E. Perrin** who acknowledged the execution of the foregoing instrument and who, having been duly sworn, stated that any representations therein contained are true. **PREPARED FOR RECORDATION SUBJECT TO CANCELLATION OF TRANSFER**

Witness my hand and notarial seal this 15th day of August, AUG 23 2000

My Commission Expires: 5/2/07

Kim A. Hurtt
Kim A. Hurtt
Residing in Lake Co.

PETER BENJAMIN
LAKE COUNTY AUDITOR
, Notary Public
County, Indiana

This instrument prepared by: Timothy L. Claxton, Attorney at Law.

Attorney Identification No. 14523-02

RETURN DEED TO:

TEI Rep: JM
Merrillville

Official Seal
Kim A. Hurtt
Notary Public
State of Indiana
My Commission Expires 5/02/07

HOLD FOR
Title Express, Inc.
8585 Broadway • Ste. 680
Merrillville, IN 46410

01822
E.I. 14.00
#2134