

THIS INDENTURE WITNESSETH

STATE OF INDIANA
LAKE COUNTY
FILED FOR RECORD

That THOMAS S. JEZ, ANN MARIE PANEK and MARY JO JEZ

2000 060765

2000 AUG 23 AM 8 50

of Lake County, and State of Indiana

RELEASE & QUIT CLAIM

To SOPHIE ANN JEZ

of Lake County, and State of Indiana

for the sum of TEN AND 00/100THS (\$ *10.00*) Dollars,
and other good and valuable consideration, the receipt of which is hereby acknowledged. The following
described Real estate, in Lake County, in the State of Indiana, to wit:

Lot 22 (except the North 39.62 feet thereof) and the North 35 feet of Lot 21 in Block 6 in Hammond Steel
City Addition to Hammond, as per plat thereof, recorded in Plat Book 17, Page 18, in the Office of the
Recorder of Lake County, Indiana.

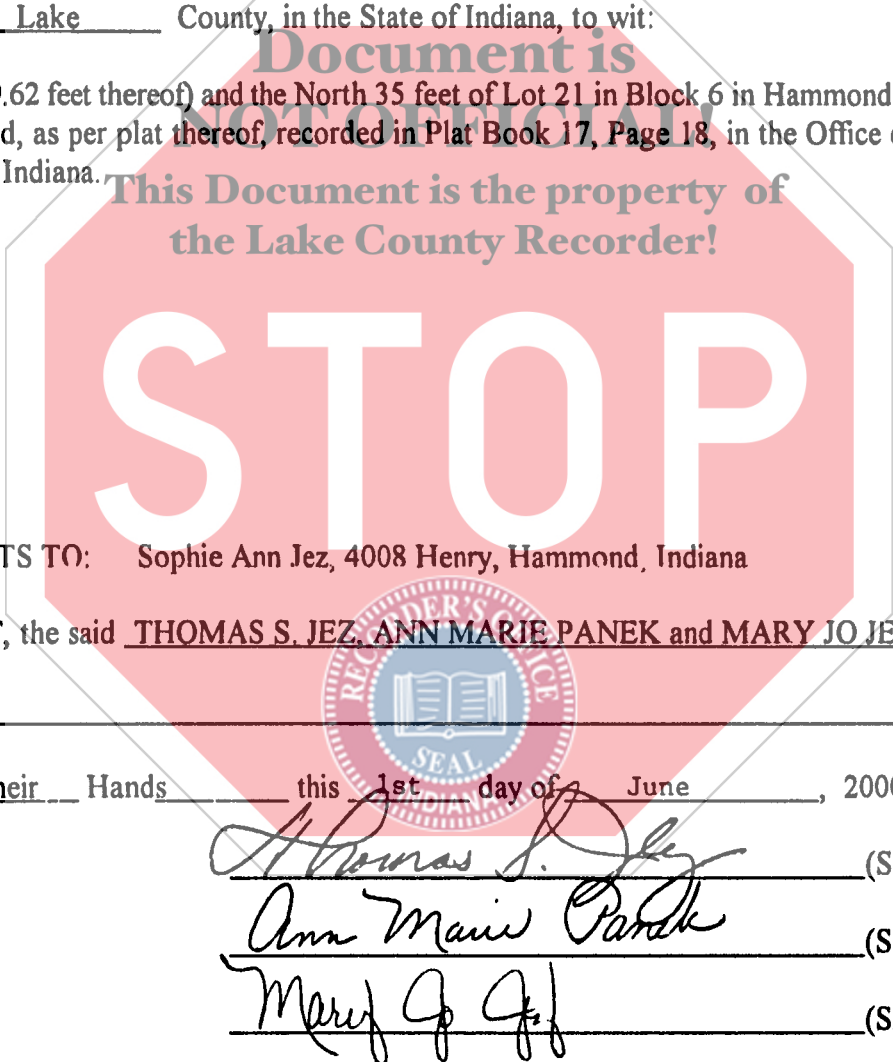

KEY NO. 34-34-21

SEND TAX STATEMENTS TO: Sophie Ann Jez, 4008 Henry, Hammond, Indiana

IN WITNESS WHEREOF, the said THOMAS S. JEZ, ANN MARIE PANEK and MARY JO JEZ

Have hereunto set their Hands this 1st day of June, 2000.

Thomas S. Jez (SEAL)
Ann Marie Panek (SEAL)
Mary Jo Jez (SEAL)

State of Illinois, Cook County, ss:

Before me, the undersigned, a Notary Public in and for said County and State, personally appeared
the within named THOMAS S. JEZ, ANN MARIE PANEK and MARY JO JEZ and
acknowledged the execution of the foregoing Deed to be their voluntary act and deed, in witness whereof,
I have hereunto subscribed my name and affixed my official seal.

My Commission expires: 11/16/03 HELEN S. KROLIKOWSKI Notary Public

Resident of Cook County AUG 22 2000
HELEN S. KROLIKOWSKI
Notary Public, State of Illinois
My Commission Exp 11/16/2003

MAIL TO: PETER BENJAMIN
This instrument prepared by: Attorney Dale A. Anderson, 18225 Burnham Ave., Lansing, IL 60438

15.00
7827 / 7831
1200 / 300
AJ