

STATE OF INDIANA
LAKE COUNTY
FILED FOR RECORD

2000 060725

2000 AUG 22 PM 2:12

MORRIS W. CARTER
RECORDER

A298-10
R298-04

QUITCLAIM DEED

THIS QUITCLAIM DEED, Executed this Aug day of 1, (year), 2000

by first party, Grantor, JANICE DAVIS
whose post office address is 2401 WABASH AVE. GARY, IN 46404

to second party, Grantee, FRANCES J. BUENS WILLIAMS
whose post office address is 16780 ANTHONY HAZEL CREST IL 60429

WITNESSETH, That the said first party, for good consideration and for the sum of _____ Dollars (\$) paid by the said second party, the receipt whereof is hereby acknowledged, does hereby remise, release and quitclaim unto the said second party forever, all the right, title, interest and claim which the said first party has in and to the following described parcel of land, and improvements and appurtenances there-to in the County of LAKE, State of INDIANA to wit:
Property I.D. 25440147-0011 (419 JOHNSON)
LEGAL DESC: LOT 11, BLOCK 14, RESUBDIVISION OF GARY LAND COMPANY'S THIRD SUBDIVISION IN GARY, SHOWN IN PLATBOOK 13, PAGE 8. IN OFFICE OF THE RECORDER OF LAKE COUNTY, INDIANA.

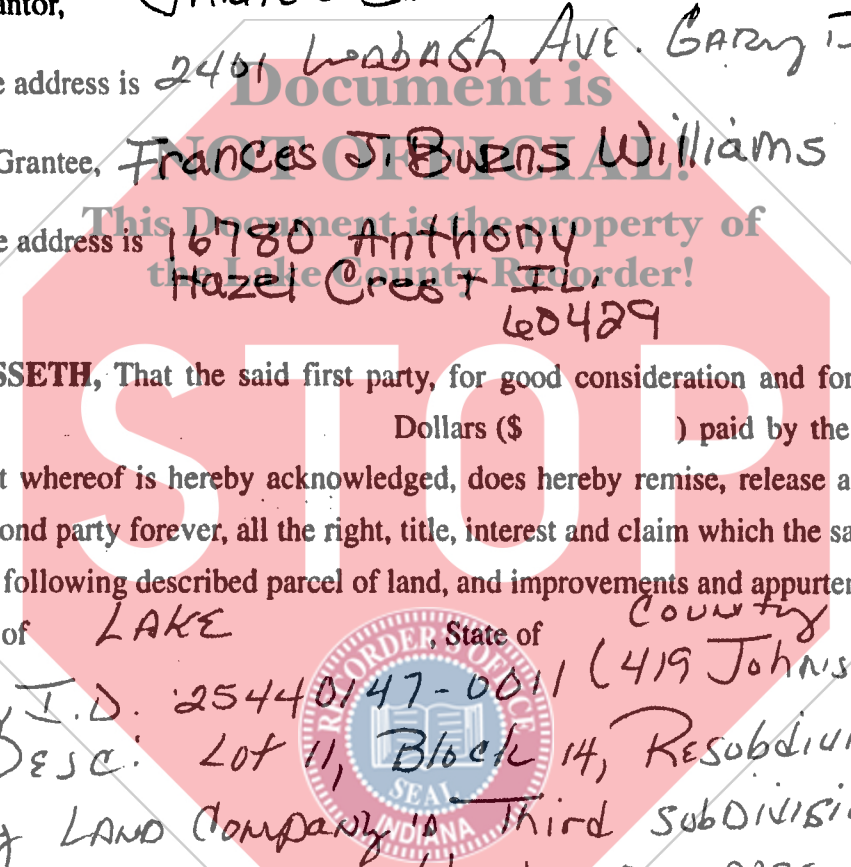

ZAHM (1) DULY ENTERED FOR TAXATION SUBJECT TO FINAL ACCEPTANCE FOR TRANSFER Rev. 4/99

If your state requires 8 1/2" x 11" forms, cut off the bottom of this page at the dotted line.
AUG 22 2000

PETER BENJAMIN
LAKE COUNTY AUDITOR



01516

1600
05

IN WITNESS WHEREOF, The said first party has signed and sealed these presents the day and year first above written. Signed, sealed and delivered in presence of:

Signature of Witness

Print name of Witness

Signature of Witness

Print name of Witness

Signature of First Party

Print name of First Party

Signature of First Party

Print name of First Party

State of ILLINOIS
County of COOK

On _____ before me, DEBORAH A. LEE
appeared JANICE DAVIS
personally known to me (or proved to me on the basis of satisfactory evidence) to be the person(s) whose name(s) is/are subscribed to the within instrument and acknowledged to me that he/she/they executed the same in his/her/their authorized capacity(ies), and that by his/her/their signature(s) on the instrument the person(s), or the entity upon behalf of which the person(s) acted, executed the instrument.
WITNESS my hand and official seal.

Signature of Notary

Affiant _____ Known Produced ID _____
Type of ID DRIVERS LICENSE
(Seal)



State of _____
County of _____
On _____

appeared _____
personally known to me (or proved to me on the basis of satisfactory evidence) to be the person(s) whose name(s) is/are subscribed to the within instrument and acknowledged to me that he/she/they executed the same in his/her/their authorized capacity(ies), and that by his/her/their signature(s) on the instrument the person(s), or the entity upon behalf of which the person(s) acted, executed the instrument.
WITNESS my hand and official seal.

Signature of Notary

Affiant _____ Known _____ Produced ID _____
Type of ID _____
(Seal)



Signature of Preparer

Print Name of Preparer

Address of Preparer

(2)

If your state requires 8 1/2" x 11" forms, cut off the bottom of this page at the dotted line.



Official Stamp

STATE OF INDIANA
LAKE COUNTY
FILED FOR RECORDS

2000 060725

2000 AUG 22 PM 2:14

MORRIS W. CARTER
RECORDER

**Document Mail Back to
Information Sheet**

**This is where you want the recorded document sent back to
when it has completed the recording process.**

Name Frances Joyce Williams

Address 16780 Anthony

City St Zip Hazel Crest Ill. 60429

Telephone (708) 335-0438

Signature Printed Frances Joyce Williams

Signature Written Frances Joyce Williams

Date of Signature 8/22/2000

Check Number _____

Check Amount _____

Office Use Only

Check Equals Amount Due Yes No

Total _____

Initials _____