

STATE OF INDIANA
LAKE COUNTY
FILED FOR RECORD

2000 058450

2000 AUG 15 AM 11:02

MORRIS W. CARTER
WARRANTY DEED

UNIT NO. 27 TAX KEY NO. 17-226-3

THIS INDENTURE WITNESSETH, That JERRY D. SOSBE AND JULIE M. SOSBE, HUSBAND AND WIFE, GRANTOR(S) of LAKE County in the State of INDIANA CONVEYS AND WARRANTS to ROSE A. CANARINI, of LAKE County in the State of INDIANA, as GRANTEE(S) in consideration of One Dollar (\$1.00) and other valuable consideration, the receipt and sufficiency of which are hereby acknowledged, the following described real estate in LAKE County, in the State of Indiana:

LOT 3 IN GLEN WOOD ADDITION TO HOBART, UNIT NO. 1, AS PER PLAT THEREOF, RECORDED SEPTEMBER 8, 1967 IN PLAT BOOK 38 PAGE 44, IN THE OFFICE OF THE RECORDER OF LAKE COUNTY, INDIANA.

COMMONLY KNOWN AS: 1412 MISSISSIPPI PLACE, HOBART, IN 46342

SUBJECT TO SPECIAL ASSESSMENTS, 1999 TAXES PAYABLE 2000, 2000 TAXES PAYABLE 2001 AND ALL REAL ESTATE TAXES DUE AND PAYABLE **HEREAFTER**

SUBJECT TO EASEMENTS RESTRICTIONS AND COVENANTS OF RECORD, IF ANY.

Dated this 1st day of AUGUST, 2000.

Jerry D. Sosbe
JERRY D. SOSBE

Julie M. Sosbe
JULIE M. SOSBE

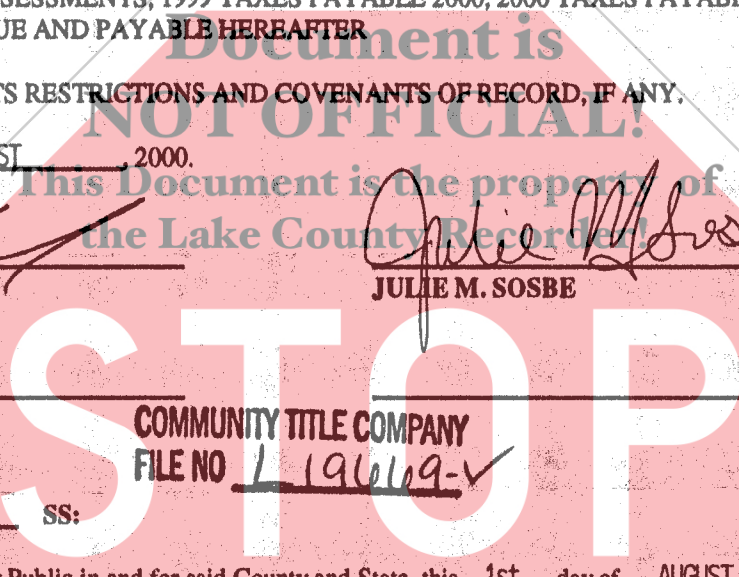

COMMUNITY TITLE COMPANY
FILE NO 19669-v

STATE OF INDIANA
COUNTY OF PORTER SS:

Before me, the undersigned, a Notary Public in and for said County and State, this 1st day of AUGUST, 2000, personally appeared: **JERRY D. SOSBE AND JULIE M. SOSBE, HUSBAND AND WIFE**, and acknowledged the execution of the foregoing deed. In witness whereof, I have hereunto subscribed my name and affixed my official seal.

My commission expires: 01/12/08
Resident of PORTER County

Signature Tracie A. Kraszyk
Printed TRACIE A. KRASZYK, Notary Public



STATE OF _____
COUNTY OF _____ SS:

Before me, the undersigned, a Notary Public in and for said County and State, this _____ day of _____, 2000, personally appeared: _____ and acknowledged the execution of the foregoing deed. In witness whereof, I have hereunto subscribed my name and affixed my official seal.

My commission expires: _____
Resident of _____ County

Signature _____
Printed _____, Notary Public

This instrument prepared by **PATRICK J. McMANAMA**, Attorney at Law, Identification No: 9534-45

Return Deed To: **ROSE A. CANARINI** - 1412 MISSISSIPPI PLACE, HOBART, IN 46342
Send Tax Bills To: **ROSE A. CANARINI** 1412 MISSISSIPPI PLACE, HOBART, IN 46342

DULY ENTERED FOR TAXATION SUBJECT TO
FINAL ACCEPTANCE FOR TRANSFER

AUG 11 2000

PETER BENJAMIN
LAKE COUNTY AUDITOR

14.00
E.P.

00837 CM