

STATE OF INDIANA
LAKE COUNTY
FILED FOR RECORD

2000 057965

2000 AUG 14 AM 10:55

MORRIS W. CARTER
RECORDER

WARRANTY DEED

THIS INDENTURE WITNESSETH, That GERALDINE NICHOLS, GRANTOR(S) OF LAKE County in the State of INDIANA, CONVEYS AND WARRANTS to CYNTHIA D. WATTS, of LAKE County in the State of INDIANA, as GRANTEE(S) in consideration of One Dollar (\$1.00) and other valuable consideration, the receipt and sufficiency of which are hereby acknowledged, the following described real estate in LAKE County, in the State of Indiana:

PARCEL 1: KEY NO. 40-32-72

THAT PART OF THE WEST 1/2 OF SECTION 6, TOWNSHIP 36 NORTH, RANGE 8 WEST OF THE 2ND PRINCIPAL MERIDIAN DESCRIBED AS FOLLOWS: BEGINNING ON THE NORTH LINE OF FIFTH AVENUE 50 FEET NORTH OF THE CENTER LINE THEREOF AT A POINT 1683 FEET EAST OF THE WEST LINE OF SAID SECTION 6 THENCE EAST ON SAID NORTH LINE OF FIFTH AVENUE 143 FEET; THENCE NORTH AND PARALLEL WITH THE WEST LINE OF SAID SECTION, 125 FEET; THENCE WEST AND PARALLEL WITH THE NORTH LINE OF FIFTH AVENUE 143 FEET; THENCE SOUTH AND PARALLEL WITH THE WEST LINE OF SAID SECTION, 125 FEET TO THE PLACE OF BEGINNING, IN THE CITY OF GARY, INDIANA.

SEE LEGAL DESCRIPTION CONTINUED ON REVERSE SIDE HEREOF

COMMONLY KNOWN AS: 4030 & 4060 W. 5TH AVENUE, GARY, IN 46406

SUBJECT TO SPECIAL ASSESSMENTS, ACCRUED BUT NOT YET DUE 1999 TAXES PAYABLE 2000, 2000 TAXES PAYABLE 2001 AND ALL REAL ESTATE TAXES DUE AND PAYABLE HEREAFTER

SUBJECT TO EASEMENTS RESTRICTIONS AND COVENANTS OF RECORD, IF ANY.

Dated this 27 day of July, 2000.

Geraldine Nichols
GERALDINE NICHOLS

COMMUNITY TITLE COMPANY
FILE NO. 419895 ml

STATE OF INDIANA
COUNTY OF _____ SS:

Before me, the undersigned, a Notary Public in and for said County and State, this _____ day of _____, 2000, personally appeared: _____ and acknowledged the execution of the foregoing deed. In witness whereof, I have hereunto subscribed my name and affixed my official seal.

My commission expires: _____ Signature _____
Resident of _____ County Printed _____, Notary Public

STATE OF Tenn
COUNTY OF Shelby SS:

Before me, the undergned, a Notary Public in and for said County and State, this 27 day of July, 2000, personally appeared: Geraldine Nichols and acknowledged the execution of the foregoing deed. In witness whereof, I have hereunto subscribed my name and affixed my official seal.

MY COMMISSION EXPIRES FEB. 13, 2001
My commission expires: _____ Signature *Adrienne Williams*
Resident of Shelby County Printed ADRIENNE WILLIAMS, Notary Public

This instrument prepared by PATRICK J. McMANAMA, Attorney at Law, Identification No: 9534-45

Return Deed To: CYNTHIA D. WATTS 220 W. 5th Ave., Gary, In 46402
Send Deed to: CYNTHIA D. WATTS 220 W. 5th Ave Gary, In 46402

DULY ENTERED FOR TAXATION SUBMITTAL
FINAL ACCEPTANCE FOR TRANSFER 00338

AUG 3 2000

PETER BENJAMIN
LAKE COUNTY AUDITOR

CM
16.00
AC

NICHOLS/WATTS

PARCEL 2: KEY NO. 40-32-53

THAT PART OF THE WEST ¼ OF SECTION 6, TOWNSHIP 36 NORTH, RANGE 8 WEST OF THE 2ND PRINCIPAL MERIDIAN, DESCRIBED AS FOLLOWS; BEGINNING ON THE NORTH LINE OF FIFTH AVENUE 50 FEET NORTH OF THE CENTER LINE THEREOF AT A POINT 1683 FEET EAST OF THE WEST LINE OF SAID SECTION 6; THENCE EAST ON SAID NORTH LINE OF FIFTH AVENUE 285.96 FEET, MORE OR LESS, TO A POINT 325 FEET WEST OF THE EAST LINE OF THE WEST ¼ OF SECTION; THENCE NORTH PARALLEL TO THE EAST LINE OF THE WEST ¼ OF SECTION, 125 FEET; THENCE WEST PARALLEL TO THE NORTH LINE OF FIFTH AVENUE A DISTANCE OF 284.52 FEET, MORE OR LESS, TO A POINT 1683 FEET EAST OF THE WEST LINE OF SECTION; THENCE SOUTH PARALLEL TO THE WEST LINE OF SAID SECTION, 125 FEET TO THE POINT OF BEGINNING EXCEPT THAT PART THEREOF DESCRIBED AS FOLLOWS; BEGINNING ON THE NORTH LINE OF FIFTH AVENUE 50 FEET NORTH OF THE CENTER LINE THEREOF AT A POINT 1683 FEET EAST OF THE WEST LINE OF SAID SECTION 6; THENCE EAST ON SAID NORTH LINE OF FIFTH AVENUE 143 FEET; THENCE NORTH AND PARALLEL WITH THE NORTH LINE OF FIFTH AVENUE, 143 FEET; THENCE SOUTH AND PARALLEL WITH THE WEST LINE OF SAID SECTION, 125 FEET TO THE PLACE OF BEGINNING, ALL IN THE CITY OF GARY, LAKE COUNTY, INDIANA.

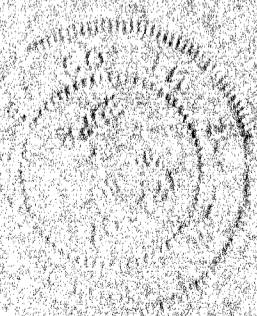
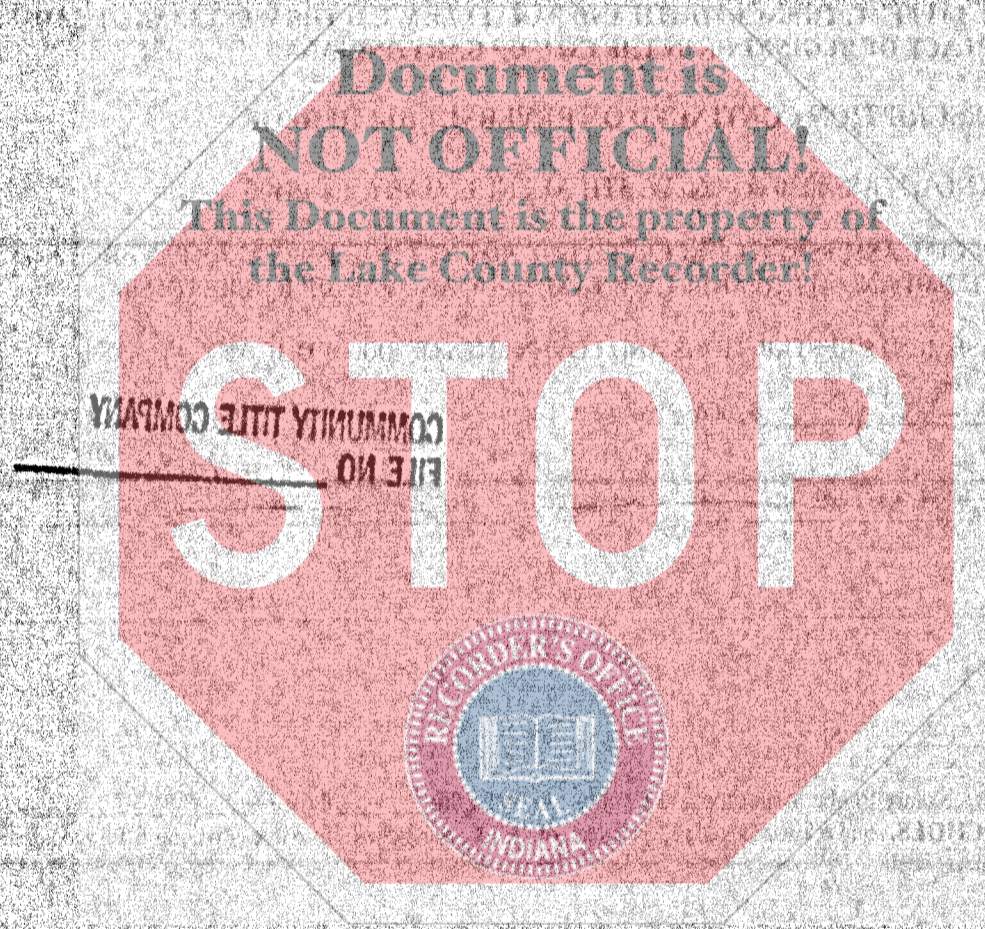

COMMUNITY TITLE COMPANY
FILE NO.