

4

**SWORN STATEMENT OF INTENTION TO HOLD LIEN
(NOTICE OF MECHANIC'S LIEN)**

TO: Harrington Properties Inc.
Medical Wast Solutions, Inc.
1300 Michigan Street.
Gary IN 46402-3034

STATE OF INDIANA, COUNTY OF LAKE COUNTY, SS:

The undersigned, being first duly sworn, makes this sworn statement of intention to hold a lien upon the property described below and says that:

1. The undersigned, Robert Balash Trucking, intends to hold a lien on land commonly known as 1300 Michigan Street Gary, Indiana 46402, and legally described as follows:

See attached Exhibit A

as well as on all buildings, other structures and improvements located thereon or connected therewith for work and labor done and for materials and machinery furnished by the undersigned in the erection, construction, altering, repairing and removing of said buildings, structures and improvements for such work and labor and for such materials and machinery.

2. The amount claimed under this statement is One Thousand sixty five and 00/100 dollars (\$1065.00).

3. The work and labor were done and the materials and machinery were furnished by the undersigned within the last sixty days.

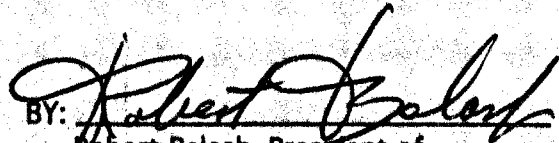
BY: 
Robert Balash, President of
Robert Baslash Trucking.

STATE OF INDIANA)
COUNTY OF LAKE) SS:

Before me, a Notary Public in and for said County and State, personally appeared Robert

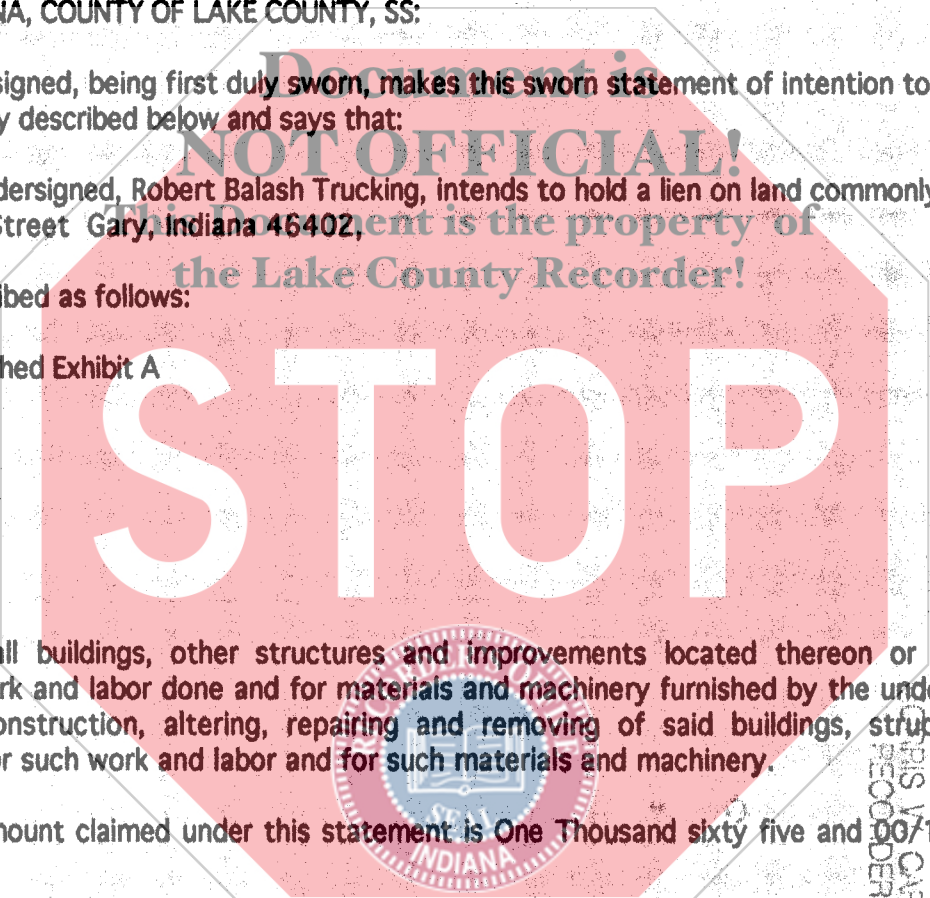

0000 057733

STATE OF INDIANA
LAKE COUNTY
RECORDERS OFFICE
2006 JUN 11 PM 1:18
CHRIS V. CARTER
RECORDER

0025
171

Balash, President of Robert Balash Trucking, who acknowledged the execution of the foregoing Sworn Statement and Notice of Intention to Hold Mechanic's Lien, and who, having been duly sworn, under the penalties of perjury, stated that the facts and matters therein set forth are true and correct.

Witness my hand and Notarial Seal this 11 day of ~~February~~ ^{August}, 2000.

My Commission Expires: November 21, 2007
Resident of Lake County, Indiana

Beverly L. Neff, Notary Public

Document is NOT OFFICIAL
This Document is the property of
the Lake County Recorder!

I hereby certify that I have this 11th day of August, 2000, mailed a duplicate of this notice, first-class, postage prepaid, to the within named property owner at Harrington Properties, Inc., C/O JWP Zack Inc., 1300 Michigan St. Gary, IN 46402 (As shown on the tax records)
Samuel Orlich, Recorder of Lake County

This instrument prepared by D. Eric Neff, Attorney at Law
270 North Main Street, Suite A Crown Point, Indiana 46307

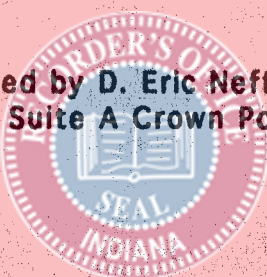

EXHIBIT A

LEGAL DESCRIPTION

PARCEL 1. A parcel of land in the Northwest Quarter of Section 11, Township 36 North, Range 8 West of the 2nd Principal Meridian, in the City of Gary, Lake County, Indiana, more particularly described as follows: Commencing at the Southwest corner of said Northwest Quarter; thence North 30.01 feet along the West line of said Section 11 to the North right-of-way line of 15th Avenue; thence East, 1,510.99 feet along said North right-of-way line to the East right-of-way line of Michigan Street; thence North at a deflection angle to the left of 91 degrees 40 minutes 15 seconds, a distance of 809.00 feet along the East right-of-way line of said Michigan Street being parallel with the West line of said Section 11, to the point of beginning; thence continuing North along said East right-of-way line 979.22 feet to the South boundary of a parcel of land deeded to Babcock Brothers, Inc., and recorded under Deed Book No. 691133 on November 19, 1961; thence East 409.94 feet along said South boundary line to the West right-of-way line of Texas Street extended North; thence South 904.98 feet along said West right-of-way line of Texas Street North being parallel with the West line of said Section 11 to a line that is parallel with and 605.00 feet North of the North right-of-way line of 15th Avenue, as measured along said right-of-way line of Texas Street; thence West 100 feet along said line being parallel with the North right-of-way line of 15th Avenue to the place of beginning.

PARCEL 2. Part of the Northwest Quarter of Section 11, Township 36 North, Range 8 West of the 2nd Principal Meridian, more particularly described as follows: Commencing at a point on the West line of said Section 11 and 1390.30 feet South of the Northwest corner thereof; thence East parallel to the North line of said Section 11, a distance of 1090.13 feet to the point of beginning of this described parcel; thence East parallel to the North line of said Section 11 a distance of 100 feet to the West line of Michigan Street; thence South parallel to the West line of said Section 11 and along the West line of Michigan Street a distance of 342 feet; thence West parallel to the North line of said Section 11 a distance of 140 feet; thence North parallel to the West line of Section 11, a distance of 742 feet to the point of beginning; in Lake County, Indiana.

PARCEL 3. A parcel of land in the Northwest Quarter of Section 11, Township 36 North, Range 8 West of the Second Principal Meridian, in the City of Gary, Lake County, Indiana, more particularly described as follows: Commencing at the Southwest corner of said Quarter Section; thence North 30.01 feet along the West line of said Section 11 to the North Right-of-way line of 15th Avenue; thence East 1000.97 feet along said North Right-of-way line to the West Right-of-way line of Michigan Street; thence North 400.0 feet along the West Right-of-way line of Michigan Street being parallel with the West line of said Section 11, to the Point of Beginning; thence continuing North 642.00 feet along this West Right-of-way line of said Michigan Street; thence West at a deflection angle to the left of 89 degrees 07 minutes 15 seconds a distance of 300.0 feet

