

2

1028

STATE OF UTAH  
LAKE COUNTY  
FILED FOR RECORD

MORTGAGE / DEED OF TRUST ASSIGNMENT

2000 056767

2000 AUG -9 PM 10:11

6905867070

For value received, Conseco Bank, Inc. , a corporation organized and existing under the laws of the State of Utah, hereby assigns to Conseco Finance Servicing Corp., its successors and assigns, all right, title, and interest in and to a certain Mortgage / Deed of Trust dated December 16, 1999, made by Delpha Roberts an adult, as mortgagor(s), to Conseco Bank, Inc., as mortgagee, as filed in the offices of the County Recorder, county of Lake, State of Indiana, together with the Note secured by such mortgage / deed of trust on the following described property situated in the above county and state, to wit:

Document is NOT OFFICIAL!

See attached exhibit A for legal description.

Date this day of March 27, 2000.

This Document is the property of the Lake County Recorder!

Conseco Bank, Inc.

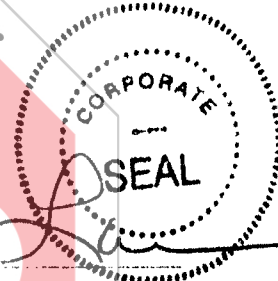

Mtg. Rec. Bk. Pg.

Instrument # 20000-000935

By

*Julie Larson*  
Julie Larson, Authorized Agent

State of Arizona

) ss

County of Maricopa

As a Notary Public for the State of Arizona, I hereby certify that Julie Larson personally came before me on this date and acknowledged that he/she is an Authorized Agent of Conseco Bank, Inc. , a Utah corporation, and that by authority duly given and as the act of the corporation, the foregoing instrument was signed in its name by him/her.

Witness my hand and official seal dated this day March 27, 2000.

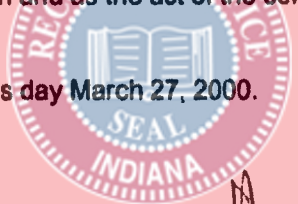

*Mark Cruz Puente*  
Notary Public

(Notary Seal)

Notary Public

My Commission Expires:

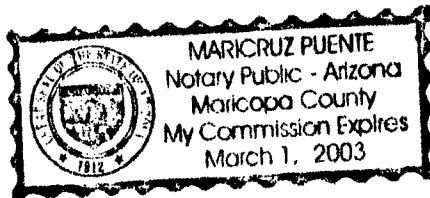

[WHEN RECORDED RETURN TO]  
NTC ATTN: DARRELL COLON  
101 N. BRAND BLVD., SUITE #1800  
GLENDALE, CALIFORNIA 91203  
GREENTREE LOAN: 6905867070



418223

13.00  
m

617518 AM

**EXHIBIT A**

**Legal Description:**

LOT 28 AND THE NORTH 1/2 OF LOT 27, BLOCK 13, IN IRONWOOD UNIT "A", IN THE CITY OF GARY, LAKE COUNTY, INDIANA.

Parcel ID: 25-45-0094-0029

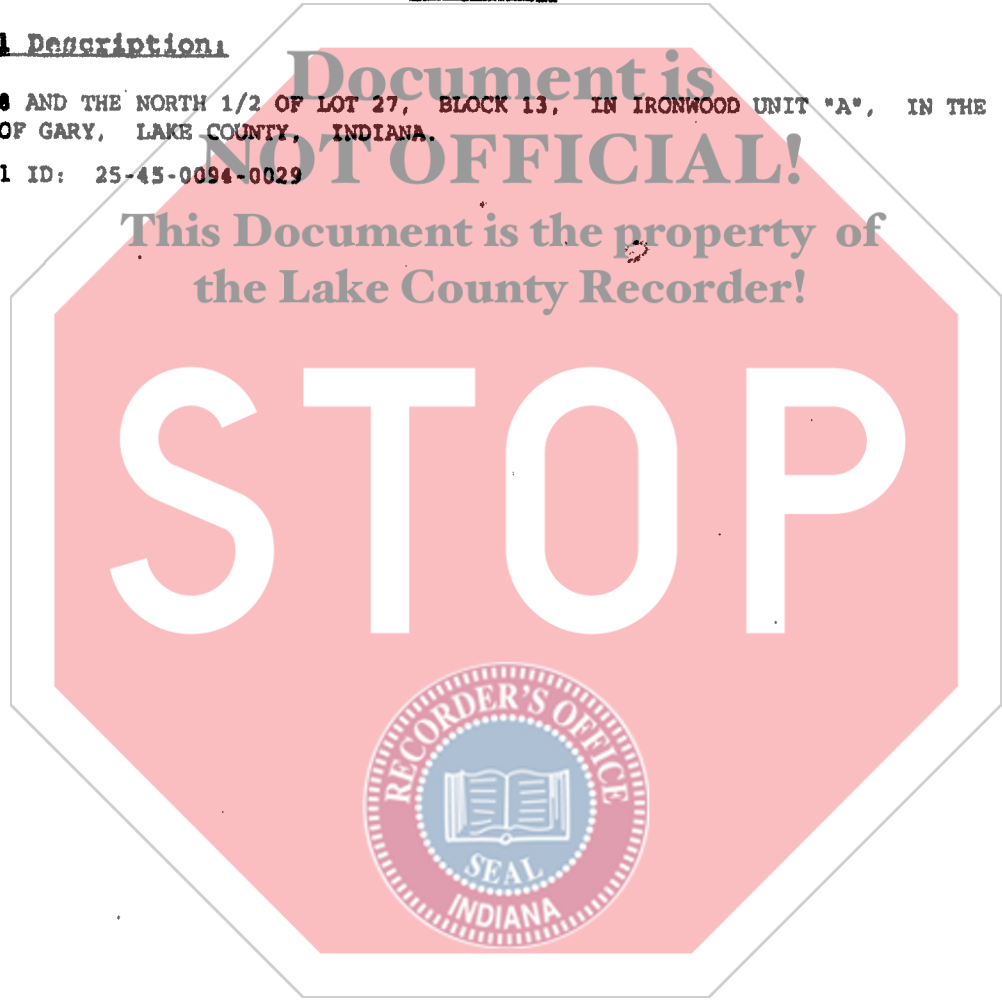

Document is  
**NOT OFFICIAL!**