

5 R/W No.: 02-02-048

CORRECTION OF LEGAL DESCRIPTION

Prepared by:
Paul Norgren
Vector Pipeline L.P.
21 West Superior Street
Duluth, Minnesota 55802-2067

Return to:
Vector Pipeline L.P.
3033 W. Jefferson St., Suite 204
Joliet, IL 60435

2000 055631

STATE OF ILLINOIS
LAKE COUNTY
FILED
2000 AUG -7 11
MORRIS COUNTY RECORDER

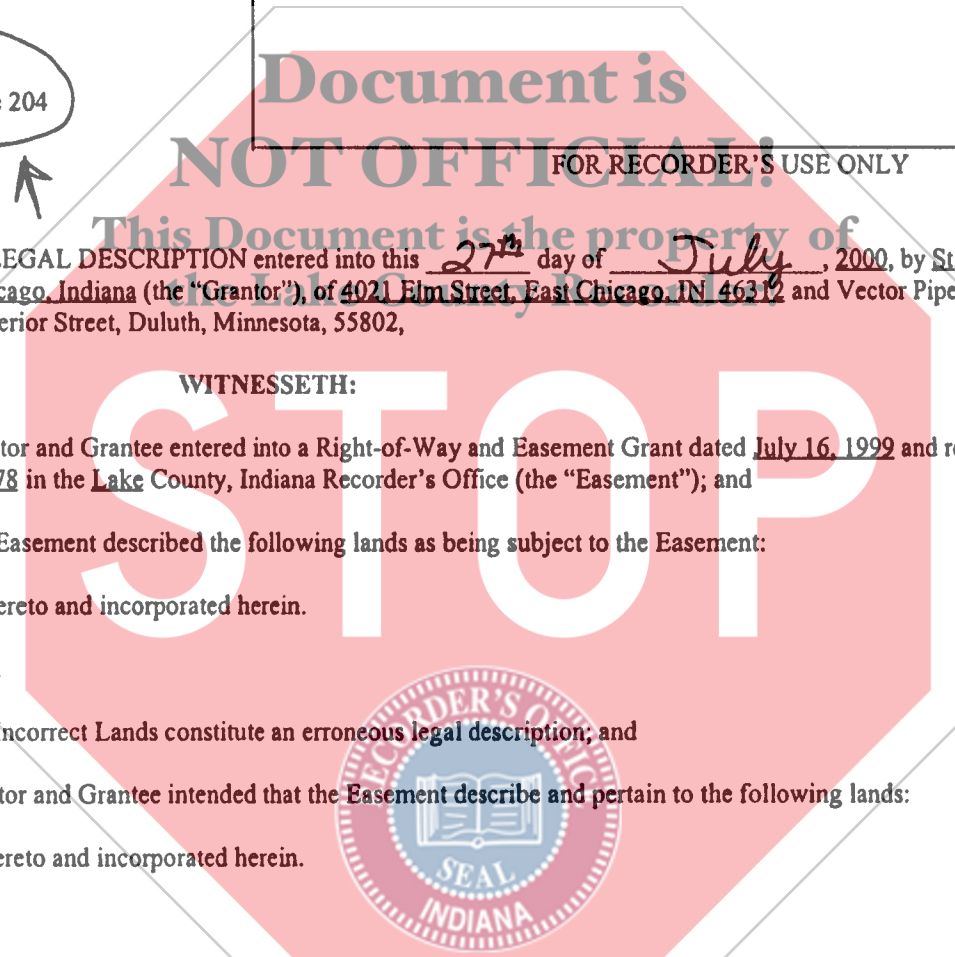

THIS CORRECTION OF LEGAL DESCRIPTION entered into this 27th day of July, 2000, by St. George Serbian Church of East Chicago, Indiana (the "Grantor"), of 4021 Elm Street, East Chicago, IN 46312 and Vector Pipeline, L.P. (the "Grantee"), of 21 West Superior Street, Duluth, Minnesota, 55802,

WITNESSETH:

WHEREAS, Grantor and Grantee entered into a Right-of-Way and Easement Grant dated July 16, 1999 and recorded as Document Number 99064178 in the Lake County, Indiana Recorder's Office (the "Easement"); and

WHEREAS, The Easement described the following lands as being subject to the Easement:

See "Exhibit A", attached hereto and incorporated herein.
(the "Incorrect Lands"); and

WHEREAS, The Incorrect Lands constitute an erroneous legal description; and

WHEREAS, Grantor and Grantee intended that the Easement describe and pertain to the following lands:

See "Exhibit B", attached hereto and incorporated herein.
(the "Correct Lands");

NOW, THEREFORE, for ONE DOLLAR and other good and valuable consideration, the receipt and sufficiency of which are hereby acknowledged, Grantor and Grantee agree that the legal description (of the Incorrect Lands) set forth in the Easement is hereby amended to include those lands, and only those lands, which constitute the Correct Lands. Grantor and Grantee ratify and adopt the Easement as amended and as it pertains to the Correct Lands only and Grantor hereby grants unto Grantee, its successors and assigns, all of its right, title, and interest in the Correct Lands upon the conditions and provisions, and for the term, set forth in the Easement.

IN WITNESS WHEREOF, this instrument has been executed as of this 27th day of July, 2000.

(5 pages)
Cr. #2601001367
17.00
E.P.
2601001367

GRANTOR:

ST. GEORGE SERBIAN ORTHODOX CHURCH
OF EAST CHICAGO, INDIANA

BY: Vukasin Tomic

TITLE: PRESIDENT

BY: John Ostoich

TITLE: TREASURER

GRANTEE:

VECTOR PIPELINE L.P.
BY VECTOR PIPELINE, INC. AS GENERAL PARTNER

BY: Julie Rasmussen

NAME: Julie Rasmussen

TITLE: Authorized Agent

CORPORATE SEAL

Document is NOT OFFICIAL!
CORPORATE ACKNOWLEDGEMENT

STATE OF INDIANA)
COUNTY OF PORTER)

This Document is the property of the Lake County Recorder!

On this the 27 day of July, 2000, personally appeared Vukasin Tomic and John Ostoich as President and Treasurer of St. George Serbian Orthodox Church of East Chicago, Indiana, signer and sealer of the foregoing instrument, and acknowledged the same to be his/her free act and deed as such officer and the free act and deed of said corporation, before me.

Janice N. Williams

JANICE N. WILLIAMS
Notary Public
My Commission Expires: 06/01/2001
Resident of Porter County, IN

4

CORPORATE ACKNOWLEDGEMENT

STATE OF Illinois)
COUNTY OF Will)

On this the 1st day of August, 2000, personally appeared before me, Julie Rasmussen acting in ~~his~~ her capacity as Authorized Agent of Vector Pipeline, Inc., as General Partner of Vector Pipeline, L.P., a Delaware limited partnership, signer of the foregoing instrument, and acknowledged the same to be ~~his~~ her free act and deed as Authorized Agent of such General Partner and the free act and deed of said partnership.

Marcie L. Foster

Notary Public
My Commission Expires:

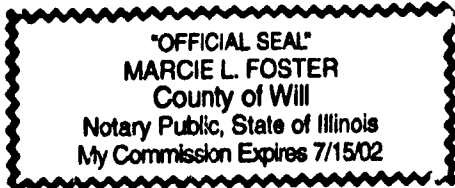

EXHIBIT A

VECTOR PIPELINE

TRACT NO. 02-02-048

TAX I.D. NO. _____

COUNTY LAKE

STATE INDIANA

PERMANENT EASEMENT AND RIGHT OF WAY

A 50 FEET WIDE PERMANENT EASEMENT AND RIGHT OF WAY, LOCATED ACROSS A PORTION OF THE WEST HALF OF THE EAST HALF (W/2 E/2) OF SECTION 35, TOWNSHIP 35N, RANGE 9W OF THE SECOND PRINCIPAL MERIDIAN, OF LAKE COUNTY, INDIANA, AND BEING UPON, OVER, THROUGH, ACROSS A PORTION OF THAT CERTAIN TRACT OF LAND CONVEYED TO ST. GEORGE SERBIAN ORTHODOX CHURCH OF EAST CHICAGO, INDIANA, AS DESCRIBED BY INSTRUMENTS RECORDED AS DOCUMENT 96022753, AS DOCUMENT 96022755, AND AS DOCUMENT 96022757, OF THE OFFICE OF REGISTER OF DEEDS OF LAKE COUNTY, INDIANA, SAID PROPOSED PIPELINE BEING LOCATED 70 FEET SOUTHERLY OF THE CENTERLINE OF ANR PIPELINE COMPANY'S EXISTING 42 INCH PIPELINE SAID 50 FEET WIDE PERMANENT EASEMENT AND RIGHT OF WAY BEING SITUATED GENERALLY 35 FEET NORTHERLY OF AND 15 FEET SOUTHERLY OF THE CENTERLINE OF THE SAID PROPOSED PIPELINE.

CONTAINING _____ ACRES MORE OR LESS.

TEMPORARY WORKSPACE

BEING A 50 FEET WIDE STRIP OF LAND, PARALLEL WITH AND ADJACENT TO THE SOUTHERLY SIDE OF THE ABOVE DESCRIBED 50 FEET WIDE PERMANENT EASEMENT AND RIGHT OF WAY AND A 10 FEET WIDE STRIP OF LAND, PARALLEL WITH AND ADJACENT TO THE NORTHERLY SIDE OF THE ABOVE DESCRIBED 50 FEET WIDE PERMANENT EASEMENT AND RIGHT OF WAY, EXTENDING OR SHORTENING THE SIDE LINES OF THE TEMPORARY EASEMENTS, AT THE BEGINNING AND TERMINATION OF SAID PERMANENT EASEMENT LINES, TO INTERSECT WITH THE ABOVE REFERENCED PROPERTY LINES.

CONTAINING _____ ACRES MORE OR LESS.

EXHIBIT B

VECTOR PIPELINE
UEI JOB NO. 3179
TRACT NO. 02-02-048
LAKE COUNTY, INDIANA

**DESCRIPTION OF A FIFTY (50) FEET WIDE
PERMANENT EASEMENT AND RIGHT OF WAY**

DESCRIPTION OF A FIFTY (50) FEET WIDE PERMANENT EASEMENT AND RIGHT OF WAY, LOCATED IN SECTION 35, TOWNSHIP 35 NORTH, RANGE 9 WEST, LAKE COUNTY, INDIANA AND BEING UPON, OVER, THROUGH AND ACROSS A PORTION OF THAT CERTAIN TRACT OF LAND CONVEYED TO ST. GEORGE SERBIAN ORTHODOX CHURCH OF EAST CHICAGO, INDIANA, AS DESCRIBED BY INSTRUMENT RECORDED UNDER DOCUMENT NO. 96022753 OF THE OFFICE OF THE RECORDER OF DEEDS OF LAKE COUNTY, INDIANA, (REFERRED HEREINAFTER TO AS THE "ABOVE REFERENCED TRACT OF LAND"), SAID FIFTY (50) FEET WIDE PERMANENT EASEMENT AND RIGHT OF WAY BEING SITUATED 35 FEET NORTHWESTERLY OF AND 15 FEET SOUTHEASTERLY OF, THE HEREIN DESCRIBED BASELINE, SAID BASELINE BEING MORE PARTICULARLY DESCRIBED AS FOLLOWS:

COMMENCING at a 3/8-inch iron rod found marking the southwest corner of the said section 35;

THENCE South $89^{\circ} 19' 52''$ East, along the south line of the said section 35, a distance of 2659.66 feet to a railroad spike found;

THENCE North $00^{\circ} 20' 57''$ West, a distance of 1832.54 feet to a point in the west line of the above referenced tract of land, 105 feet southeasterly of, at right angles to, the southern most of two (2) existing ANR Pipeline Company pipelines and the **POINT OF BEGINNING** of the herein described baseline;

THENCE North $72^{\circ} 08' 09''$ East, along a line 105 feet southeasterly of and parallel with the said existing pipeline, a distance of 1209.85 feet to a point in the easterly line of the above referenced tract of land and the **POINT OF TERMINATION** of the herein described baseline, from which the southeast corner of the above referenced tract of land bears, South $07^{\circ} 11' 15''$ East, a distance of 831.91 feet, said baseline having a length of 1209.85 feet or 73.32 rods and the said Permanent Easement and Right of Way containing 1.39 acres, more or less.

TEMPORARY WORK SPACE

Being a fifty (50) feet wide strip of land, adjoined to and parallel with the southeasterly side of the above described Permanent Easement and Right of Way and a ten (10) feet wide strip of land, adjoined to and parallel with the northwesterly side of the said Permanent Easement and right of way, extending or shortening, the side lines of the Temporary Work Spaces, at the beginning and termination of the said Permanent Easement and Right of Way lines, to intersect with the property lines of the above referenced tract of land and containing a total of 1.67 acres, more or less.

ADDITIONAL TEMPORARY WORK SPACE

Being a fifty (50) feet wide strip of land, adjoined to and parallel with the southeasterly side of the above described fifty (50) feet wide Temporary Work Space, extending 125 feet in a northeasterly direction, from the west line of the above referenced tract of land and containing a total of 0.20 acre, more or less.

06/03/2000
S:\3179\SURVEY\DESC\INDIANA\IN6634.WPD

