

STATE OF INDIANA  
LAKE COUNTY  
FILED FOR RECORD

2000 055440

2000 AUG -4 AM 10:10

THIS FORM HAS BEEN PREPARED FOR USE IN THE STATE OF INDIANA BY LAWYERS ONLY. SELECTING A FORM OF INSTRUMENT, FILLING IN BLANK SPACES, STRIKING OUT PROVISIONS AND INSERTING SPECIAL CLAUSES MAY CONSTITUTE THE PRACTICE OF LAW, WHICH SHOULD BE PERFORMED ONLY BY A LAWYER.

MAIL TAX BILLS TO:

### QUITCLAIM DEED

THIS INDENTURE WITNESSETH, that H.E.I. Corp. & Thompson, Rodney

GRANTOR(S) of Cook County in the State of IL

QUITCLAIM(S) to NETCO, Inc.

GRANTEE(S) of Cook County in the State of IL

in consideration of One Dollar (\$1.00) and other valuable consideration, the receipt and sufficiency of which are hereby acknowledged, the following described real estate in Lake County, in the State of Indiana:

Property ID # 25-46-0541-0019  
Legal Desc.: ALL LOT 19, BLOCK 7, CORRECTED PLANT OF MARSHALLTOWN, IN THE CITY OF GARY, AS SHOWN IN PLANT BOOK 29, PAGE 95, IN THE OFFICE OF THE RECORDER OF LAKE COUNTY, INDIANA.  
Common Address: 2208 E. 20th Avenue, Gary, IN 46407

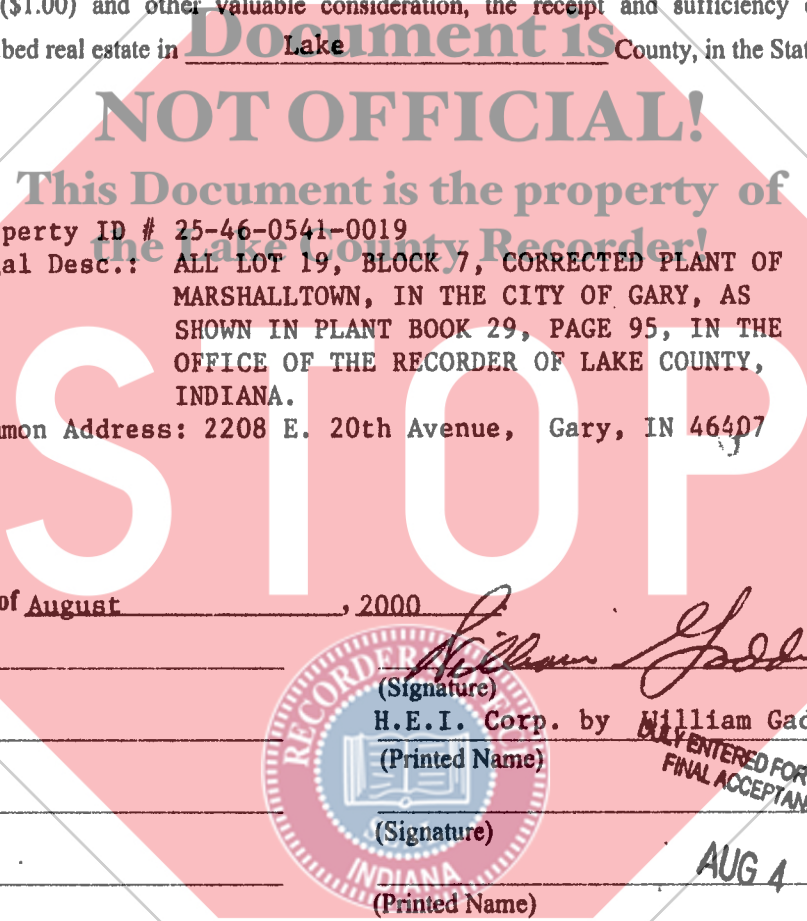

IN 18413

Dated this 1<sup>st</sup> day of August, 2000

Thompson, Rodney (Signature)  
Thompson, Rodney (Printed Name)

William Gaddis (Signature)  
H.E.I. Corp. by William Gaddis, President (Printed Name)

(Signature)

(Printed Name)

STATE OF INDIANA, COUNTY OF Lake SS: PETER BENJAMIN LAKE COUNTY AUDITOR

Before me, the undersigned, a Notary Public in and for said County and State, this 1 day of August, personally appeared: Thompson, Rodney & William Gaddis, President of H.E.I. Corp.

and acknowledged the execution of the foregoing deed. In witness whereof, I have hereunto subscribed my name and affixed my official seal.

My commission expires: \_\_\_\_\_ Signature Robert L. Lewis

Resident of \_\_\_\_\_ County Printed \_\_\_\_\_ Notary Public

This instrument prepared by Robert L. Lewis, Attorney at Law

Attorney No. 10070-45

MAIL TO:

**Robert L. Lewis**  
Notary Public State of Indiana  
Lake County  
My Commission Expires 08/28/06



00423 14-  
m  
#495/  
HOLN  
NETCO