

2

STATE OF INDIANA
LAKE COUNTY
FILED FOR RECORD

2000 054801

2000 AUG -2 PM 3:29

MORRIS W. CARTER
RECORDER

A298-10
R298-04

QUITCLAIM DEED

THIS QUITCLAIM DEED, Executed this 31st day of July, 2000 (year),

by first party, Grantor, Lyles & Son Excavating, Inc.

whose post office address is 1843 West 15th Avenue, Gary, Indiana

to second party, Grantee, Clean Earth, Inc.

whose post office address is 2927 Chase Street and 2921 Chase Street,
Gary, Indiana

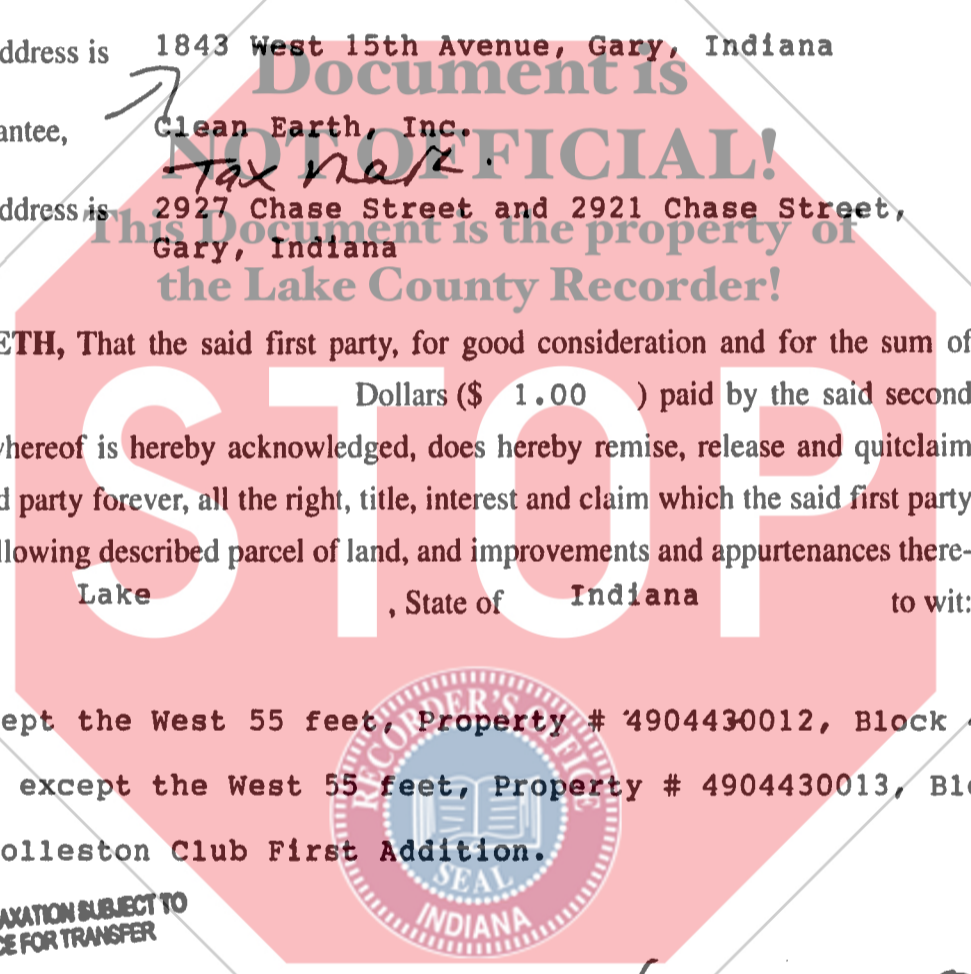

WITNESSETH, That the said first party, for good consideration and for the sum of

Dollars (\$ 1.00) paid by the said second

party, the receipt whereof is hereby acknowledged, does hereby remise, release and quitclaim unto the said second party forever, all the right, title, interest and claim which the said first party has in and to the following described parcel of land, and improvements and appurtenances there- to in the County of Lake, State of Indiana to wit:

Lot 12, except the West 55 feet, Property # 4904430012, Block 41,
and Lot 13, except the West 55 feet, Property # 4904430013, Block
Block 41, Tolleston Club First Addition.

DULY ENTERED FOR TAXATION SUBJECT TO
FINAL ACCEPTANCE FOR TRANSFER

AUG 2 2000

PETER BENJAMIN
LAKE COUNTY AUDITOR

Key # 49-443-12
49-443-13
00217

ABAA (1)

Rev. 4/99

If your state requires 8 1/2" x 11" forms, cut off the bottom of this page at the dotted line.

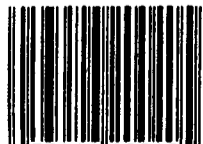

0 53926 20040 5

16.00
E.P.
CS

25x10

IN WITNESS WHEREOF, The said first party has signed and sealed these presents the day and year first above written. Signed, sealed and delivered in presence of:

Signature of Witness

Signature of First Party

Print name of Witness

Print name of First Party

Signature of Witness

Signature of First Party

Print name of Witness

Print name of First Party

State of Indiana

County of Lake

On before me,
appeared Otto Lyles

personally known to me (or proved to me on the basis of satisfactory evidence) to be the person(s) whose name(s) is/are subscribed to the within instrument and acknowledged to me that he/she/they executed the same in his/her/their authorized capacity(ies), and that by his/her/their signature(s) on the instrument the person(s), or the entity upon behalf of which the person(s) acted, executed the instrument.

WITNESS my hand and official seal.

Signature of Notary

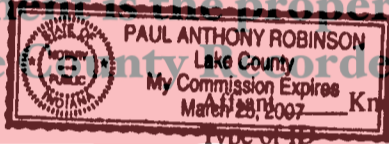

Produced ID

(Seal)

State of
County of

On before me,
appeared

personally known to me (or proved to me on the basis of satisfactory evidence) to be the person(s) whose name(s) is/are subscribed to the within instrument and acknowledged to me that he/she/they executed the same in his/her/their authorized capacity(ies), and that by his/her/their signature(s) on the instrument the person(s), or the entity upon behalf of which the person(s) acted, executed the instrument.

WITNESS my hand and official seal.

Signature of Notary



Affiant Known Produced ID

Type of ID

(Seal)

Signature of Preparer

Print Name of Preparer

Address of Preparer

(2)

If your state requires 8 1/2" x 11" forms, cut off the bottom of this page at the dotted line.