

STATE OF INDIANA
LAKE COUNTY
FILED FOR RECORD

2000 051510

2000 JUL 21 AM 9:51

MORRIS W. CARTER
RECORDER

2

A298-10
R298-04

QUITCLAIM DEED

THIS QUITCLAIM DEED, Executed this 19th day of JUNE 2000 (year),

by first party, Grantor, LORI M. THORN

whose post office address is

to second party, Grantee, TIMOTHY J. THORN

whose post office address is 3641 W 7th pl.
Merrillville IN 46410

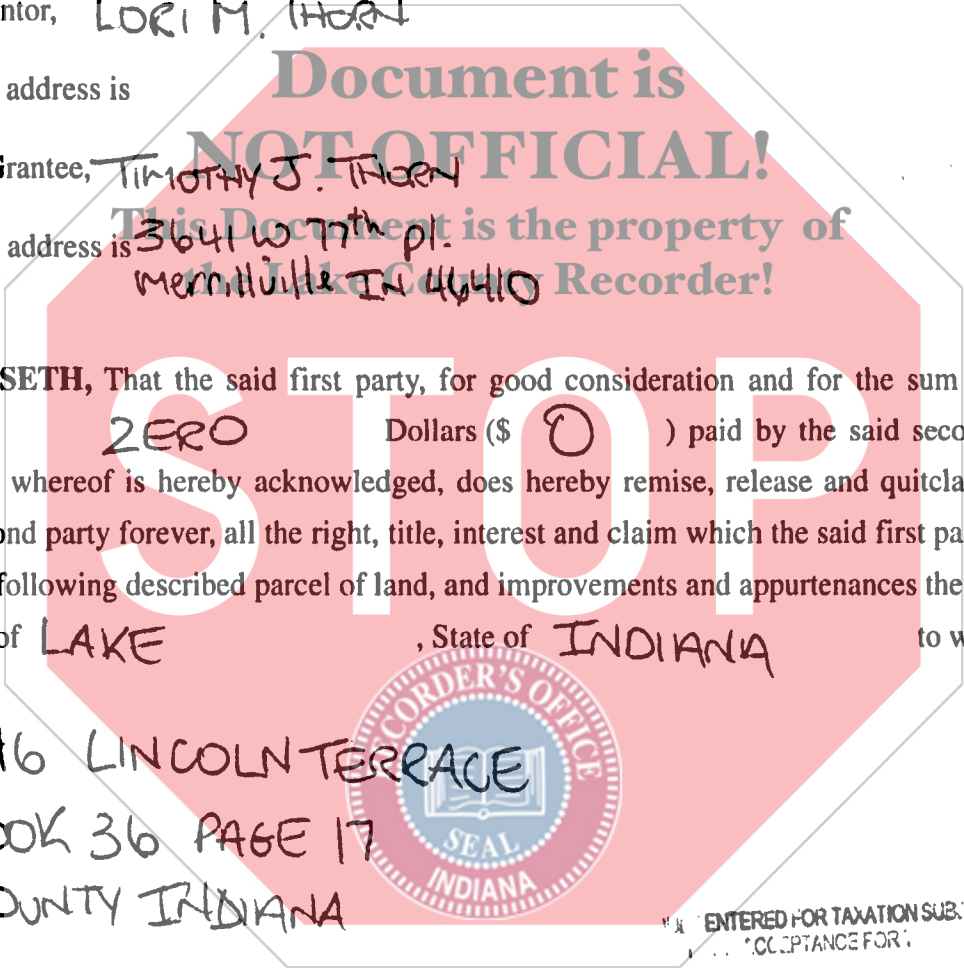

WITNESSETH, That the said first party, for good consideration and for the sum of ZERO Dollars (\$ 0) paid by the said second party, the receipt whereof is hereby acknowledged, does hereby remise, release and quitclaim unto the said second party forever, all the right, title, interest and claim which the said first party has in and to the following described parcel of land, and improvements and appurtenances there- to in the County of LAKE, State of INDIANA to wit:

LOT #46 LINCOLN TERRACE
PLAT BOOK 36 PAGE 17
LAKE COUNTY INDIANA



ENTERED FOR TAXATION SUBJECT TO ACCEPTANCE FOR

JUL 21 2000

RECORDS & CLERK
LAKE COUNTY INDIANA

AQAA (1)

Rev. 4/99

If your state requires 8 1/2" x 11" forms, cut off the bottom of this page at the dotted line.



1207

16.00
Ac

C.S.

25 x 10

IN WITNESS WHEREOF, The said first party has signed and sealed these presents the day and year first above written. Signed, sealed and delivered in presence of:

Krista A. Shupey
Signature of Witness
KRISTA A. Shupey
Print name of Witness

Lori M Thorn
Signature of First Party
LORI M THORN
Print name of First Party

Signature of Witness

Signature of First Party

Print name of Witness

Print name of First Party

State of KENTUCKY)
County of JEFFERSON
On JULY 18, 2000
appeared Lori M. Thorn

before me, Melva Moore

personally known to me (or proved to me on the basis of satisfactory evidence) to be the person(s) whose name(s) is/are subscribed to the within instrument and acknowledged to me that he/she/they executed the same in his/her/their authorized capacity(ies), and that by his/her/their signature(s) on the instrument the person(s), or the entity upon behalf of which the person(s) acted, executed the instrument.
WITNESS my hand and official seal.

Melva J Moore
Signature of Notary

Melva J. Moore
Commission Expires 2/19/2001
Notary Public State of Large, KY

Affiant _____ Known _____ Produced ID _____
Type of ID _____ (Seal)

State of)
County of)
On)
appeared)

before me,

personally known to me (or proved to me on the basis of satisfactory evidence) to be the person(s) whose name(s) is/are subscribed to the within instrument and acknowledged to me that he/she/they executed the same in his/her/their authorized capacity(ies), and that by his/her/their signature(s) on the instrument the person(s), or the entity upon behalf of which the person(s) acted, executed the instrument.
WITNESS my hand and official seal.

Signature of Notary



Affiant _____ Known _____ Produced ID _____
Type of ID _____ (Seal)

Signature of Preparer

Print Name of Preparer

Address of Preparer

(2)

If your state requires 8 1/2" x 11" forms, cut off the bottom of this page at the dotted line.