

DULY ENTERED FOR TAXATION SUBJECT TO  
FINAL ACCEPTANCE FOR TRANSFER

STATE OF INDIANA  
LAKE COUNTY JUL 17 2000  
FILED FOR RECORDS

2000 050297

PETER BENJAMIN  
LAKE COUNTY AUDITOR

MORRIS W. CARTER  
RECORDER

A298-10  
R298-04

### QUITCLAIM DEED

THIS QUITCLAIM DEED, Executed this *17<sup>th</sup>* day of *July* *2000* (year),  
by first party, Grantor, *La Donna R. Thorpe*

whose post office address is *5008-14 W. 17<sup>th</sup> Ave*  
*GARY, IN 46406*

to second party, Grantee, *Elayne H. Willis and La Donna R. Thorpe*  
*(RESERVE HER life ESTATE)*

whose post office address is *5008-14 W. 17<sup>th</sup> Ave*  
*GARY, IN 46406*

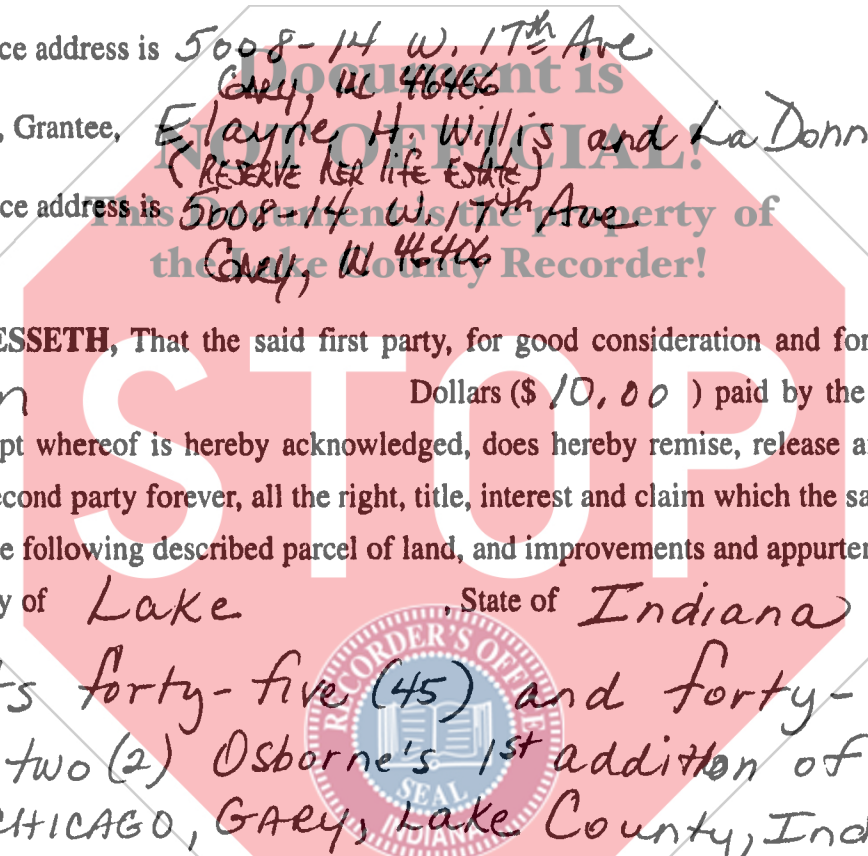

WITNESSETH, That the said first party, for good consideration and for the sum of  
*Ten* Dollars (\$ *10.00* ) paid by the said second  
party, the receipt whereof is hereby acknowledged, does hereby remise, release and quitclaim  
unto the said second party forever, all the right, title, interest and claim which the said first party  
has in and to the following described parcel of land, and improvements and appurtenances there-  
to in the County of *Lake*, State of *Indiana* to wit:

*Lots forty-five (45) and forty-six (46),  
Block two (2) Osborne's 1<sup>st</sup> addition of  
EAST CHICAGO, GARY, Lake County, Indiana*

*AKA 5008-14 W. 17<sup>th</sup> Ave, Gary, Indiana 46406  
Key # 46-275-45*

AKH  
(1)

Rev. 6/98

-----  
If your state requires 8 1/2" x 11" forms, cut off the bottom of this page at the dotted line.



© E-Z Legal Forms. Before you use this form, read it, fill in all blanks, and make whatever changes are necessary to your particular transaction. Consult a lawyer if you doubt the form's fitness for your purpose and use. E-Z Legal Forms and the retailer make no representation or warranty, express or implied, with respect to the merchantability of this form for an intended use or purpose.

00045

*16.cd  
C2*

IN WITNESS WHEREOF, The said first party has signed and sealed these presents the day and year first above written. Signed, sealed and delivered in presence of:

Signature of Witness

Print name of Witness

Signature of Witness

Print name of Witness

Signature of First Party

Print name of First Party

Signature of First Party

Print name of First Party

State of INDIANA

County of LAKE

On 17-July-2000 before me, Lonnie P. Carter  
appeared LADONNA R. Thorpe

personally known to me (or proved to me on the basis of satisfactory evidence) to be the person(s) whose name(s) is/are subscribed to the within instrument and acknowledged to me that he/she/they executed the same in his/her/their authorized capacity(ies), and that by his/her/their signature(s) on the instrument the person(s), or the entity upon behalf of which the person(s) acted, executed the instrument.

WITNESS my hand and official seal.

Signature of Notary

Affiant Known Produced ID  
Type of ID DRIVER

State of

County of

On

before me,

appeared

personally known to me (or proved to me on the basis of satisfactory evidence) to be the person(s) whose name(s) is/are subscribed to the within instrument and acknowledged to me that he/she/they executed the same in his/her/their authorized capacity(ies), and that by his/her/their signature(s) on the instrument the person(s), or the entity upon behalf of which the person(s) acted, executed the instrument.

WITNESS my hand and official seal.

Signature of Notary

Affiant Known Produced ID  
Type of ID \_\_\_\_\_ (Seal)

Signature of Preparer

Print Name of Preparer

Address of Preparer

(2)

If your state requires 8 1/2" x 11" forms, cut off the bottom of this page at the dotted line.