

1

THIS FORM HAS BEEN PREPARED FOR USE IN THE STATE OF INDIANA BY LAWYERS ONLY. THE SELECTION OF A FORM, FILLING IN BLANK SPACES, STRIKING OUT PROVISIONS, AND INSERTION OF SPECIAL CLAUSES, MAY CONSTITUTE THE PRACTICE OF LAW WHICH SHOULD ONLY BE DONE BY A LAWYER.

MAIL TAX BILLS TO: 14 Cypress Drive, Schererville, IN 46375

Enslan, Enslan & Matthews
Attorneys AT Law
142 Rimbach
Hammond, Indiana
46320

QUITCLAIM DEED

THIS INDENTURE WITNESSETH, that ERIN JO DUST

GRANTOR(S) of LAKE County in the State of INDIANA

QUITCLAIM(S) to MARILYN JO DUST

GRANTEE(S) of LAKE County in the State of INDIANA

in consideration of One Dollar (\$1.00) and other valuable consideration, the receipt and sufficiency of which are hereby acknowledged, the following described real estate in LAKE County, in the State of Indiana:

Lot 2, Block One, Plum Creek Village, to the Town of Schererville, Lake County, Indiana, as shown in Plat Book 46, page 101.

Commonly known as: 14 Cypress Drive, Schererville, Indiana.

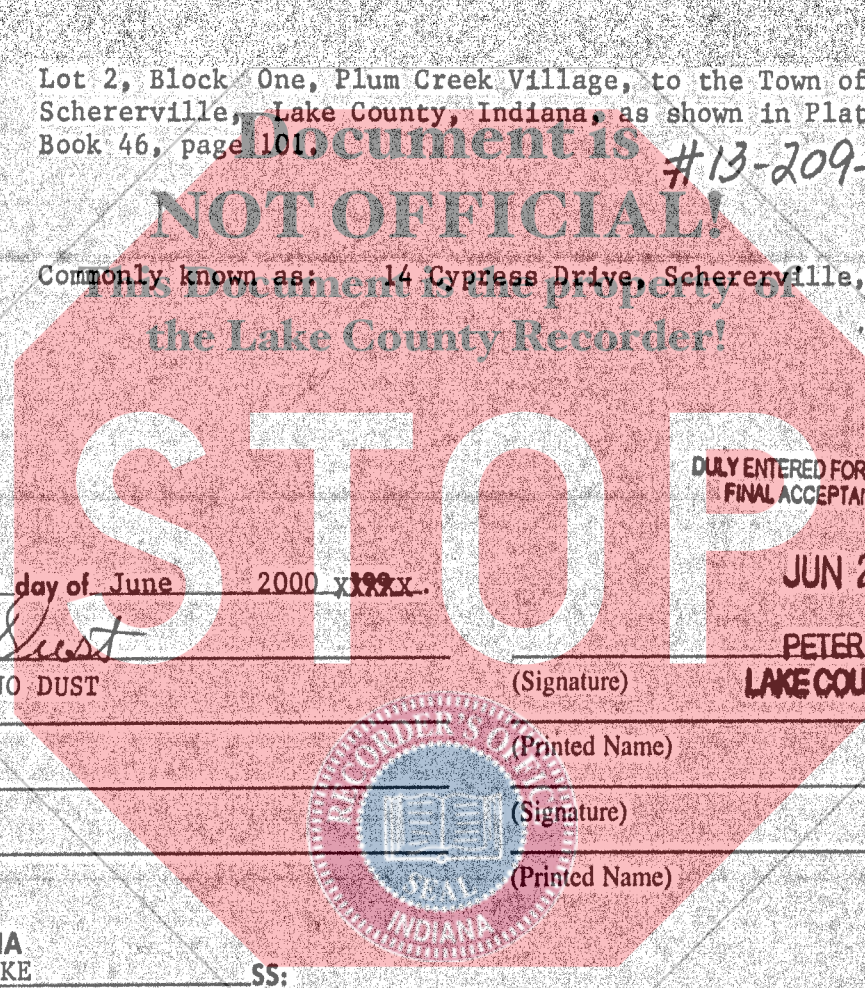

2000 044535

#13-209-2
NO. 13-209-2
RECORDED
2000 JUN 28 AM 8:4
FILED

Dated this 15th day of June 2000 ~~1999~~

JUN 22 2000

Erin Jo Dust
ERIN JO DUST

PETER BENJAMIN
LAKE COUNTY AUDITOR

(Printed Name)

(Printed Name)

(Signature)

(Signature)

(Printed Name)

(Printed Name)

STATE OF INDIANA
COUNTY OF LAKE SS:

Before me, the undersigned, a Notary Public in and for said County and State, this 15th day of June 2000 ~~1999~~, personally appeared: ERIN JO DUST

and acknowledged the execution of the foregoing deed. In witness whereof, I have hereunto subscribed my name and affixed my official seal.

My commission expires: 7-16-02 Signature *William T. Enslan*

Resident of LAKE County Printed WILLIAM T. ENSLEN, Notary Public

STATE OF _____
COUNTY OF _____ SS:

Before me, the undersigned, a Notary Public in and for said County and State, this _____ day of _____, 199____, personally appeared:

and acknowledged the execution of the foregoing deed. In witness whereof, I have hereunto subscribed my name and affixed my official seal.

My commission expires: _____ Signature 02023

Resident of _____ County Printed _____, Notary Public

This instrument prepared by WILLIAM T. ENSLEN, 142 Rimbach, Hammond, Indiana 46320 Attorney at Law
Attorney Identification No. 6722-45

MAIL TO:

14.00
31151