

SRI

FILED
2000 JUN 23 AM 8 52

2000 044161

COMMISSIONERS QUIT CLAIM DEED

THIS INDENTURE WITNESSETH THAT, the Board of Commissioners of LAKE County, State of Indiana, RELEASE, QUIT-CLAIM, AND CONVEY to

CENTIER BANK TRUST
9701 INDIANAPOLIS BLVD
HIGHLAND, IN 46322

for and in consideration of the sum of ONE THOUSAND, SIX HUNDRED AND 0/100 DOLLARS (\$1600) the receipt of which is hereby acknowledged, the following described real estate in LAKE County, State of Indiana:

PROPERTY ID: 31-25-0216-0001
Common Address: APPR 14500 FAIRBANKS
CEDAR LAKE, IN 46303
Legal Description: LOTS 1 TO 28, BLOCK SIX (6) PLAT "D" OF THE SHADES ADDITION TO CEDAR LAKE, AS MARKED AND LAID DOWN ON THE RECORDED PLAT OF SAID ADDITION, AS RECORDED IN THE RECORDERS OFFICE, LAKE COUNTY, INDIANA.

This deed is hereby confirmed as the true, voluntary and official act of the LAKE County Commissioners.

IN WITNESS WHEREOF, the duly elected, qualified, sworn and acting Board of Commissioners of LAKE County, Indiana, have hereunto set their hands as their official act on this 9th day of June, 2000.

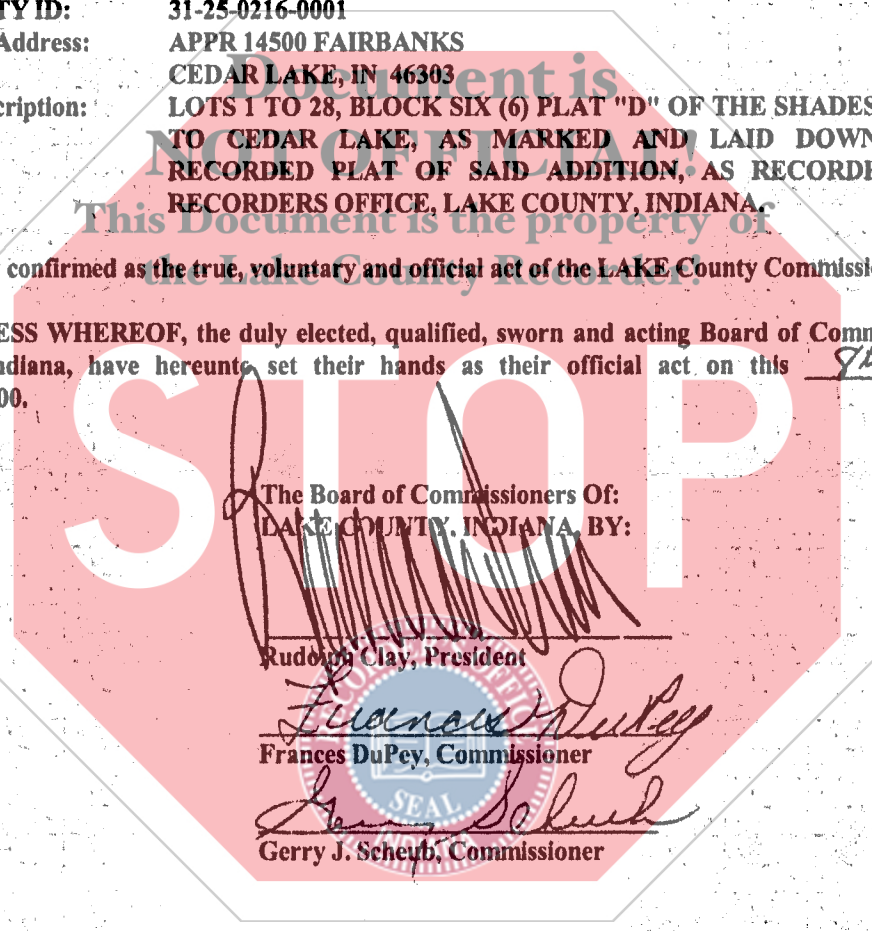

The Board of Commissioners Of:
LAKE COUNTY, INDIANA, BY:

Rudolph Clay
Rudolph Clay, President

Frances DuPey
Frances DuPey, Commissioner

Gerry J. Scheub
Gerry J. Scheub, Commissioner

STATE OF INDIANA, LAKE COUNTY, SS

Before me, the undersigned, duly elected, qualified, sworn and acting Auditor in and for said County and State, empowered by law to acknowledge the deeds of the LAKE County Commissioners, under I.C. 36-2-2-11, 36-2-9-7, 32-1-2-18, 32-1-2-23, and City of Gary v. Belovich, 1987, 504 N.E.2d 286, do now attest that on this 9th day of June 2000, personally came the LAKE County Commissioners, all of whom are personally known to me, and acknowledged the execution of the above and foregoing instrument as their true, voluntary and official act.

WITNESS MY HAND AND OFFICIAL SEAL
Peter Benjamin
PETER BENJAMIN, Auditor of LAKE County

This instrument is prepared by Lee J. Christakis, Attorney
7870 Broadway, Suite G
Merrillville, IN 46410

JUN 14 2000

C1072