

SRI

2000 044108

2000 JUN 23 AM 8 48

MORRIS W. CARTER

COMMISSIONERS QUIT CLAIM DEED

THIS INDENTURE WITNESSETH THAT, the Board of Commissioners of LAKE County, State of Indiana, RELEASE, QUIT-CLAIM, AND CONVEY to

SOUTH SHORE FINANCIAL CORP.
PO BOX 2176
GARY, IN 46409

for and in consideration of the sum of NINE HUNDRED SEVENTY AND 0/100 DOLLARS (\$970) the receipt of which is hereby acknowledged, the following described real estate in LAKE County, State of Indiana:

PROPERTY ID: 25-46-0402-0027
Common Address: 4200 WASHINGTON ST
GARY, IN 46408
Legal Description: LOT 25 AND THE NORTH 18 FEET OF LOT 26, BLOCK 6, REISSIG'S ADDITION TO GLEN PARK, IN THE CITY OF GARY, AS SHOWN IN PLAT BOOK 3, PAGE 99, IN LAKE COUNTY, INDIANA.

This deed is hereby confirmed as the true, voluntary and official act of the LAKE County Commissioners.

IN WITNESS WHEREOF, the duly elected, qualified, sworn and acting Board of Commissioners of LAKE County, Indiana, have hereunto set their hands as their official act on this 23 day of June, 2000.

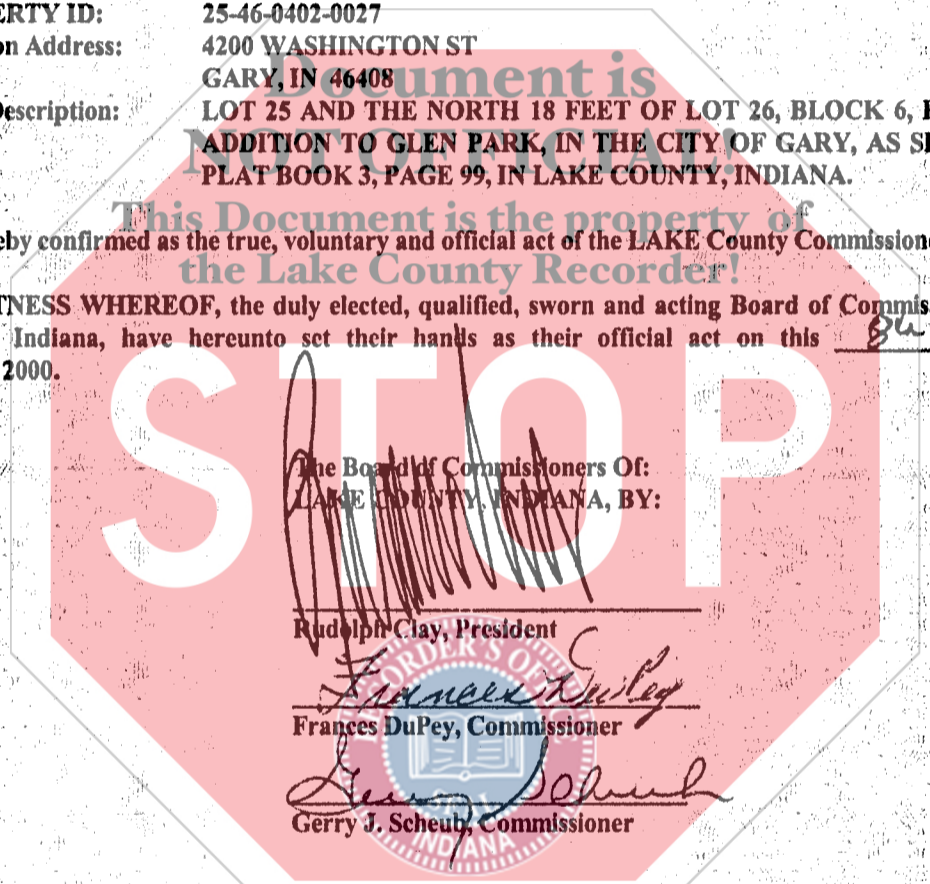

The Board of Commissioners Of:
LAKE COUNTY, INDIANA, BY:

Rudolph Clay
Rudolph Clay, President

Frances DuPey
Frances DuPey, Commissioner

Gerry J. Scheub
Gerry J. Scheub, Commissioner

STATE OF INDIANA, LAKE COUNTY, SS

Before me, the undersigned, duly elected, qualified, sworn and acting Auditor in and for said County and State, empowered by law to acknowledge the deeds of the LAKE County Commissioners, under I.C. 36-2-2-11, 36-2-9-7, 32-1-2-18, 32-1-2-23, and City of Gary v. Belovich, 1987, 504 N.E.2d 286, do now attest that on this 23 day of June 2000, personally came the LAKE County Commissioners, all of whom are personally known to me and acknowledged the execution of the above and foregoing instrument as their true, voluntary and official act.

WITNESS MY HAND AND OFFICIAL SEAL

Peter Benjamin
PETER BENJAMIN, Auditor of LAKE County

This instrument is prepared by Lee J. Christakis, Attorney
7870 Broadway, Suite G
Merrillville, IN 46410

JUN 14 2000

01094