

2

STATE OF INDIANA  
LAKE COUNTY  
FILED FOR RECORD

2000 043708

2000 JUN 22 AM 9:03

MORRIS W. CARTER  
RECORDER

**Partial Release of Mortgage**

BANK ONE, INDIANA, N.A. formerly known as NBD Bank, N.A., a national  
(Bank Name) (state/national)  
banking association ("Mortgagee"), whose address is 8585 Broadway, Merrillville, IN 46410  
(association/corporation)

(Bank Address)  
certifies that the Mortgage executed by Hecimovich Development, Inc.  
("Mortgagor")

whose address is 901 Royal Dublin Lane, Dyer, IN  
to Mortgagee, dated December 24, 1997 and recorded on December 30, 1997  
in Book \_\_\_\_\_ Page \_\_\_\_\_, Instrument No: 97089573 Lake \_\_\_\_\_ County Records, is satisfied and released,  
as to real property located in the \_\_\_\_\_ of \_\_\_\_\_ County, Indiana  
described as:

Lot 44, in Prairie View-Unit 1, and addition to the City of Crown Point, as per plat thereof, recorded in Plat Book 82, page 20, in the Office of the Recorder of Lake County, Indiana.

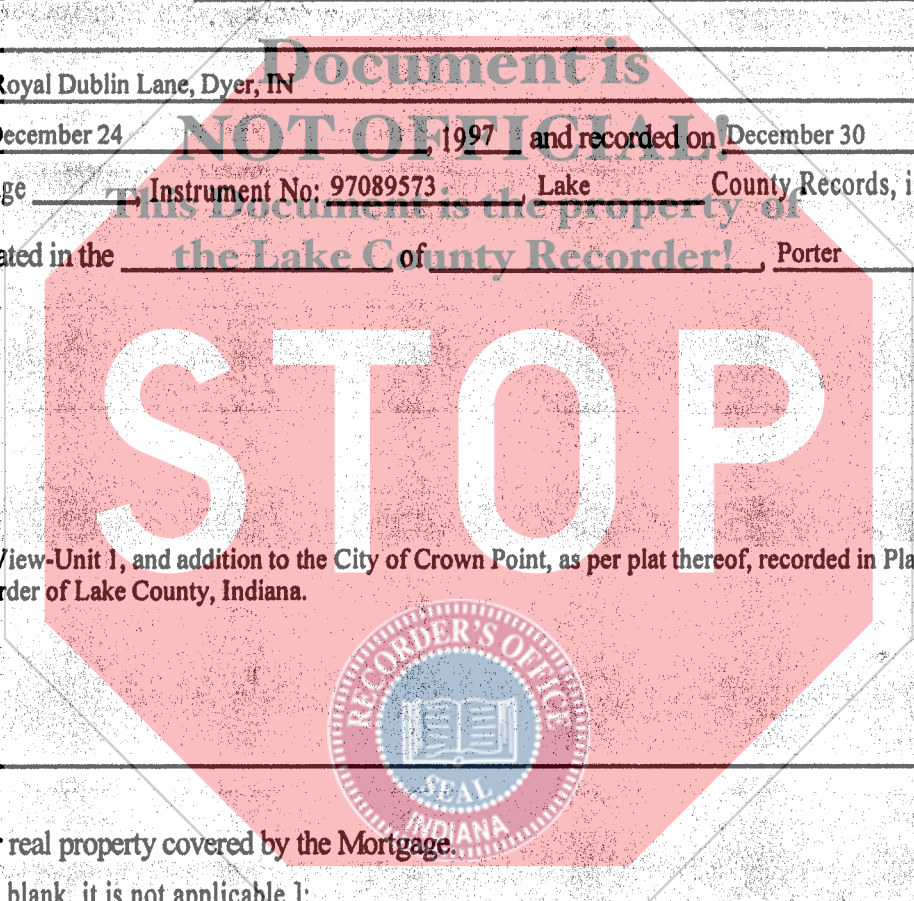

but not as to any other real property covered by the Mortgage.  
Iff the following is left blank, it is not applicable.]:  
The Assignment of Real Estate Leases and Rentals executed by the Mortgagor, dated \_\_\_\_\_, 19\_\_\_\_ and recorded on \_\_\_\_\_, 19\_\_\_\_, in Book \_\_\_\_\_, Page \_\_\_\_\_, Instrument No: \_\_\_\_\_ County Records, and the Subordination of Real Estate Lease executed by \_\_\_\_\_

dated \_\_\_\_\_, 19\_\_\_\_ and recorded on \_\_\_\_\_, 19\_\_\_\_ in Book \_\_\_\_\_ Page \_\_\_\_\_, Instrument No: \_\_\_\_\_ County Records is/are also released only to the extent they cover the above described real property.

Executed on June 8, 2000, 19\_\_\_\_

Bank One, Indiana, NA  
(Name of Bank)  
By: Jeffery B. Glass  
Its: Commercial Banking Officer

TICOR M.O.  
920002840 # 4  
Suleski

12.00  
ET.  
Ti

ACKNOWLEDGEMENT

State of Indiana )  
County of Lake )

Before me, a Notary Public in and for the stated County and State, on June 8, 2000 ) 19\_\_  
came Bank One, Indiana, NA Bank Name, a national (state/national)

banking association by Jeffery B. Glass  
(association/corporation)

its Commercial Banking Officer who acknowledged the execution of the foregoing instrument on  
behalf of the Mortgagee.

*Lawanna P. Gee*  
\_\_\_\_\_  
LAWANNA P. GEE, Notary Public

My Commission Expires: \_\_\_\_\_ Residing My Commission Expires: September 23, 2000 Notary Public  
Resident of Porter County, Indiana County, Indiana

This instrument was prepared by: Lawanna P. Gee, CRELA When Recorded Return to:  
Bank One, Indiana, NA 8585 Broadway, Merrillville, IN 46410

This Document is the property of  
the Lake County Recorder!

