

①

STATE OF INDIANA
LAKE COUNTY
FILED

Mail Tax Bills To: 043010
2000

2000 JUN 20 AM 9:51

13005 Colfax
Cedar Lake, IN 46303

MORRIS W. CARTER
RECORDER

CL20001973LD

WARRANTY DEED

THIS INDENTURE WITNESSETH, That MARK A. LUTZOW

("Grantor") of LAKE County in the State of INDIANA CONVEY(S)
AND WARRANT(S) TO LARRY LUEBCKE and JERRY LUEBCKE, AS JOINT
TENANTS WITH RIGHTS OF SURVIVORSHIP

("Grantee") of LAKE County in the State of INDIANA in
consideration of One Dollar and other valuable consideration, the
receipt and sufficiency of which are hereby acknowledged, the
following described real estate in LAKE County in the State of
Indiana:

Lot 15 in Lemon Lake Estates Unit 4, an Addition to the Town
of Cedar Lake, as per plat thereof, recorded in Plat Book 51,
Page 6, and amended by a Plat of Correction recorded in Plat
Book 73, Page 43, in the Office of the Recorder of Lake
County, Indiana, more commonly known as:

13005 Colfax
Cedar Lake, IN 46303

Tax Key # 31-25-293-15

Subject to covenants and restrictions, easements for streets and
utilities, and building lines, as contained in plat of subdivision
and as contained in all other documents of record; and taxes for
1999 due and payable in 2000.

Dated this 14th day of June, 2000.

(Signature)

(Signature)

(Printed Name)

MARK A. LUTZOW
(Printed Name)

STATE OF INDIANA, COUNTY OF LAKE SS:

Before me, the undersigned, a Notary Public in and for said County and State,
this 14th day of June, 2000, personally appeared:

MARK A. LUTZOW

and acknowledged the execution of the foregoing deed. In witness
whereof I have hereunto subscribed my name and affixed my official
seal.

My Comm. Exp.: 11 November, 2007

Signature

Resident of

Porter County

Printed

LORI L. SHELBY

LORI L. SHELBY

Notary Public, State of Indiana
County of Porter

My Commission Expires Nov. 11, 2007

JUN 19 2000

This instrument prepared by ATTY. JOS. S. IRAK, 9219 Broadway, M'ville, IN 46410
Atty. I.D. #4851-45 (219) 769-4552

MAIL TO:

01333

Chicago Title Insurance Company

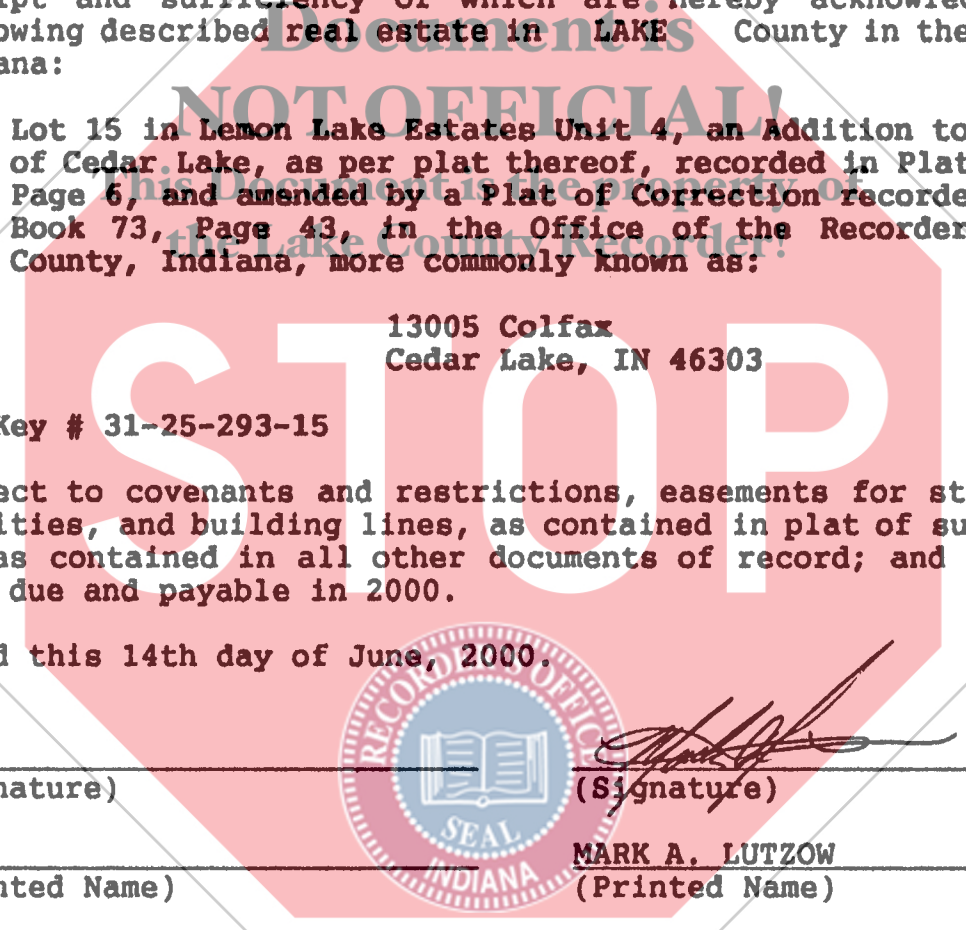

14-000
14-000
14-000