

2

MORTGAGE / DEED OF TRUST ASSIGNMENT

2000 038681

2000-03-31 AM 9:26

6905695018

For value received, Conseco Bank, Inc., a corporation organized and existing under the laws of the State of Utah, hereby assigns to Conseco Finance Servicing Corp., its successors and assigns, all right, title, and interest in and to a certain Mortgage / Deed of Trust dated November 26, 1999, made by Anthony T Grant and Linda Grant, husband and wife., as mortgagor(s), to Conseco Bank, Inc., as mortgagee, as filed in the offices of the County Recorder, county of Lake, State of Indiana, together with the Note secured by such mortgage / deed of trust on the following described property situated in the above county and state, to wit:

See attached exhibit A for legal description.

Date this day of March 31, 2000.

Mtg. Rec. Bk. Pg.

Instrument #

99105534

Document is NOT OFFICIAL! This document is the property of the Lake County Recorder!

Conseco Bank, Inc.

By

Julie Larson
Julie Larson, Authorized Agent



State of Arizona

) ss

County of Maricopa

As a Notary Public for the State of Arizona, I hereby certify that Julie Larson personally came before me on this date and acknowledged that he/she is an Authorized Agent of Conseco Bank, Inc., a Utah corporation, and that by authority duly given and as the act of the corporation, the foregoing instrument was signed in its name by him/her.

Witness my hand and official seal dated this day March 31, 2000.

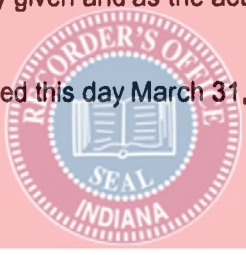

(Notary Seal)

Joanne E. Stark
Notary Public

My Commission Expires:

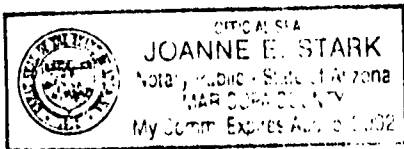

[WHEN RECORDED RETURN TO]
NTC ATTN: DARRELL COLON
101 N. BRAND BLVD., SUITE #1800
GLENDALE, CALIFORNIA 91203
GREENTREE LOAN: 6905695018



13⁰⁰/₂₁
574571
576121

EXHIBIT A

Legal Description:

THE FOLLOWING DESCRIBED REAL ESTATE IN LAKE ACOUNTY, IN THE STATE OF INDIANA:

LOTS 36,37, AND NORTH 1/2 OF LOT 35 IN BLOCK 9 IN GLENDALE SUBDIVISION, IN THE CITY OF GARY , AS PER PLAT THEREOF, RECORDED IN PLAT BOOK 11, PAGE 7, IN THE OFFICE OF THE RECORDER OF LAKE COUNTY, INDIANA.

SUBJECT TO RESTRICTIONS, RESERVATIONS, EASEMENTS, CONENANTS, OIL, GAS, OR MINERAL RIGHTS OF RECORD, IF ANY.

Parcel ID: 25-43-0277-0040

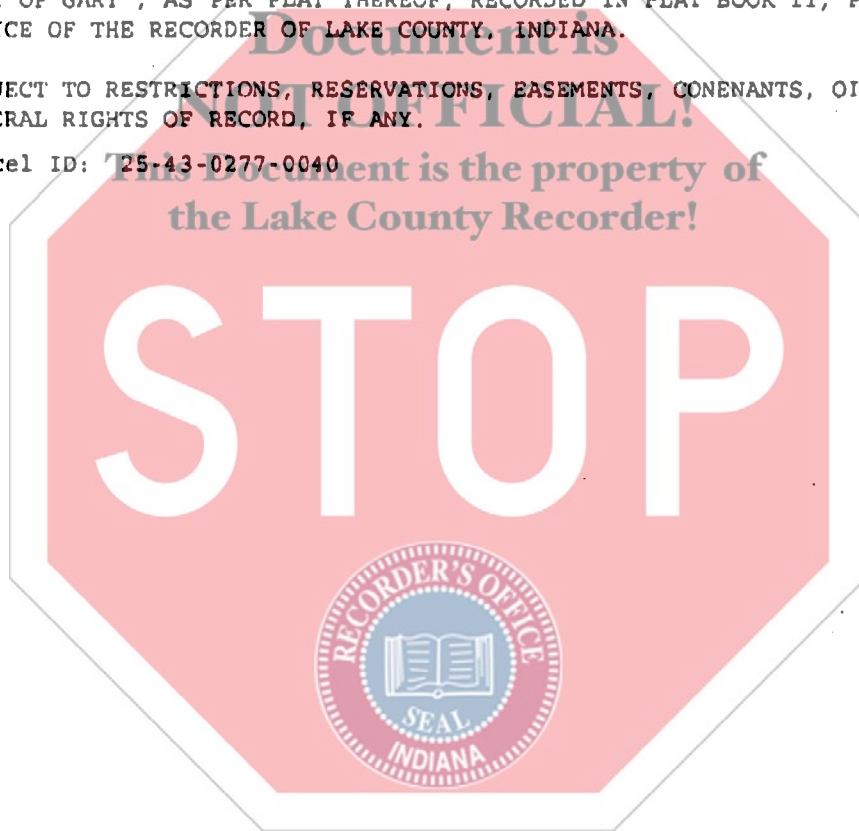

✓ A.T.G.
✓ L.G.