



2000 037540

STATE OF INDIANA
LAKE COUNTY
FILED FOR RECORD

2000 MAY 30 AM 11:52

MORRIS W. CARTER
Partial Release of Mortgage
(Loan #366690201)

UNION PLANTERS BANK, N.A.

Parcel "A" (1843 Windfield Drive)

00-02334

Union Planters Bank, N.A., a national banking association ("Mortgagee") whose address is P.O. Box 780, Lafayette, IN 47902-0780 certifies that the Mortgage executed by **ATG Homes, LLC** ("Mortgagor") whose address is **One Professional Center, Suite 304, Crown Point, IN 46307** to Mortgagee, dated **October 1, 1999** and recorded on **October 8, 1999**, Document No: **99083571**, Lake County Records, is satisfied and released, as to property located in the **Town of Munster, Lake County, Indiana** described as:

Part of Lot 15, the Townhomes at White Oak Estates, Block 7, to the Town of Munster, Lake County, Indiana, as recorded in Plat Book 86, page 67 in the Office of the Recorder of Lake County, Indiana, more particularly described as follows: Beginning at the Southeast corner of said Lot 15; thence North 89° 28' 04" West, along the Southerly line of Lot 15, said line also being the Northerly Right-of-Way line of Winfield Drive, a distance of 210.51 feet to the Southwest corner of Lot 15, thence North 00° 31' 56" East, along the Westerly line of Lot 15, a distance of 50.00 feet, to a point of deflection in said Westerly line; thence continuing along said Westerly line of Lot 15; North 52° 41' 42" East, a distance of 38.08 feet; thence South 81° 44' 57" East, a distance of 182.09 feet to the Easterly line of Lot 15; thence South 00° 31' 56" West, along said Easterly line of Lot 15, a distance of 48.90 feet to the place of beginning, all in the Town of Munster, Lake County, Indiana.

but not as to any other real property covered by the Mortgage.

[If the Following is left Blank, it is not applicable.]:

The Assignment of Real Estate Leases and Rentals executed by the Mortgagor, dated _____, 19__ and recorded on _____, 19__ in Book _____ Page _____, Instrument No: _____, _____ County Record, and the Subordination of Real Estate Lease executed by _____ dated _____, 19__ and recorded on _____, 19__ in Book _____ Page _____, Instrument No: _____, _____ County Records is/are also released only to the extent they cover the above described real property.

Executed on **May 5, 2000**.

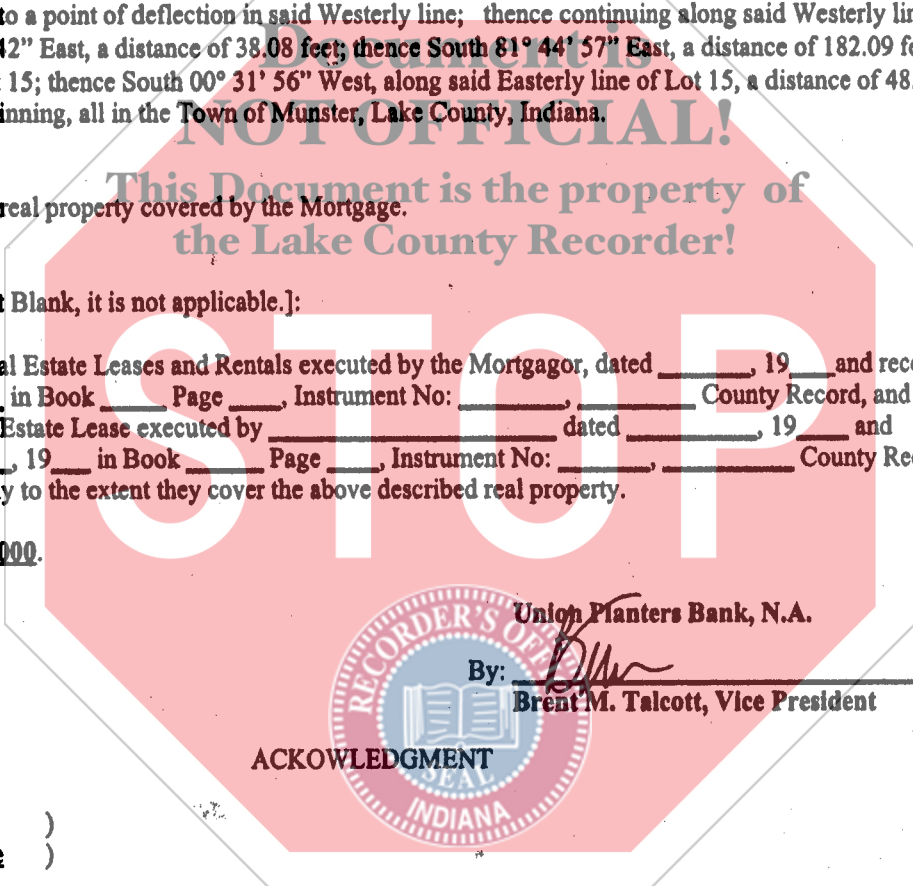

Union Planters Bank, N.A.

By: *Brent M. Talcott*
Brent M. Talcott, Vice President

ACKNOWLEDGMENT

State of Indiana)
County of **Tippecanoe**)

Before me, a notary public in and for the stated County and State, on **May 5, 2000** came **Union Planters Bank, N.A.**, a national Banking association, by **Brent M. Talcott**, its **Vice President**, who acknowledged the execution of the foregoing instrument on the behalf of the Mortgagee.

Mary Lynn Davis

My Commission Expires: **August 20, 2006**

Mary Lynn Davis Notary Public
Residing in **Benton** County, Indiana

This instrument was prepared by:
B. Talcott/M.L. Davis

When Recorded Return to:
Union Planters Bank, N.A.
PO Box 780
MS 342
Lafayette, IN 47902-0780

LAWYERS TITLE INS. CORP.
ONE PROFESSIONAL CENTER
SUITE 215
CROWN POINT, IN 46307

4
10⁰⁰
FB