

RECORDING REQUESTED BY, AND WHEN RECORDED, MAIL TO:

AAMES CAPITAL CORPORATION
c/o Collateral Control Department
350 S. Grand Avenue - 42nd Floor
Los Angeles, California 90071

STATE OF INDIANA
LAKE COUNTY
FILED FOR RECORD

2000 MAY -8 AM 9 05

MORRIS W. CARTER
RECORDER

Loan Number IL014442

Order #:
Escrow #: CLOSER

Application #: 9575855

SPACE ABOVE THIS LINE FOR RECORDING DATA

Assignment of Mortgage

FOR VALUE RECEIVED, AAMES FUNDING CORPORATION, A CALIFORNIA CORPORATION, DBA AAMES HOME LOAN ("Assignor"), having its principal place of business at 3347 MICHELSON DRIVE SUITE 300, IRVINE, CALIFORNIA, 92612

hereby grants, assigns, and transfers to AAMES CAPITAL CORPORATION, A CALIFORNIA CORPORATION, 350 S. Grand Ave., L.A. CA 90071, ("Assignee"), all of Assignor's right, title and interest in, to, and under that certain Mortgage dated OCTOBER 5, 1999 executed and delivered by EDWARD A. BUTLER, JR. AND DOROTHY D. BUTLER

to Assignor (the "Mortgagee"), which Mortgage is recorded as Official Records in the County Recorder's office of LAKE County, State of Indiana, covering certain real estate and other property described therein, more particularly described as follows:

LOT 119 IN TURKEY CREEK SOUTH UNIT 3, IN THE TOWN OF MERRILLVILLE, AS PER PLAT THEREOF, RECORDED IN PLAT BOOK 38 PAGE 74, IN THE OFFICE OF THE RECORDER OF LAKE COUNTY, INDIANA.

Rec. Date: 10/8/99
Instr # 99083319
Mort. Amt. \$83,610.00

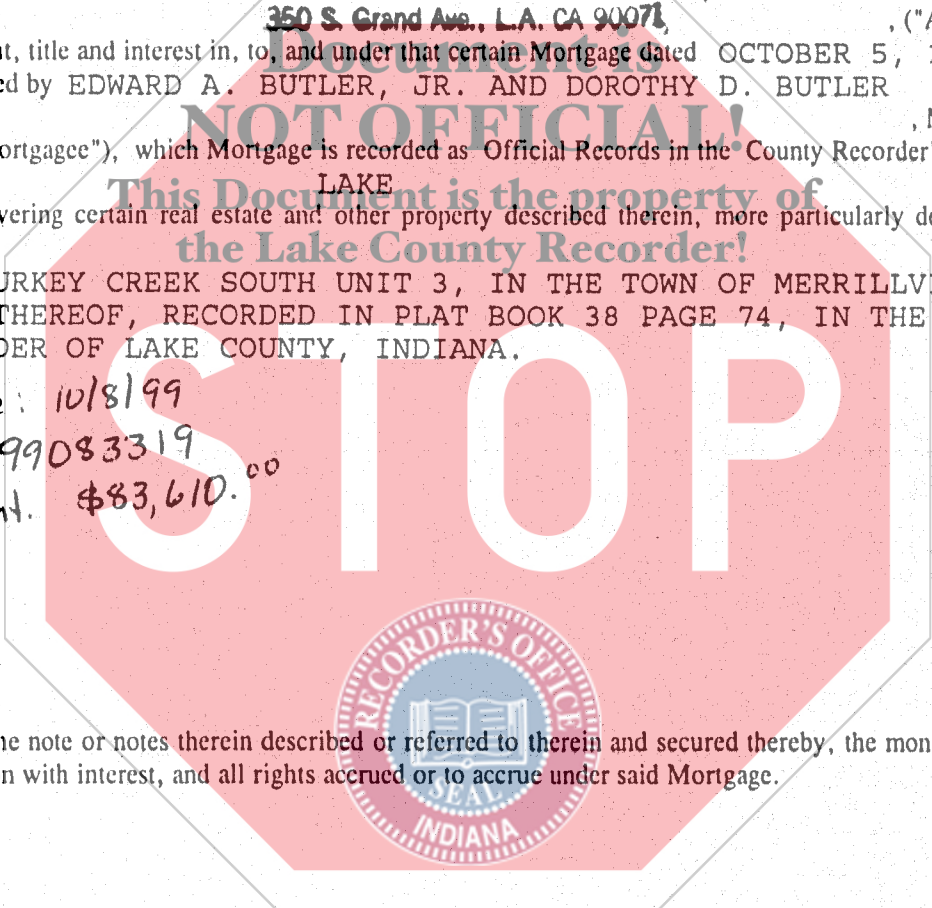

TOGETHER with the note or notes therein described or referred to therein and secured thereby, the money due and to become due thereon with interest, and all rights accrued or to accrue under said Mortgage.

PREPARED BY AAMES
350 S. GRAND AVE. 42nd FL
LOS ANGELES, CA 90071

INDIANA - ALL PROGRAMS
Laser Forms Inc. (800) 446-3555
LIFT #OSM101IN 10/95

Page 1 of 2

Borrower's Initials: _____

INAOM1.05

12.00
102
116361

IN WITNESS WHEREOF, Assignor has caused this Assignment of Mortgage to be executed by its duly authorized officer as of the day and year first written below.

AAMES FUNDING CORPORATION, A CALIFORNIA CORPORATION, DBA AAMES HOME LOAN
3347 MICHELSON DR., STE. 300
IRVINE, CA 92612

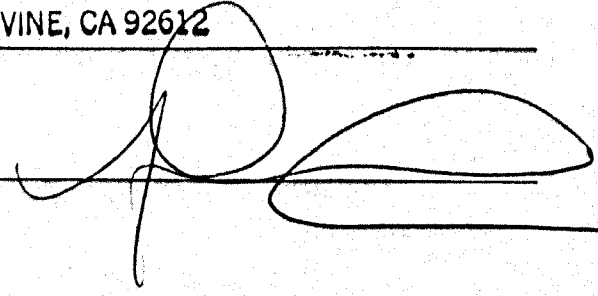

DANA LANTRY
VICE PRESIDENT

DATE ~~OCT 08 1999~~ OCT 11 1999
STATE OF CALIFORNIA
COUNTY OF ORANGE

On ~~OCT 08 1999~~ OCT 11 1999, before me, D.A. Yablonsky, personally appeared DANA LANTRY VICE PRESIDENT

personally known to me (or proved to me on the basis of satisfactory evidence) to be the person(s) whose name(s) is/are subscribed to the within instrument and who, having been duly sworn, and acknowledged to me that he/she/they executed the same in his/her/their authorized capacity(ies), and that by his/her/their signature(s) on the instrument the person(s), or the entity upon behalf of which the person(s), acted, executed the instrument and stated that any representations contained herein are true.

WITNESS my hand and official seal.

Signature

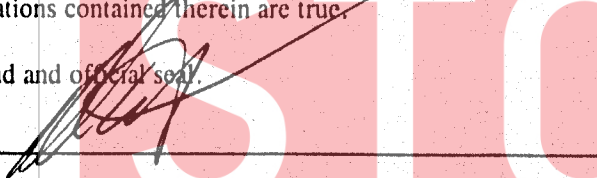

D.A. Yablonsky

(Seal)

