

STATE OF INDIANA  
LAKE COUNTY  
Return To: Jerome Katz, 3 New York Plaza

2000 029141

2000 MAY - ~~New York~~ New York 10004

WARRANTY **THIS INDENTURE WITNESSETH**  
RECORDER

That Ed Ash  
of Lake County, and State of Indiana

**CONVEY AND WARRANT**

To Indiana Partners, LLC  
of Manhattan County, in the State of New York

for the sum of Ten Dollars and other good and valuable consideration Dollars

the following described REAL ESTATE in Lake County, in the  
State of Indiana, to-wit

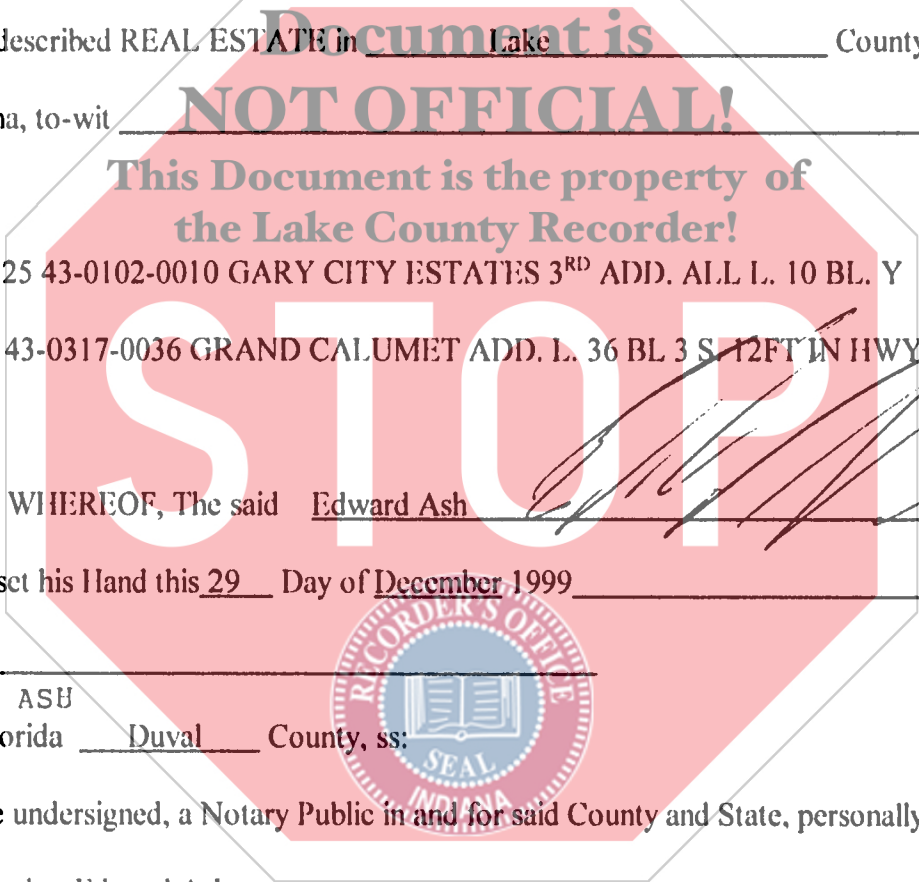

Unit # 25 43-0102-0010 GARY CITY ESTATES 3<sup>RD</sup> ADD. ALL L. 10 BL. Y

Unit # 25 43-0317-0036 GRAND CALUMET ADD. L. 36 BL 3 S. 12FT IN HWY US 20

IN WITNESS WHEREOF, The said Edward Ash

Has hereunto set his Hand this 29 Day of December 1999

EDWARD ASH  
STATE OF Florida Duval County, ss:

Before me, the undersigned, a Notary Public in and for said County and State, personally appeared  
the within named Edward Ash

who acknowledged the execution of the foregoing Deed to be his voluntary act and deed.

WITNESS, my hand and Seal this 29<sup>th</sup> Day of December 1999

My commission expires M. Jean Mason

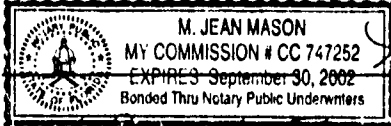

County of Residence Duval County, FL

Mail Tax Statement To Jerome Katz, 3 New York Plaza, New York, N. Y. 10004

This instrument prepared by Jean Mason, assistant to Edward Ash

DULY ENTERED FOR TAXATION SUBJECT TO  
FINAL ACCEPTANCE FOR TRANSFER

MAY 0 1 2000

PETER BENJAMIN  
LAKE COUNTY AUDITOR

14-02  
12/29  
CS