

STATE OF INDIANA
LAKE COUNTY
FILED FOR RECORD

2000 027986

2000 ~~MAR~~ 26 AM 9:13

THIS FORM HAS BEEN PREPARED FOR USE IN THE STATE OF INDIANA BY LAWYERS ONLY. SELECTING A FORM OF INSTRUMENT, FILLING IN BLANK SPACES, STRIKING OUT PROVISIONS AND INSERTING SPECIAL CLAUSES MAY CONSTITUTE THE PRACTICE OF LAW, WHICH SHOULD BE PERFORMED ONLY BY A LAWYER.

MAIL TAX BILLS TO:

1705 E. 163rd
Lowell, IN 46356

QUITCLAIM DEED

THIS INDENTURE WITNESSETH, that JAMES AND MARGARET MITSCH, HUSBAND AND WIFE

GRANTOR(S) of LAKE County in the State of INDIANA

QUITCLAIM(S) to DONALD W. MAY AND HILDA J. MAY, HUSBAND AND WIFE

GRANTEE(S) of LAKE County in the State of INDIANA

in consideration of One Dollar (\$1.00) and other valuable consideration, the receipt and sufficiency of which are hereby acknowledged, the following described real estate in LAKE County, in the State of Indiana:

SEE ATTACHED LEGAL DESCRIPTION

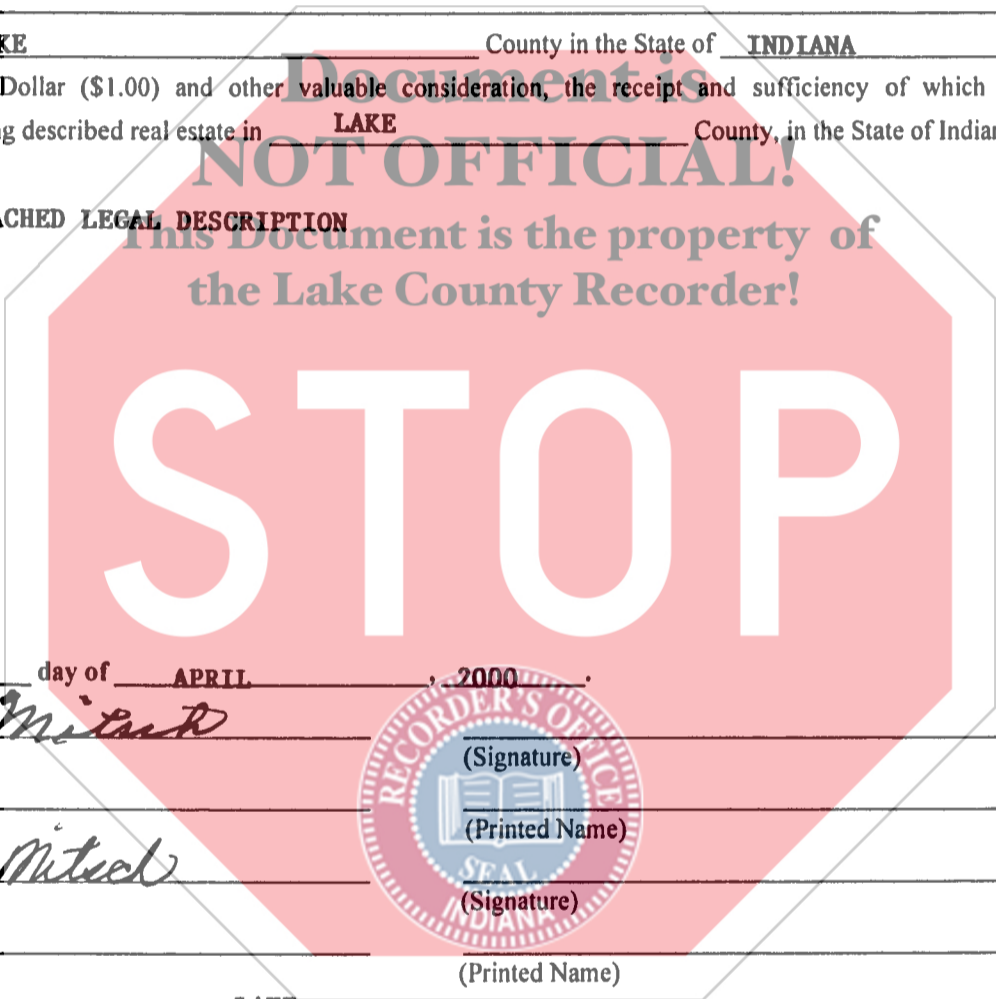

Dated this 25TH day of APRIL, 2000.

James Mitsch
(Signature)
JAMES MITSCH

(Signature)

Margaret Mitsch
(Signature)

(Printed Name)

MARGARET MITSCH
(Printed Name)

(Signature)

(Printed Name)

STATE OF INDIANA, COUNTY OF LAKE SS:

Before me, the undersigned, a Notary Public in and for said County and State, this 25TH day of APRIL, personally appeared: JAMES MITSCH AND MARGARET MITSCH

and acknowledged the execution of the foregoing deed. In witness whereof, I have hereunto subscribed my name and affixed my official seal.

My commission expires: 10-29-08 Signature Kerrie L. Cole

Resident of LAKE County Printed KERRIE L. COLE Notary Public

This instrument prepared by RICHARD A. ZUNICA, Attorney at Law

Attorney No. 1504-45

MAIL TO:



© COPYRIGHT 1997, THE ALLEN COUNTY INDIANA BAR ASSOCIATION, INC. (REV. 2/97, 6/99)

JULY ENTERED FOR TAXATION SUBJECT TO FINAL ACCEPTANCE FOR TRANSFER.

APR 26 2000

PETER BENJAMIN
LAKE COUNTY AUDITOR

16.00
/m

Document is
NOT OFFICIAL!

This Document is the property of
the Lake County Recorder!

NW CORNER
SEC 11-3318
MON. FOUND

PARCEL 2: Part of the Southwest quarter of the Southwest Quarter of Section 11, Township 33 North, Range 8 West of the Second Principle Meridian described as follows: Commencing at an iron rod found at the Northwest corner of said Quarter Quarter Section; thence South 88°47' East along the North line of said Quarter Quarter Section 530.00 to the true point of beginning; thence continue South 88°47' East along said North line a distance of 30.00 feet; thence South 01°13' West, perpendicular to said North line, a distance of 403.00 feet; thence North 88°47' West, parallel with said North line, a distance 30.00 feet; thence North 01°13' East a distance of 403.00 feet to the point of beginning, containing 0.278 acres more or less, all in Lake County, Indiana.

PARCEL 3: Part of the Southwest Quarter of the Southwest Quarter of Section 11, Township 33 North, Range 8 West of the Second Principle Meridian described as follows: Commencing at an iron rod found at the Northwest corner of said Quarter Quarter Section; thence South 88°47' East along the North line of said Quarter Quarter Section 360.00 to the true point of beginning; thence continue South 88°47' East along said North line a distance of 35.00 feet; thence South 01°13' West, perpendicular to said North line a distance of 35.00 feet; thence South 01°13' West perpendicular to said North line, a distance of 403.00 feet; thence North 88°47' West, parallel with said North line, a distance of 35.00 feet; thence North 01°13' East a distance of 403.00 feet to the point of beginning, containing 0.324 acres more or less, all in Lake County, Indiana.

