

STATE OF INDIANA

2000 027810

APR 15 2000

A298-10
R298-04

QUITCLAIM DEED

THIS QUITCLAIM DEED, Executed this 15 day of February, 1999 (year),

by first party, Grantor, Patricia Ann Scheuer

whose post office address is 2767 Hancock St., Lake Station, IN 46405

to second party, Grantee, John E. Scheuer

whose post office address is 2724 Lake St., Lake Station, IN 46405

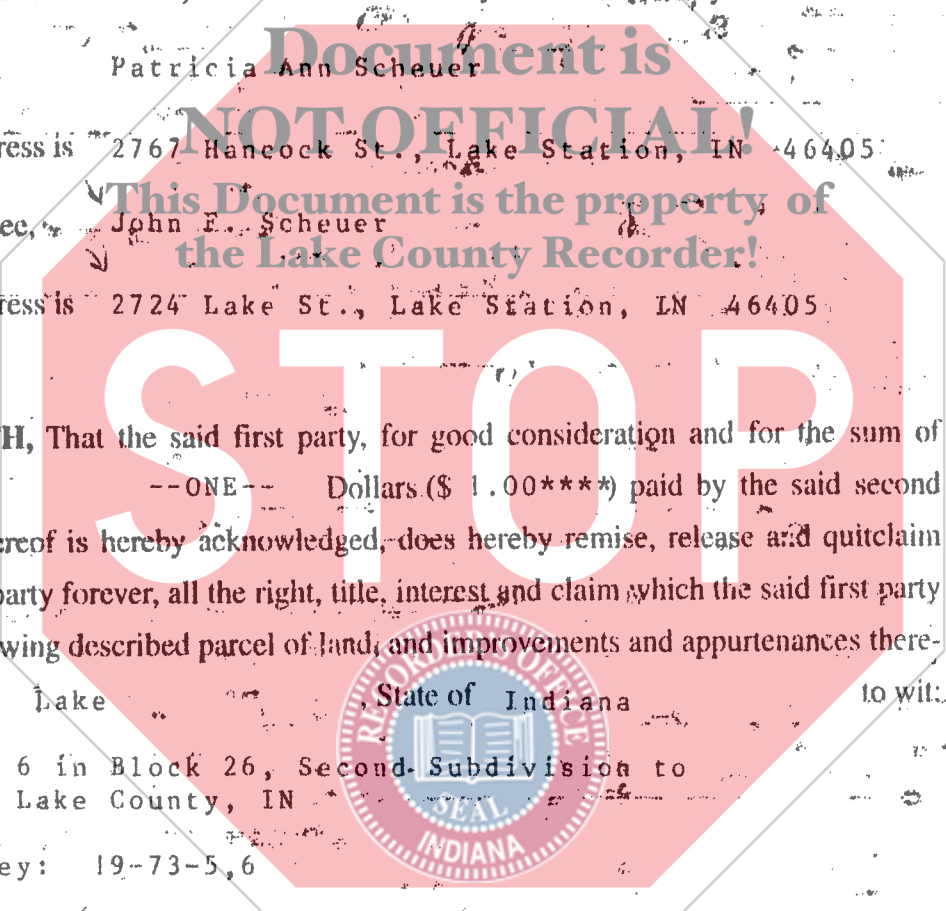

WITNESSETH, That the said first party, for good consideration and for the sum of ONE Dollars (\$ 1.00****) paid by the said second party, the receipt whereof is hereby acknowledged, does hereby remise, release and quitclaim unto the said second party forever, all the right, title, interest and claim which the said first party has in and to the following described parcel of land, and improvements and appurtenances there-
to in the County of Lake, State of Indiana to wit:

Lots 5 and 6 in Block 26, Second Subdivision to East Gary, Lake County, IN Unit 14, Key: 19-73-5,6

RECORDED FOR TAXATION PURPOSES
ACCEPTANCE FOR TRANSFER

APR 25, 2000

ZZHF
(1)

Rev 6/98

If your state requires 8 1/2" x 11" forms, cut off the bottom of this page at the dotted line.

00623



© E-Z Legal Forms. Before you use this form, read it, fill in all blanks, and make whatever changes are necessary to your particular transaction. Consult a lawyer if you doubt the form's fitness for your purpose and use. E-Z Legal Forms and the retailer make no representation or warranty, express or implied, with respect to the merchantability of this form for an intended use or purpose.

16.000
FBI
CASE

IN WITNESS WHEREOF, The said first party has signed and sealed these presents the day and year first above written. Signed, sealed and delivered in presence of:

James E. Scheuer
Signature of Witness

Patricia Ann Scheuer
Signature of First Party

James E. Scheuer
Print name of Witness

Patricia Ann Scheuer
Print name of First Party

Charlotte J. Scheuer
Signature of Witness

Signature of First Party

Charlotte Scheuer
Print name of Witness

Print name of First Party

State of Indiana
County of Lake

On February 26, 1999 before me, appeared Patricia Ann Scheuer personally known to me (or proved to me on the basis of satisfactory evidence) to be the person(s) whose name(s) is/are subscribed to the within instrument and acknowledged to me that he/she/they executed the same in his/her/their authorized capacity(ies), and that by his/her/their signature(s) on the instrument the person(s), or the entity upon behalf of which the person(s) acted, executed the instrument.
WITNESS my hand and official seal.

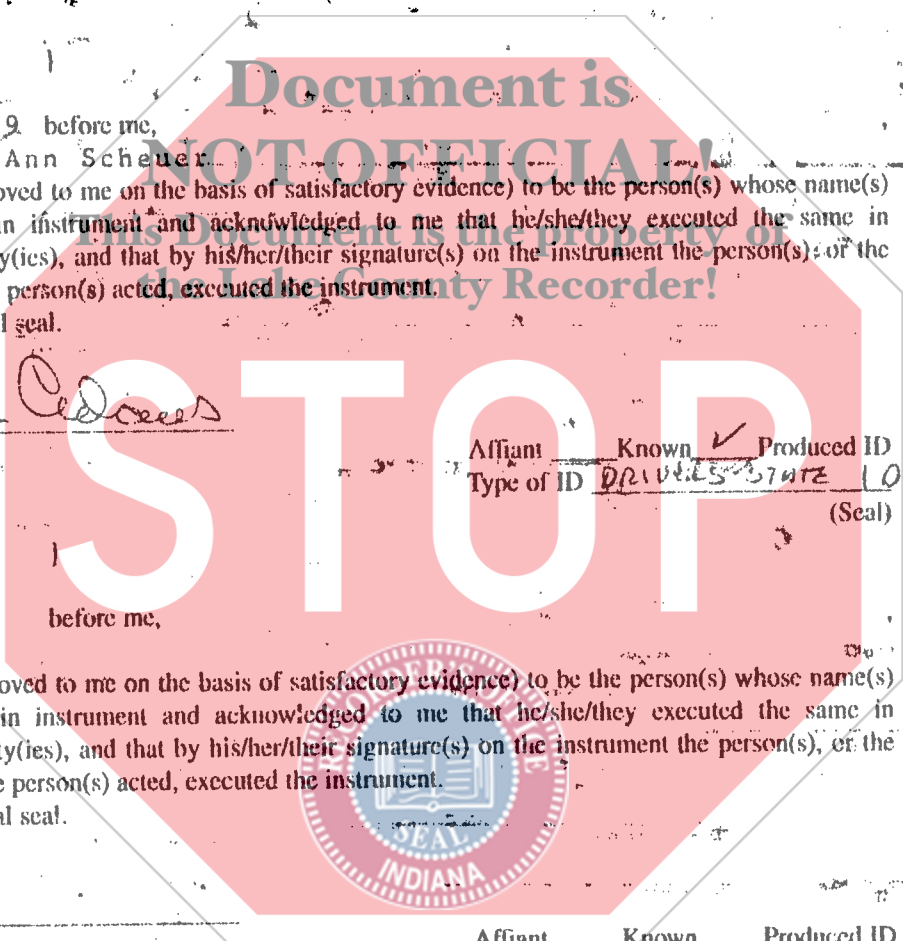

Mary Ann Adams
Signature of Notary

Affiant _____ Known Produced ID
Type of ID DRIVERS STATE IO
(Seal)

State of
County of
On
appeared

before me,

personally known to me (or proved to me on the basis of satisfactory evidence) to be the person(s) whose name(s) is/are subscribed to the within instrument and acknowledged to me that he/she/they executed the same in his/her/their authorized capacity(ies), and that by his/her/their signature(s) on the instrument the person(s), or the entity upon behalf of which the person(s) acted, executed the instrument.
WITNESS my hand and official seal.

Signature of Notary

Affiant _____ Known _____ Produced ID
Type of ID _____
(Seal)

John F. Scheuer
Signature of Preparer

John F. Scheuer
Print Name of Preparer

2724 Lake St., Lake Station, IN 46405
Address of Preparer

(2)

If your state requires 8 1/2" x 11" forms, cut off the bottom of this page at the dotted line.