

STATE OF INDIANA  
LAKE COUNTY  
FILED FOR RECORD

2000 027493

2000 APR 24 PM 1:53

MOORE & GANTER  
RECORDERS

J

### QUITCLAIM DEED

A298-10  
R298-04

THIS QUITCLAIM DEED, Executed this 24 day of April, 2000 (year),

by first party, Grantor, *GENEVIA I. STRONG*  
whose post office address is *2741 CENTRAL AVE, GARY, IND 46407*  
to second party, Grantee, *JANET L. GIBARK*  
whose post office address is *2741 CENTRAL AVE, GARY, IND 46407*

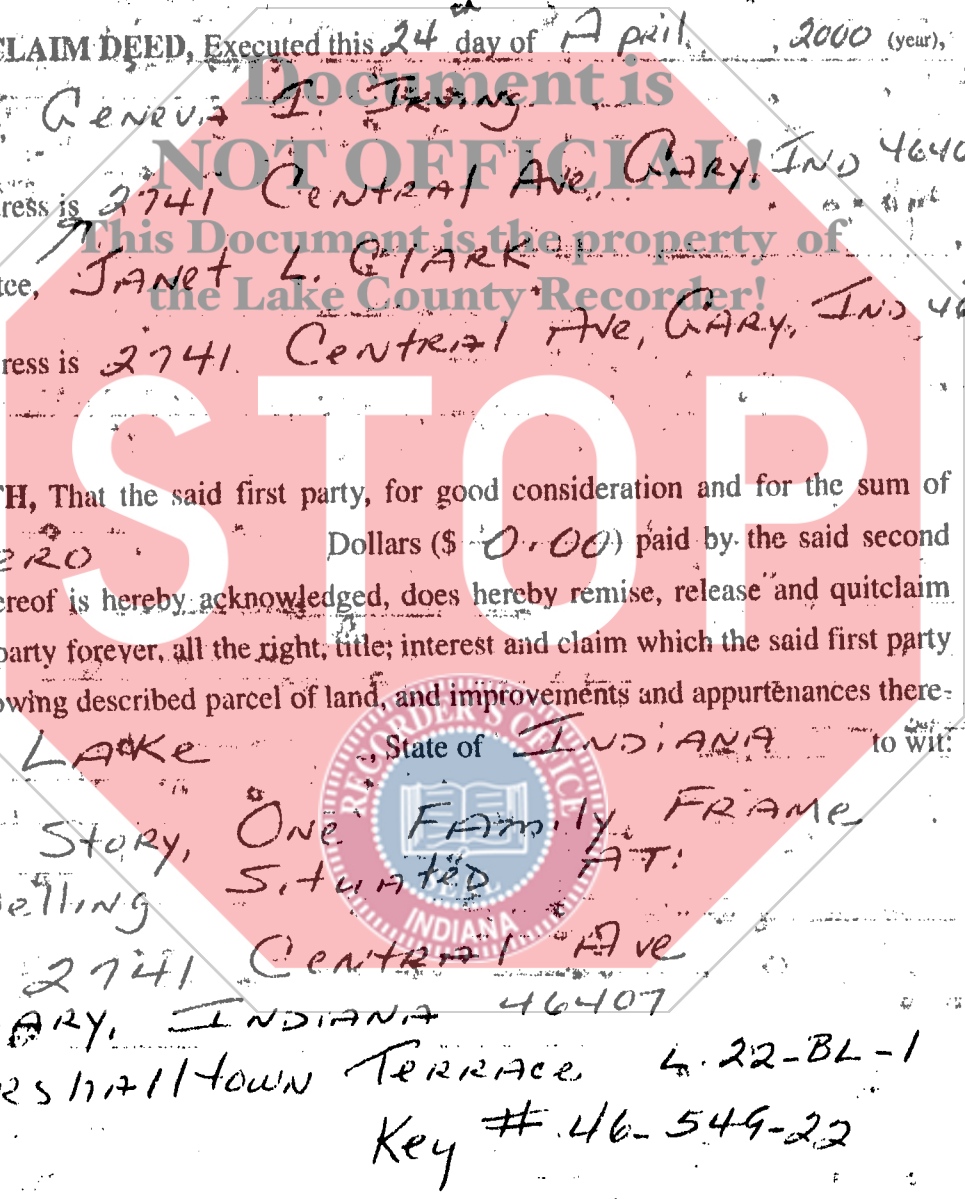

WITNESSETH, That the said first party, for good consideration and for the sum of *ZERO* Dollars (\$ *0.00*) paid by the said second party, the receipt whereof is hereby acknowledged, does hereby remise, release and quitclaim unto the said second party forever, all the right, title, interest and claim which the said first party has in and to the following described parcel of land, and improvements and appurtenances there-  
to in the County of *LAKE*, State of *INDIANA* to wit:

*ONE STORY, ONE FAMILY FRAME Dwelling SITUATED AT: 2741 CENTRAL AVE GARY, INDIANA 46407 MARSHAL TOWN TERRACE L-22-BL-1 Key # 46-549-22*

ABAA (1)

Rev. 4/99

If your state requires 8 1/2" x 11" forms, cut off the bottom of this page at the dotted line.

DULY ENTERED FOR TAXATION SUBJECT TO FINAL ACCEPTANCE FOR TRANSFER.

APR 24 2000

PETER BENJAMIN  
LAKE COUNTY AUDITOR



16.00  
E.P.  
CS

IN WITNESS WHEREOF, The said first party has signed and sealed these presents the day and year first above written. Signed, sealed and delivered in presence of:

Janet L Clark  
Signature of Witness

Geneva I Irving Jackson  
Signature of First Party

JANET L CLARK  
Print name of Witness

GENEVA I IRVING JACKSON  
Print name of First Party

June Key  
Signature of Witness

\_\_\_\_\_  
Signature of First Party

JUNE KEY  
Print name of Witness

\_\_\_\_\_  
Print name of First Party

State of INDIANA  
County of LAKE

On APRIL 21, 2000 before me, JANET L CLARK personally known to me (or proved to me on the basis of satisfactory evidence) to be the person(s) whose name(s) is/are subscribed to the within instrument and acknowledged to me that he/she/they executed the same in his/her/their authorized capacity(ies), and that by his/her/their signature(s) on the instrument the person(s), or the entity upon behalf of which the person(s) acted, executed the instrument.  
WITNESS my hand and official seal.

Effie M. Rose  
Signature of Notary  
EXP. DATE: 06-12-07

Affiant Known Produced ID  
Type of ID INDIAN (Seal)

State of INDIANA  
County of LAKE  
On APRIL 21, 2000 before me, JANET L CLARK personally known to me (or proved to me on the basis of satisfactory evidence) to be the person(s) whose name(s) is/are subscribed to the within instrument and acknowledged to me that he/she/they executed the same in his/her/their authorized capacity(ies), and that by his/her/their signature(s) on the instrument the person(s), or the entity upon behalf of which the person(s) acted, executed the instrument.  
WITNESS my hand and official seal.

Effie M. Rose  
Signature of Notary  
EXP. DATE: 06-12-07

Affiant Known Produced ID  
Type of ID INDIAN (Seal)

\_\_\_\_\_  
Signature of Preparer

\_\_\_\_\_  
Print Name of Preparer

\_\_\_\_\_  
Address of Preparer

(2)

If your state requires 8 1/2" x 11" forms, cut off the bottom of this page at the dotted line.