

STATE OF INDIANA  
LAKE COUNTY  
FILED RECORD

2000 027464

2000 APR 24 - 11:32

MARION W. CARTER  
RECORDER

**INDIANA**

COUNTY OF LAKE

POOL NO. 00390801CD

LOAN NO. 0020963880 (680150)

PREPARED BY SECURITY CONNECTIONS, INC.  
WHEN RECORDED MAIL TO:  
Security Connections, Inc.  
620 S. Woodruff Ave.  
ATTN: KARLEEN PARKER  
Idaho Falls, ID 83401

**ASSIGNMENT OF MORTGAGE**

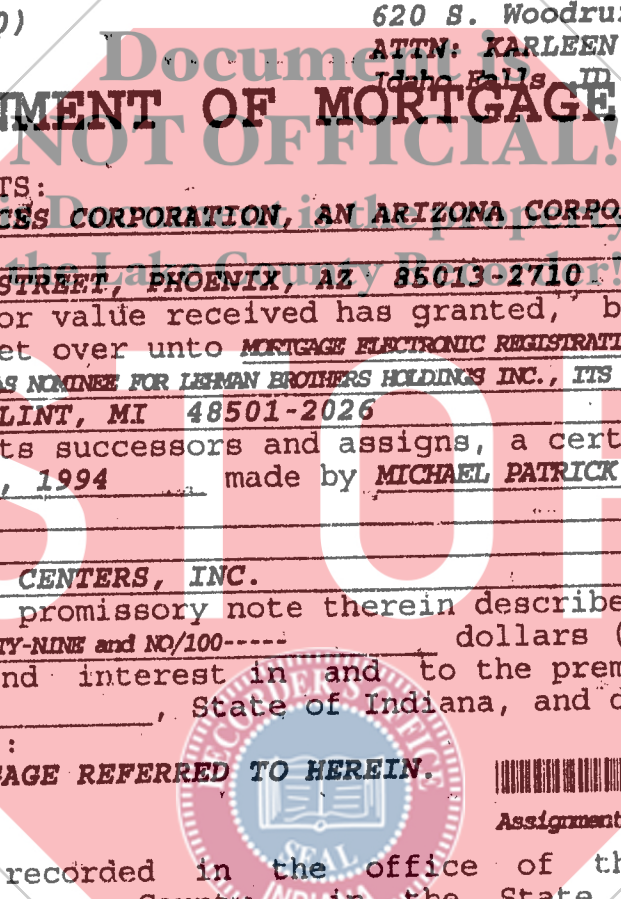

ALL MEN BY THESE PRESENTS:  
That MATRIX FINANCIAL SERVICES CORPORATION, AN ARIZONA CORPORATION

located at 201 W. COOLIDGE STREET, PHOENIX, AZ 85013-2710  
party of the first part, for value received has granted, bargained, sold,  
assigned, transferred and set over unto MORTGAGE ELECTRONIC REGISTRATION SYSTEMS, A DELAWARE CORPORATION, ITS SUCCESSORS AND ASSIGNS AS NOMINEE FOR LEHMAN BROTHERS HOLDINGS INC., ITS SUCCESSOR AND ASSIGNS

located at P.O. BOX 2026, FLINT, MI 48501-2026  
party of the second part, its successors and assigns, a certain indenture of  
mortgage dated SEPTEMBER 20, 1994 made by MICHAEL PATRICK KING AND CAROLYN KING, HUSBAND AND WIFE

to MOUNTAIN STATES MORTGAGE CENTERS, INC. as Beneficiary  
securing the payment of one promissory note therein described for the sum of  
TWENTY-THREE THOUSAND EIGHT HUNDRED FIFTY-NINE and NO/100----- dollars (\$23,859.00)  
and all its right, title and interest in and to the premises situated in  
county of LAKE, State of Indiana, and described in said  
mortgage as follows, to wit:  
**AS DESCRIBED ON SAID MORTGAGE REFERRED TO HEREIN.**

Assignment-Interv.-Recorded

which said mortgage is recorded in the office of the recorder of  
LAKE County, INDI in the State of Indiana in  
Book/Drawer \_\_\_\_\_ at Page/Card \_\_\_\_\_ Document or  
Instrument # 94069146 and Microfilm# \_\_\_\_\_  
together with the said note therein described and the money due or to grow  
due thereon, with the interest:

MIN# 100025920000603140 MERS VRU PHONE #: 1-888-679-6377  
J=MF840.S.02062

Loan No.

12.00  
36673

Loan No. 0020963880 (680150)

TO HAVE AND TO HOLD the same unto the said party of the second part, its successors and assigns, forever, subject only to the provisions in the said indenture of mortgage contained.

IN WITNESS WHEREOF, the party of the first part has caused this instrument to be executed in its name by DIANA ANDERSON and attested by KELLEE COX

This 7th day of APRIL 2000, but effective the 4th day of APRIL 2000

ATTEST:

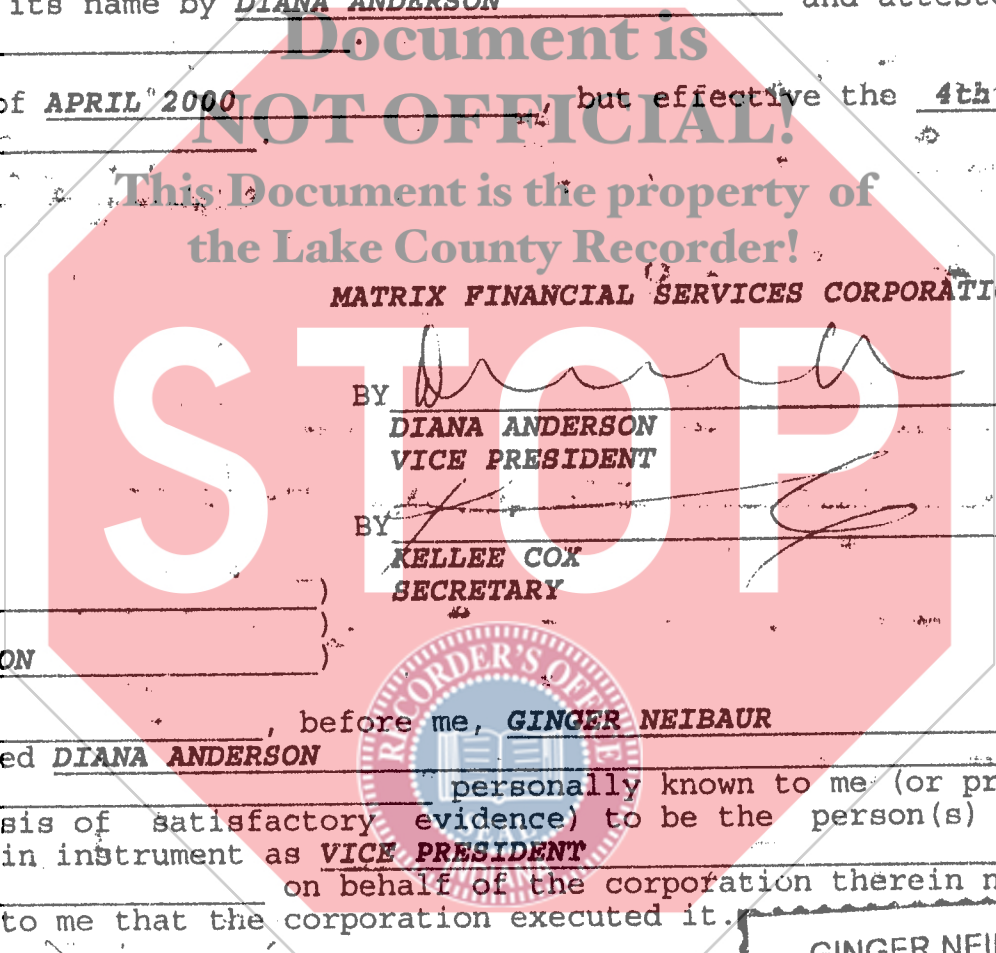

BY [Signature]  
DIANA ANDERSON  
VICE PRESIDENT

BY [Signature]  
KELLEE COX  
SECRETARY

STATE OF IDAHO

COUNTY OF JEFFERSON

On APRIL 7, 2000, before me, GINGER NEIBAUR and personally appeared DIANA ANDERSON and KELLEE COX personally known to me (or proved to me on the basis of satisfactory evidence) to be the person(s) who executed the within instrument as VICE PRESIDENT and SECRETARY on behalf of the corporation therein named and acknowledged to me that the corporation executed it.

[Signature]  
GINGER NEIBAUR (COMMISSION EXP. 06-22-04)  
Notary Public

GINGER NEIBAUR  
☆ NOTARY PUBLIC ☆  
STATE OF IDAHO

C=S.154.0015  
P=S.025.005

MIN# 100025920000603140 MERS VRU PHONE #: 1-888-679-6377  
J=MF840.S.02062