

4
4

**PARTIAL
RELEASE OF MORTGAGE**

66882

For Value Received, the undersigned hereby releases the real estate described in Attachment A, in Deep River Pointe, Phase I, as shown in Plat Book 80, Page 96, and amended in Plat Book 82, Page 16, Lake County, Indiana from the mortgage lien created by the Mortgage executed by Schema Development Company LLC, an Indiana limited liability company, to Pioneer Computer and Leasing Equipment Company, Inc., a Colorado corporation (the "Original Mortgage"), dated February 2, 1998, and recorded on March 25, 1998, as Instrument No. 98020031, in the Office of the Recorder of Lake County, Indiana.

In Witness Whereof, Pioneer Computer & Equipment Leasing Company, Inc., has caused this Partial Release of Mortgage to be executed this 29th day of November, 1999, by its duly authorized Vice President.

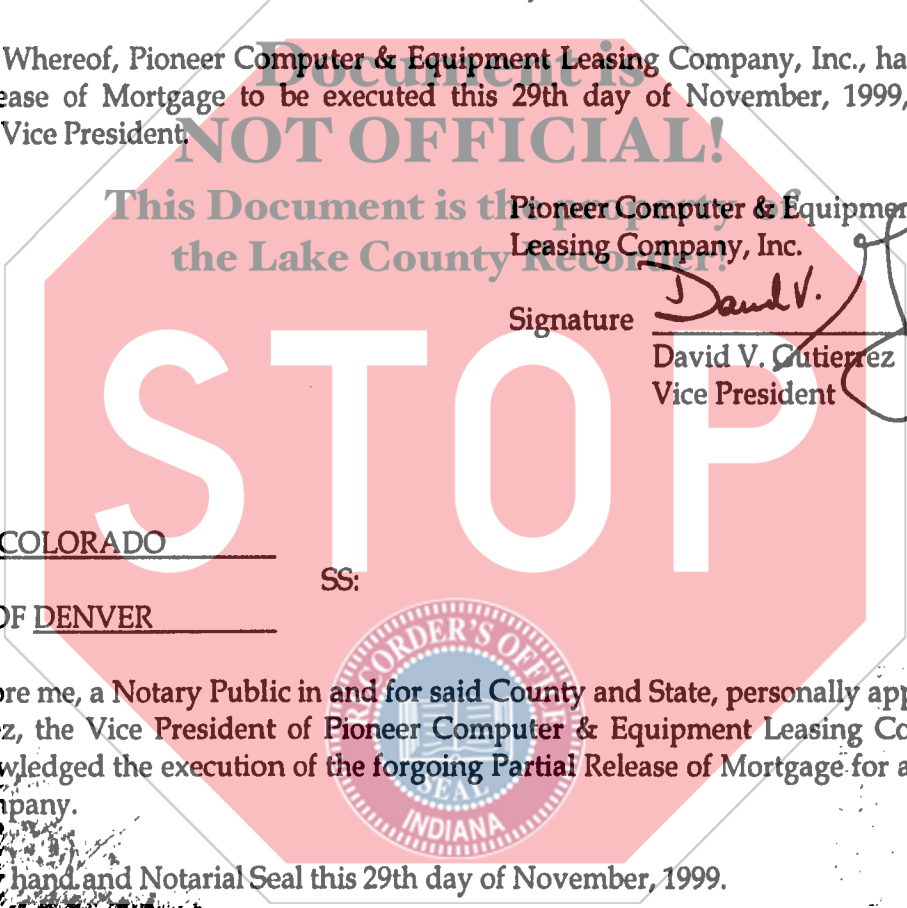

Pioneer Computer & Equipment
Leasing Company, Inc.

Signature

David V. Gutierrez
David V. Gutierrez
Vice President

2000
025426

STATE OF COLORADO

SS:

COUNTY OF DENVER

Before me, a Notary Public in and for said County and State, personally appeared David V. Gutierrez, the Vice President of Pioneer Computer & Equipment Leasing Company, Inc. who acknowledged the execution of the forgoing Partial Release of Mortgage for and on behalf of said Company.

Witness my hand and Notarial Seal this 29th day of November, 1999.

My Commission Expires 1/29/2002

Signature: *Della K. Moore*

Printed: Della K. Moore

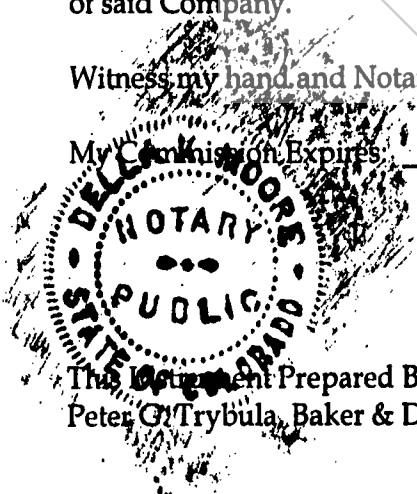

The Instrument Prepared By:

Peter G. Trybula, Baker & Daniels, 205 W. Jefferson Blvd., Suite 250, South Bend, IN 46601

LAWYERS TITLE INS. CORP.
ONE PROFESSIONAL CENTER
SUITE 215
CROWN POINT, IN 46307

1700
0011
DS

- Lake County, Indiana
- Lot 48 Deep River Pointe, Phase I, as shown in Plat Book 80, Page 96, and amended in Plat Book 82, Page 16, Lake County, Indiana
- Lot 49 Deep River Pointe, Phase I, as shown in Plat Book 80, Page 96, and amended in Plat Book 82, Page 16, Lake County, Indiana
- Lot 50 Deep River Pointe, Phase I, as shown in Plat Book 80, Page 96, and amended in Plat Book 82, Page 16, Lake County, Indiana
- Lot 51 Deep River Pointe, Phase I, as shown in Plat Book 80, Page 96, and amended in Plat Book 82, Page 16, Lake County, Indiana
- Lot 52 Deep River Pointe, Phase I, as shown in Plat Book 80, Page 96, and amended in Plat Book 82, Page 16, Lake County, Indiana
- Lot 54 Deep River Pointe, Phase I, as shown in Plat Book 80, Page 96, and amended in Plat Book 82, Page 16, Lake County, Indiana
- Lot 55 Deep River Pointe, Phase I, as shown in Plat Book 80, Page 96, and amended in Plat Book 82, Page 16, Lake County, Indiana
- Lot 56 Deep River Pointe, Phase I, as shown in Plat Book 80, Page 96, and amended in Plat Book 82, Page 16, Lake County, Indiana
- Lot 57 Deep River Pointe, Phase I, as shown in Plat Book 80, Page 96, and amended in Plat Book 82, Page 16, Lake County, Indiana
- Lot 58 Deep River Pointe, Phase I, as shown in Plat Book 80, Page 96, and amended in Plat Book 82, Page 16, Lake County, Indiana
- Lot 59 Deep River Pointe, Phase I, as shown in Plat Book 80, Page 96, and amended in Plat Book 82, Page 16, Lake County, Indiana
- Lot 60 Deep River Pointe, Phase I, as shown in Plat Book 80, Page 96, and amended in Plat Book 82, Page 16, Lake County, Indiana
- Lot 61 Deep River Pointe, Phase I, as shown in Plat Book 80, Page 96, and amended in Plat Book 82, Page 16, Lake County, Indiana
- Lot 63 Deep River Pointe, Phase I, as shown in Plat Book 80, Page 96, and amended in Plat Book 82, Page 16, Lake County, Indiana
- Lot 67 Deep River Pointe, Phase I, as shown in Plat Book 80, Page 96, and amended in Plat Book 82, Page 16, Lake County, Indiana
- Lot 68 Deep River Pointe, Phase I, as shown in Plat Book 80, Page 96, and amended in Plat Book 82, Page 16, Lake County, Indiana
- Lot 69 Deep River Pointe, Phase I, as shown in Plat Book 80, Page 96, and amended in Plat Book 82, Page 16, Lake County, Indiana
- Lot 82 Deep River Pointe, Phase I, as shown in Plat Book 80, Page 96, and amended in Plat Book 82, Page 16, Lake County, Indiana
- Lot 83 Deep River Pointe, Phase I, as shown in Plat Book 80, Page 96, and amended in Plat Book 82, Page 16, Lake County, Indiana
- Lot 84 Deep River Pointe, Phase I, as shown in Plat Book 80, Page 96, and amended in Plat Book 82, Page 16, Lake County, Indiana
- Lot 85 Deep River Pointe, Phase I, as shown in Plat Book 80, Page 96, and amended in Plat Book 82, Page 16, Lake County, Indiana
- Lot 86 Deep River Pointe, Phase I, as shown in Plat Book 80, Page 96, and amended in Plat Book 82, Page 16, Lake County, Indiana
- Lot 87 Deep River Pointe, Phase I, as shown in Plat Book 80, Page 96, and amended in Plat Book 82, Page 16, Lake County, Indiana
- Lot 88 Deep River Pointe, Phase I, as shown in Plat Book 80, Page 96, and amended in Plat Book 82, Page 16, Lake County, Indiana
- Lot 89 Deep River Pointe, Phase I, as shown in Plat Book 80, Page 96, and amended in Plat Book 82, Page 16, Lake County, Indiana
- Lot 90 Deep River Pointe, Phase I, as shown in Plat Book 80, Page 96, and amended in Plat Book 82, Page 16, Lake County, Indiana

Document is
NOT OFFICIAL!
This Document is the property of
the Lake County Recorder!

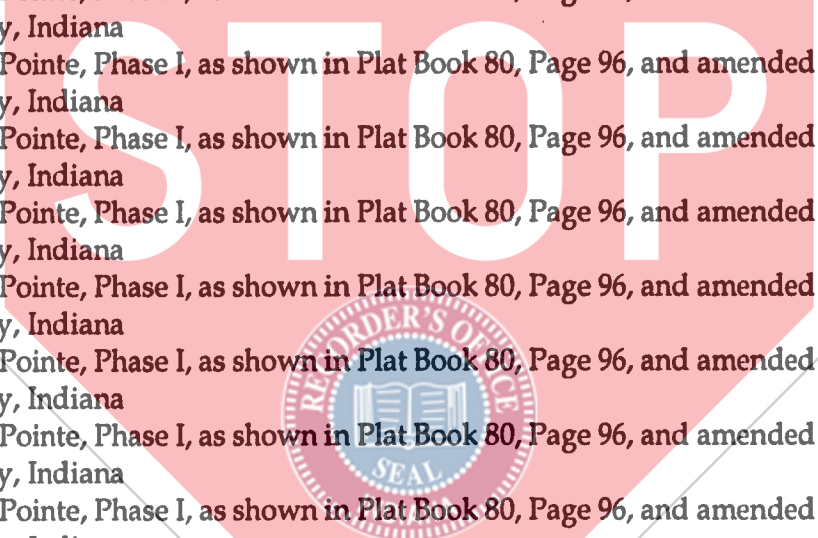

- Lake County, Indiana
- Lot 91 Deep River Pointe, Phase I, as shown in Plat Book 80, Page 96, and amended in Plat Book 82, Page 16,
Lake County, Indiana
- Lot 92 Deep River Pointe, Phase I, as shown in Plat Book 80, Page 96, and amended in Plat Book 82, Page 16,
Lake County, Indiana
- Lot 93 Deep River Pointe, Phase I, as shown in Plat Book 80, Page 96, and amended in Plat Book 82, Page 16,
Lake County, Indiana
- Lot 94 Deep River Pointe, Phase I, as shown in Plat Book 80, Page 96, and amended in Plat Book 82, Page 16,
Lake County, Indiana
- Lot 95 Deep River Pointe, Phase I, as shown in Plat Book 80, Page 96, and amended in Plat Book 82, Page 16,
Lake County, Indiana
- Lot 96 Deep River Pointe, Phase I, as shown in Plat Book 80, Page 96, and amended in Plat Book 82, Page 16,
Lake County, Indiana
- Lot 97 Deep River Pointe, Phase I, as shown in Plat Book 80, Page 96, and amended in Plat Book 82, Page 16,
Lake County, Indiana
- Lot 98 Deep River Pointe, Phase I, as shown in Plat Book 80, Page 96, and amended in Plat Book 82, Page 16,
Lake County, Indiana
- Lot 99 Deep River Pointe, Phase I, as shown in Plat Book 80, Page 96, and amended in Plat Book 82, Page 16,
Lake County, Indiana
- Lot 100 Deep River Pointe, Phase I, as shown in Plat Book 80, Page 96, and amended in Plat Book 82, Page 16,
Lake County, Indiana
- Lot 101 Deep River Pointe, Phase I, as shown in Plat Book 80, Page 96, and amended in Plat Book 82, Page 16,
Lake County, Indiana
- Lot 102 Deep River Pointe, Phase I, as shown in Plat Book 80, Page 96, and amended in Plat Book 82, Page 16,
Lake County, Indiana
- Lot 103 Deep River Pointe, Phase I, as shown in Plat Book 80, Page 96, and amended in Plat Book 82, Page 16,
Lake County, Indiana
- Lot 104 Deep River Pointe, Phase I, as shown in Plat Book 80, Page 96, and amended in Plat Book 82, Page 16,
Lake County, Indiana
- Lot 105 Deep River Pointe, Phase I, as shown in Plat Book 80, Page 96, and amended in Plat Book 82, Page 16,
Lake County, Indiana
- Lot 106 Deep River Pointe, Phase I, as shown in Plat Book 80, Page 96, and amended in Plat Book 82, Page 16,
Lake County, Indiana
- Lot 107 Deep River Pointe, Phase I, as shown in Plat Book 80, Page 96, and amended in Plat Book 82, Page 16,
Lake County, Indiana

