

STATE OF INDIANA
LAKE COUNTY
FILED RECORDED

2000 024762

2000 APR 12 AM 8:57

NOTARY PUBLIC
RECORDED

①

Parcel No. X(25) 45-805-34

QUITCLAIM DEED

Order No. 920001106 -14

THIS INDENTURE WITNESSETH, That BRIAN D. WILSON AND PEGGY M. WILSON, HUSBAND AND WIFE

(Grantor)

of Lake County, in the State of INDIANA QUITCLAIM(S) to
BEAR, LLC

(Grantee)

of Lake County, in the State of INDIANA, for the sum of
TEN AND 00/100 Dollars (\$ 10.00)

and other valuable consideration, the receipt and sufficiency of which is hereby acknowledged, the following described real estate in Lake County, State of Indiana:

LOT 34 IN BLOCK 4 IN KELLEY-SEMME BOULEVARD HEIGHTS ADDITION TO GARY, AS PER PLAT THEREOF, RECORDED IN PLAT BOOK 9 PAGE 23, IN THE OFFICE OF THE RECORDER OF LAKE COUNTY, INDIANA.

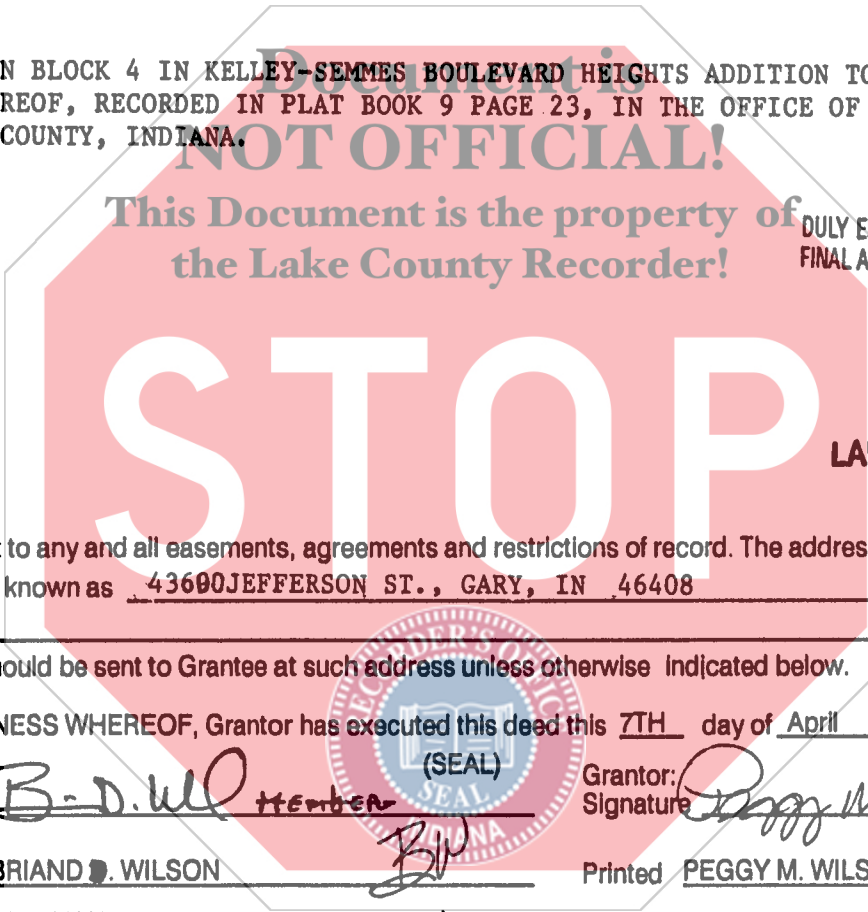

Subject to any and all easements, agreements and restrictions of record. The address of such real estate is commonly known as 43600 JEFFERSON ST., GARY, IN 46408

Tax bills should be sent to Grantee at such address unless otherwise indicated below.

IN WITNESS WHEREOF, Grantor has executed this deed this 7TH day of April, 2000

Grantor: B-D. Wilson (SEAL) Member
Signature

Grantor: Peggy M. Wilson (SEAL) Member
Signature

Printed BRIAN D. WILSON

Printed PEGGY M. WILSON

STATE OF INDIANA
COUNTY OF Lake

} SS: ACKNOWLEDGEMENT

Before me, a Notary Public in and for said County and State, personally appeared BRIAN D. WILSON AND PEGGY M. WILSON, HUSBAND AND WIFE who acknowledged the execution of the foregoing Quitclaim Deed, and who, having been duly sworn, stated that any representation therein contained are true.

Witness my hand and Notarial Seal this 7th day of April, 2000

My commission expires:
DECEMBER 8, 2007

Signature Jacalyn Smith

Printed JACALYN L SMITH, Notary Name

Resident of LAKE County, Indiana.

This instrument prepared by ATTY. THOMAS K. HOFFMAN 7731-45

Return deed to 224 W. 43RD AVE. -PURCHASE PARCEL I, Gary, IN 46408

Send tax bills to 224 W. 43RD AVE. -PURCHASE PARCEL I, Gary, IN 46408

00642

14-
te
m