

2

STATE OF INDIANA  
LAKE COUNTY  
MORTGAGE / DEED OF TRUST ASSIGNMENT RECORD

6904105209

2000 021944

2000 MAR 30 PM 2:59

For value received, Conseco Bank, Inc., a corporation organized and existing under the laws of the State of Utah, hereby assigns to Green Tree Financial Servicing Corporation, its successors and assigns, all right, title, and interest in and to a certain Mortgage / Deed of Trust dated June 23, 1999, made by Bryon K. Goines and and Meshelle L. Goines, husband and wife as tenants by the entireties, as mortgagor(s), to Conseco Bank, Inc., as mortgagee, as filed in the offices of the County Recorder, county of Lake, State of Indiana, together with the Note secured by such mortgage / deed of trust on the following described property situated in the above county and state, to wit:

See attached exhibit A for legal description.

Date this day of August 26, 1999.

Mtg. Rec. Bk \_\_\_\_\_ Pg \_\_\_\_\_

Instrument # 99054934

Document is NOT OFFICIAL!

Conseco Bank, Inc.

This Document is the property of the Lake County Recorder!

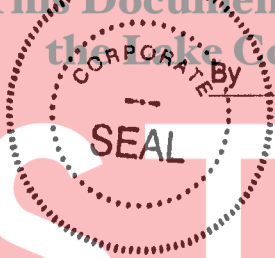

*Julie Larson*  
Julie Larson, Authorized Agent

State of Arizona

) ss

County of Maricopa

As a Notary Public for the State of Arizona, I hereby certify that Julie Larson personally came before me on this date and acknowledged that she is an Authorized Agent of Conseco Bank, Inc., a Utah corporation, and that by authority duly given and as the act of the corporation, the foregoing instrument was signed in its name by her.

Witness my hand and official seal dated this day August 26, 1999.



*[Signature]*  
Notary Public

(Notary Seal)

My Commission Expires:

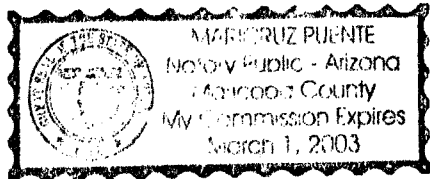

[WHEN RECORDED RETURN TO]  
NTC ATTN:DARRELL COLON  
101 N. BRAND BLVD., SUITE #1800  
GLENDALE, CALIFORNIA 91203  
GREENTREE LOAN: 6904105209



13.00  
E.P.  
520960

**EXHIBIT A**

**Legal Description:**

Situated in Lake County, in the State of Indiana:

Lots 22 and 23 in Block 3 in Fairmont Park Addition to Gary, as per plat thereof, recorded in Plat Book 10, page 21, in the Office of the Recorder of Lake County, Indiana.

Commonly known as: 2164 Ellsworth Pl., Gary, IN 46408

Parcel ID: 25-43-0003-0022

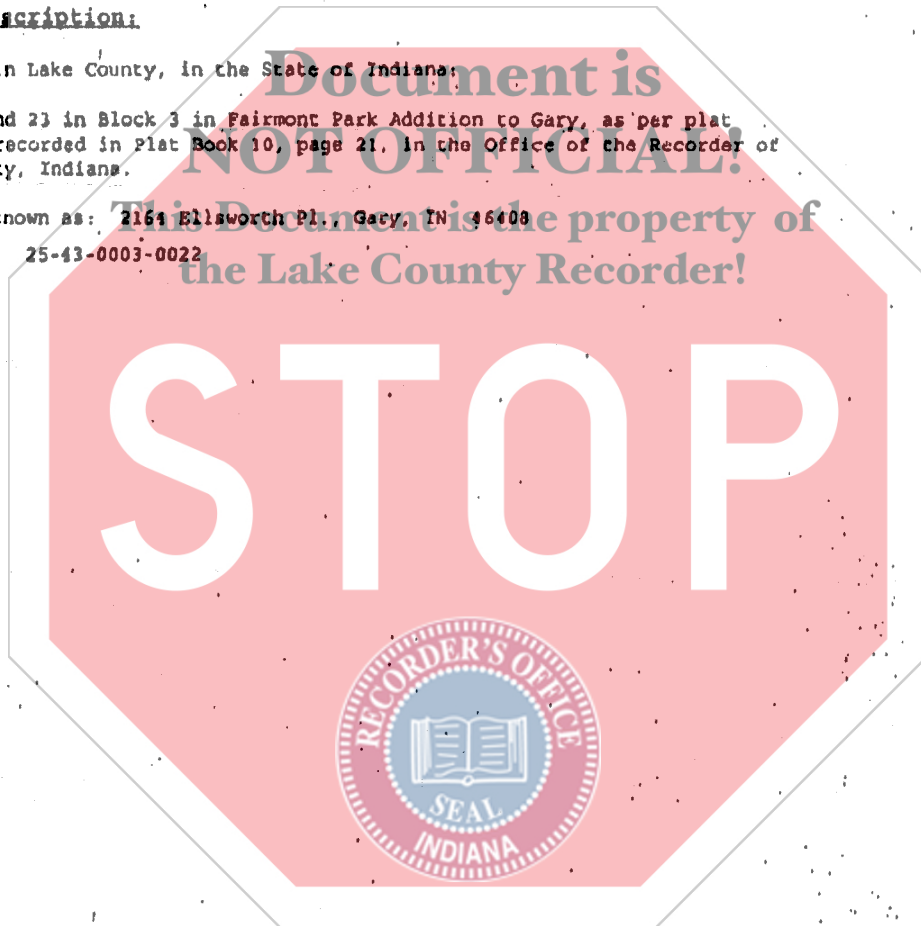

B.K.G.  
M.A.L.