

88

105

STATE OF INDIANA  
LAKE COUNTY  
FILED

2000 021475 ASSIGNMENT

2000 MAR 29 AM 10:01

KNOW ALL MEN BY THESE PRESENTS:

RECORDER'S OFFICE  
LAKE COUNTY  
INDIANA

THAT, THE TEXAS PIPE LINE COMPANY, a Texas Corporation, with offices at 9700 Richmond Avenue, Houston, Texas 77042, hereinafter referred to as "Assignor", for TEN AND NO/100 DOLLARS (\$10.00) and other good and valuable consideration to it in hand paid by MARATHON PIPE LINE COMPANY, a Delaware Corporation, with offices at 231 East Lincoln Street, Findlay, Ohio 45840, hereinafter referred to as "Assignee", the receipt and sufficiency of which is hereby acknowledged, and subject to that certain Agreement of Sale and Purchase dated December 18, 1984, between Assignor and Assignee, has GRANTED, SOLD, CONVEYED, TRANSFERRED and ASSIGNED, and by these presents does GRANT, SELL, CONVEY, TRANSFER and ASSIGN unto Assignee all of Assignor's right, title and interest in and to the right-of-way agreements, easements, grants, leases, licenses, franchises or permits which are more fully described and set forth in Exhibit "A" attached hereto and made a part hereof, all of which affect lands situated in Lake County, Indiana, and which relate to the Lockport to East Chicago Six Inch Main Line, together with all prescriptive rights, if any, owned by Assignor in the said lands in Lake County, Indiana, traversed by said pipeline insofar as such prescriptive rights apply to said pipeline.

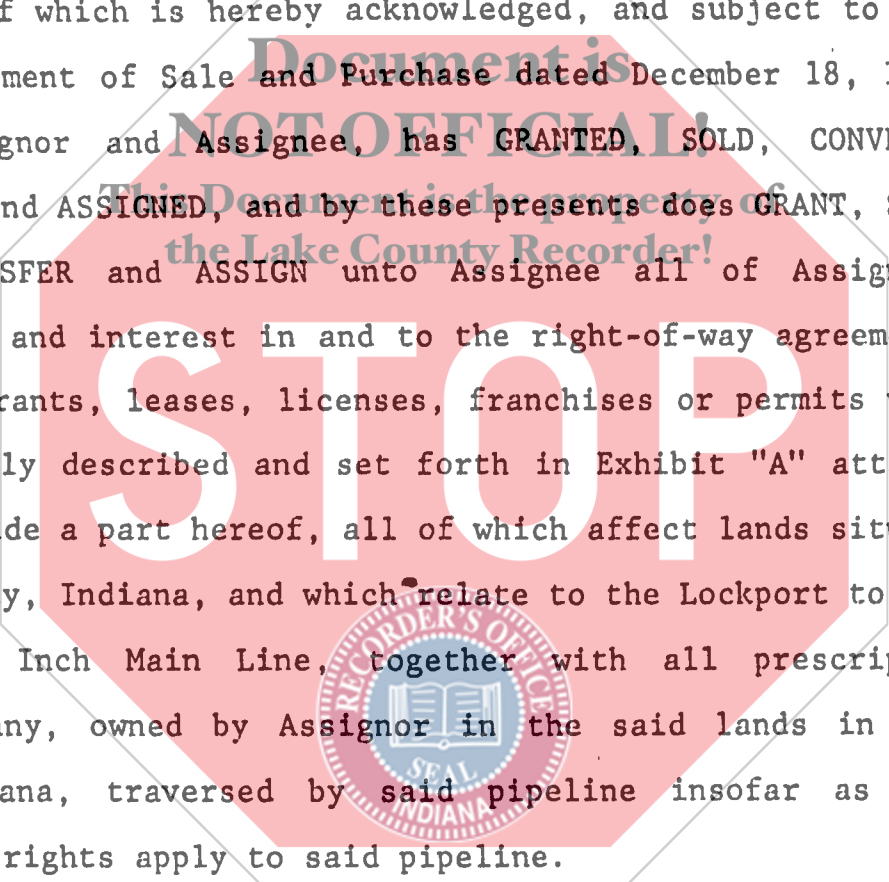

TO HAVE AND TO HOLD the above described premises unto Assignee, its successors and assigns forever.

Assignor makes no warranty of title, express or implied, with respect to the above described premises except as expressly provided in the above described Agreement of Sale and Purchase.

By the acceptance of this Assignment, Assignee does hereby assume and agree to perform the obligations of Assignor under and pursuant to the right-of-way agreements, easements,

EQUILON ENTERPRISES LLC  
PO BOX 2648  
HOUSTON TX 77252-9699

27.00  
302056

25X

grants, leases, licenses, franchises or permits assigned herein, from and after 7:00 a.m. on the date hereof, and the obligations thereunder shall be binding upon Assignee, its successors and assigns.

EXECUTED this the 12<sup>th</sup> day of February, 1985.

ATTEST:

J. H. Lewis  
Asst. Secretary  
(SEAL)

THE TEXAS PIPE LINE COMPANY

By: R. W. Booksh  
R. W. Booksh

Title: President

ATTEST:

C. D. Clay  
Asst. Secretary  
(SEAL)

MARATHON PIPE LINE COMPANY

By: C. D. Clay

Title: President  
This Document is the property of  
the Lake County Recorder



(ACKNOWLEDGMENTS ATTACHED)

APPROVED { As to Terms... CC  
As to Form... CDM  
As to Description... WKL



CORPORATE ACKNOWLEDGMENTS

STATE OF TEXAS           §  
  §  
COUNTY OF HARRIS       §

BEFORE ME, the undersigned authority, on this day personally appeared R. W. Booksh, President of THE TEXAS PIPE LINE COMPANY, a corporation, known to me to be the person and officer whose name is subscribed to the foregoing instrument and acknowledged to me that he executed the same as the act and deed of said corporation for the purposes and consideration therein expressed, and in the capacity therein stated.

GIVEN under my hand and seal of office this the 12<sup>th</sup> day of February, 1985.

My Commission Expires:  
8-12-87  
(SEAL)

Natalia Gordon  
Notary Public in and for  
Harris County, Texas

STATE OF TEXAS  
COUNTY OF HARRIS

BEFORE ME, the undersigned authority, on this day personally appeared C. D. Clay, President of MARATHON PIPE LINE COMPANY, a corporation, known to me to be the person and officer whose name is subscribed to the foregoing instrument and acknowledged to me that he executed the same as the act and deed of said corporation for the purposes and consideration therein expressed, and in the capacity therein stated.

GIVEN under my hand and seal of office this the 12<sup>th</sup> day of February, 1985.

My Commission Expires:  
8-12-87  
(SEAL)

Natalia Gordon  
Notary Public in and for  
Harris County, Texas

EXHIBIT "A"

FOLLOWING ARE RIGHT-OF-WAY AGREEMENTS, EASEMENTS, GRANTS, LEASES, LICENSES, FRANCHISES OR PERMITS OF WHICH THE TEXAS PIPE LINE COMPANY OR ITS PREDECESSORS IN TITLE IS THE GRANTEE, AND COVERING PROPERTY IN LAKE COUNTY, INDIANA.

<u>R/W #</u>	<u>GRANTOR</u>	<u>LAND DESCRIPTION</u>	<u>DATE OF INSTRUMENT</u>	<u>DEED RECORDS LAKE CO., IN VOLUME &amp; PAGE</u>	
1	Pullman-Standard Car Manufacturing Company	That part lying East of the Sixty-six (66) foot right of way of the Indiana Harbor Belt Railroad Company, (as conveyed to the Hammond and Blue Island Railway Company by deed dated November 6, 1895, and recorded on March 3, 1896, in Book 77, Page 280) of the West Twenty-three (23) acres of the North half of the Fractional Southwest quarter of Fractional Section Twenty-four (24), Township Thirty-seven (37) North, Range Ten (10) West of the Second Principal Meridian; excepting therefrom that portion thereof which was conveyed by Standard Steel Car Corporation to W. J. Holliday and Company by deed dated August 17, 1931, and recorded in the office of the Recorder of Deeds, of Lake County, Indiana, in Book 483, page 480. The center line of easement along which said pipe line shall be laid on said premises is described as: Entering said premises of Owner from the East at a point on the West boundary line of Victoria Avenue five (5) feet South of the East and West center line of said Fractional Section 24, Township 37 North, Range 10 West of the second Principal Meridian and thence continuing Westwardly along a line parallel with and approximately five (5) feet South of the said East and West center line of Fractional Section 24, Township 37 North, Range 10 West of the Second Principal Meridian to a point on the Eastern boundary line of the sixty-six (66) foot right of way of the Indiana Harbor Belt Railroad Company, at which point said pipe line leaves the Owner's premises.	03-08-44	371	406

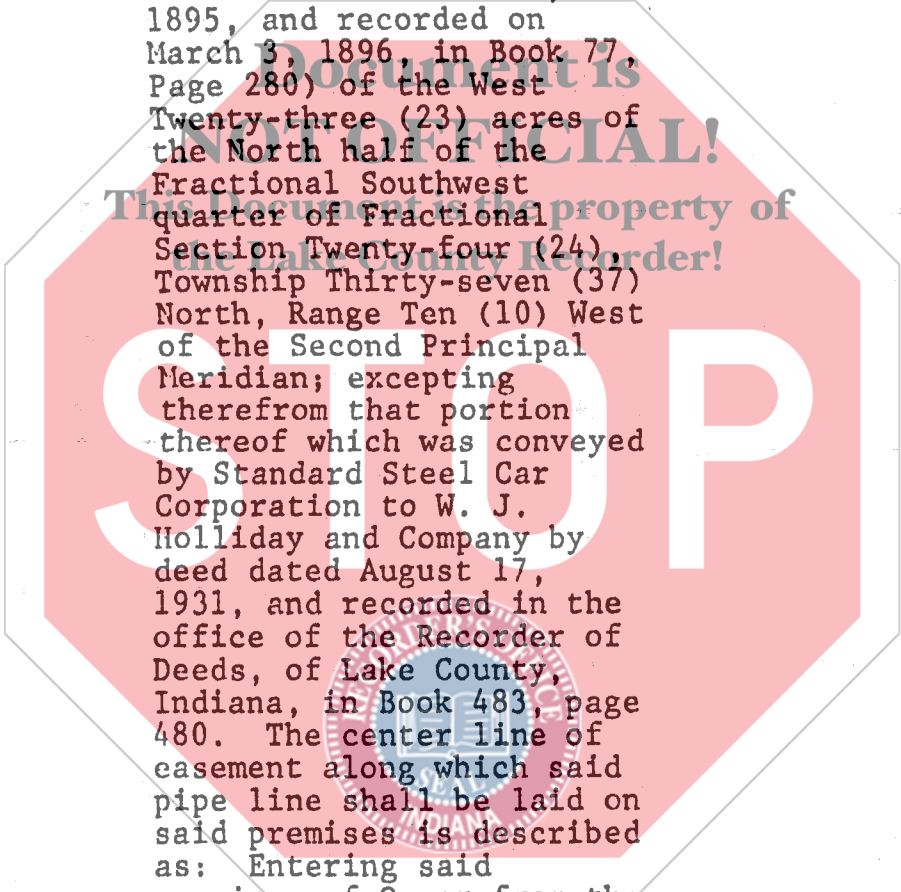

EXHIBIT "A"

<u>R/W#</u>	<u>GRANTOR</u>	<u>LAND DESCRIPTION</u>	<u>DATE OF INSTRUMENT</u>	<u>DEED RECORDS LAKE CO., IN VOLUME &amp; PAGE</u>
2	Maurice F. Holohan, Jr. and Mildred F. Holohan	That part of Government Lots 2 and 3 of fractional Section 24, Township 37 North, Range 10, West of the Second Principal Meridian, described as follows: Beginning at the point of intersection of the center line of Sheffield Avenue and the South line of said Lot 2; thence West along the said South Line and along the South Line of Lot 3 aforesaid a distance of 1415.77 feet to the intersection with a line parallel to and 759.83 feet Easterly of the West line of Lot 3 aforesaid; thence North along said parallel line a distance of 626.80 feet to its intersection with the Southerly line of the tract conveyed to the South Chicago and Southern Railroad Company by deed dated June 11, 1925 and recorded June 12, 1925, in book 352, page 246; thence Northeasterly along said Southerly line, a distance of 327.73 feet to the Southerly line of the right of way conveyed to the State Line and Indiana City Railway by deed dated February 20, 1895, and recorded May 3, 1895, in book 74, pages 84 to 90; thence Southeasterly along said South line of right-of-way 1221.99 feet to its intersection with the center line of Sheffield Avenue and thence Southwesterly along said center line of Sheffield Avenue, a distance of 383.16 feet to the place of beginning, in the City of Hammond, Lake County, Indiana, containing 17.108 acres, more or less, subject, however, to any legal highways or right of ways.	03-07-44	367 267
3	Chicago & Calumet District Transit Company, Inc.	That part of Lot 2 in Section 24, Township 37 North, Range 10 West, of the Second Principal Meridian in the City of Hammond, Lake County, Indiana, lying Easterly of the center line of Sheffield Avenue and Southwesterly of the right of way of the South Chicago & Southern Railroad Company, as	03-23-44	371 27



EXHIBIT "A"

<u>R/W#</u>	<u>GRANTOR</u>	<u>LAND DESCRIPTION</u>	<u>DATE OF INSTRUMENT</u>	<u>DEED RECORDS LAKE CO., IN VOLUME &amp; PAGE</u>
3	Chicago & Calumet District Transit Company, Inc. (Continued)	conveyed to the State Line & Indiana City Railway Company by deed dated February 20, 1985, and recorded May 3, 1895, in deed record 74, at pages 84 to 89, inclusive, containing 3.742 acres, more or less.		
4	Socony Mobil Oil Company, Inc.	N/2 of the S/2 of Sec. 19, T-37-N, R-9-W of the 2nd P.M.	07-03-61	
5	Socony Vacuum Oil Co., Inc.	Section 20, T-37-N, R-9-W of the 2nd P.M. and more particularly described as follows: Beginning at a point eight (8) feet North from the intersection of the East boundary line of Forsyth Avenue of the City of East Chicago, Indiana, commonly known as Indianapolis Boulevard, with the North boundary line of a strip of land owned by The Pennsylvania Railroad Company. Thence in an Easterly and Southerly direction a distance of 2870 feet more or less to the North boundary line of 141st Street of the City of East Chicago, Indiana. Thence East along the said 141st Street to the West boundary line of the Indiana Harbor Canal.	02-11-44	
6	Phillips Petroleum Company	Beginning at a point 10 feet North of the Southwest corner of said East Chicago Pipe Line Terminal property; thence Easterly, parallel to and 10 feet distant Northerly at right angles from the South property line of said East Chicago Pipe Line Terminal property 255 feet more or less; thence Northerly at right angles 195 feet more or less; thence Easterly parallel to and 5 feet distant Northerly at right angles from the South property line of said East Chicago Pipe Line Terminal property, being the North property line of the East Chicago City Fire Station property, a distance of 470 feet more or less to a point 10 feet distant Westerly at right angles	03-20-44	



EXHIBIT "A"

<u>R/W#</u>	<u>GRANTOR</u>	<u>LAND DESCRIPTION</u>	<u>DATE OF INSTRUMENT</u>	<u>DEED RECORDS LAKE CO., IN VOLUME &amp; PAGE</u>
6	Phillips Petroleum Company (Continued)	from the East property line of said East Chicago Pipe Line Terminal property; thence in a Northeasterly direction 630 feet more or less to a point 60 feet more or less Northwesterly at right angles from said East property line which is a curve; thence Northeasterly parallel to and 55 feet distant Northwesterly from the Southeasterly property line of said East Chicago Pipe Line Terminal property and tangent to said curve a distance of 850 feet more or less; thence with a curve to the left 565 feet more or less to a point 10 feet Westerly from the West side of the 16-foot roadway on said East Chicago Pipe Line Terminal property; thence in a Northerly direction 180 feet more or less to a point in the Northeasterly property line of said East Chicago Pipe Line Terminal property 360 feet more or less Northwesterly from the Northeast corner of said East Chicago Pipe Line Terminal property.		
		<u>FRANCHISES</u>		
7	Board of Public Works and Safety of the City of Hammond, Indiana	(1) Across Calumet Avenue at a point 1557 feet North from the Southeast corner of Section 24, Township 37 North, Range 10 West of the Second Principal Meridian. (2) In the Torrence Avenue Alley adjacent to and parallel with the West boundary line of The S. C. & S. Railway right-of-way from a point which is 1557 feet North and 490 feet West of the Southwest corner of Section 24, Township 37 North, Range 10 West of the Second Principal Meridian. Thence in a Northwesterly direction 10 feet from and parallel to the West boundary line of said alley to a point eight (8) feet South of the North boundary of 137th Street. Thence West eight (8) feet from and parallel to the North boundary line of 137th Street to the East	03-07-44	

EXHIBIT "A"

<u>R/W#</u>	<u>GRANTOR</u>	<u>LAND DESCRIPTION</u>	<u>DATE OF INSTRUMENT</u>	<u>DEED RECORDS LAKE CO., IN VOLUME &amp; PAGE</u>
7	Board of Public Works and Safety of the City of Hammond, Indiana (Continued)	boundary line of Sheffield Avenue. (3) Across Sheffield Avenue at a point where the center line of said avenue is 30 feet North from the East and West center line of Section 24, Township 37 North, Range 10 West of the Second Principal Meridian. (4) West along the North side of 137th Street extended (Rebecca Street) from the West boundary of Sheffield Avenue to the West corporate limit of the City of Hammond, Indiana.		
<b>PERMITS</b>				
8	State Highway Commission of Indiana	U.S. 41, 1557 feet North of SE corner of Sec. 24, T-37-N, R-10-W (Number 9435).	03-04-44	
9	State Highway Commission of Indiana	U.S. 12, 1426 feet North of the South Quarter corner of Sec. 20, T-37-N, R-9-W (Number 9434).	03-04-44	
10	State Highway Commission of Indiana	U.S. 12, on North side of Columbus Drive Bridge over South ford U.S. Ship Channel, East Chicago, Indiana (Number 9439).	03-04-44	
<b>RAILROAD PERMITS</b>				
11	Baltimore and Ohio Chicago Terminal Railroad Company	Sec. 20, T-37-N, R-9-W	03-10-44	
12	Elgin, Joliet & Eastern Railway Company	W/2 of Sec. 21, T-37-N, R-9-W	04-04-44	
13	Indiana Harbor Belt Railroad Company	Eight crossings as shown on Drawing No. 12824.	05-01-44	
14	The Pennsylvania Railroad Company	Sec. 20, T-37-N, R-9-W	04-04-44	
15	The New York Central Railroad Company	420 feet northwesterly of "Whiting Lead" at Chicago, Indiana.	03-30-44	

Assignor and Assignee acknowledge that the assignment of certain of the right-of-way agreements, easements, grants, leases, licenses, franchises, or permits described hereinabove may not be expressly assignable or are not assignable without the approval or consent of another party.

(END OF EXHIBIT "A")