

Chicago Title Insurance Company

2000 021411

STATE OF INDIANA
LAKE COUNTY
FILED FOR RECORD

2000 MAR 29 AM 9:52

MO. REC. CENTER

Parcel No. 43-307-34 UNIT 25

HQ20000504 LD

WARRANTY DEED

ORDER NO. 620000504

THIS INDENTURE WITNESSETH, That CHARLES E. GIBSON AND GWENDOLYN E. GIBSON, HUSBAND AND WIFE (Grantor)
of Lake County, in the State of INDIANA CONVEY(S) AND WARRANT(S)
to IDA B. COLEMAN (Grantee)

of Lake County, in the State of INDIANA, for the sum of ONE DOLLAR AND 00/100 Dollars (\$ 1.00)

and other valuable consideration, the receipt and sufficiency of which is hereby acknowledged, the following described real estate in Lake County, State of Indiana:

Lots 33 and 34 in Block F, in Grand Boulevard Subdivision, in the City of Gary, as per plat thereof, recorded in Plat Book 21, page 13, in the Office of the Recorder of Lake County, Indiana.

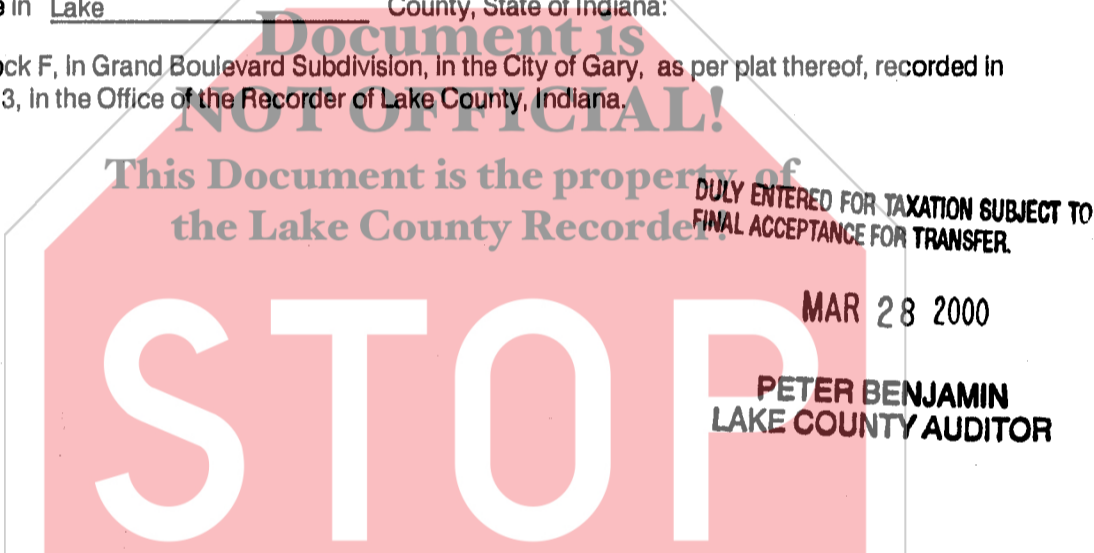

Subject to any and all easements, agreements and restrictions of record. The address of such real estate is commonly known as 6675 Hemlock Avenue, Gary, IN 46403

Tax bills should be sent to Grantee at such address unless otherwise indicated below.

IN WITNESS WHEREOF, Grantor has executed this deed this 24TH day of March, 2000.

Grantor: Charles E. Gibson (SEAL) Signature Grantor: Gwendolyn E. Gibson (SEAL) Signature

Printed CHARLES E. GIBSON Printed GWENDOLYN E. GIBSON

STATE OF INDIANA }
COUNTY OF Lake } SS: ACKNOWLEDGEMENT

Before me, a Notary Public in and for said County and State, personally appeared CHARLES E. GIBSON AND GWENDOLYN E. GIBSON, HUSBAND AND WIFE who acknowledge the execution of the foregoing Warranty Deed, and who, having been duly sworn, stated that any representation therein contained are true.
Witness my hand and Notarial Seal this 24TH day of March, 2000.

My commission expires: JULY 31, 2000

Signature Shirley R. Kasper
Printed SHIRLEY R. KASPER, Notary Name
Resident of LAKE County, Indiana.

This instrument prepared by CHARLES E. GIBSON

Return deed to 6675 Hemlock Avenue, Gary, IN 46403

Send tax bills to 6675 Hemlock Avenue, Gary, IN 46403

02140

14.00
/m
CF