

STATE OF INDIANA
LAKE COUNTY
FILED

2000 021292

2000 MAR 29 AM 9:11

RECORDER'S OFFICE
RECORDS

Parcel No. (26)32-216-25

WARRANTY DEED

ORDER NO. 920000613

THIS INDENTURE WITNESSETH, That Donald A. Shourek and Belinda Shourek,
husband and wife (Grantor)

of Lake County, in the State of INDIANA CONVEY(S) AND WARRANT(S)
to Juan Martinez and Maria L. Martinez, husband and wife
(Grantee)

of Lake County, in the State of INDIANA, for the sum of _____
TEN AND 00/100 Dollars (\$ 10.00)

and other valuable consideration, the receipt and sufficiency of which is hereby acknowledged, the following
described real estate in Lake County, State of Indiana:

Lot 25 in Block 3 in Cline Gardens Addition, in the City of Hammond, as per plat thereof, recorded in Plat Book 31
page 71, in the Office of the Recorder of Lake County, Indiana.

Subject to real estate taxes for 1999 payable in 2000, together with delinquency and penalty, if any, and all real
estate taxes due and payable thereafter.

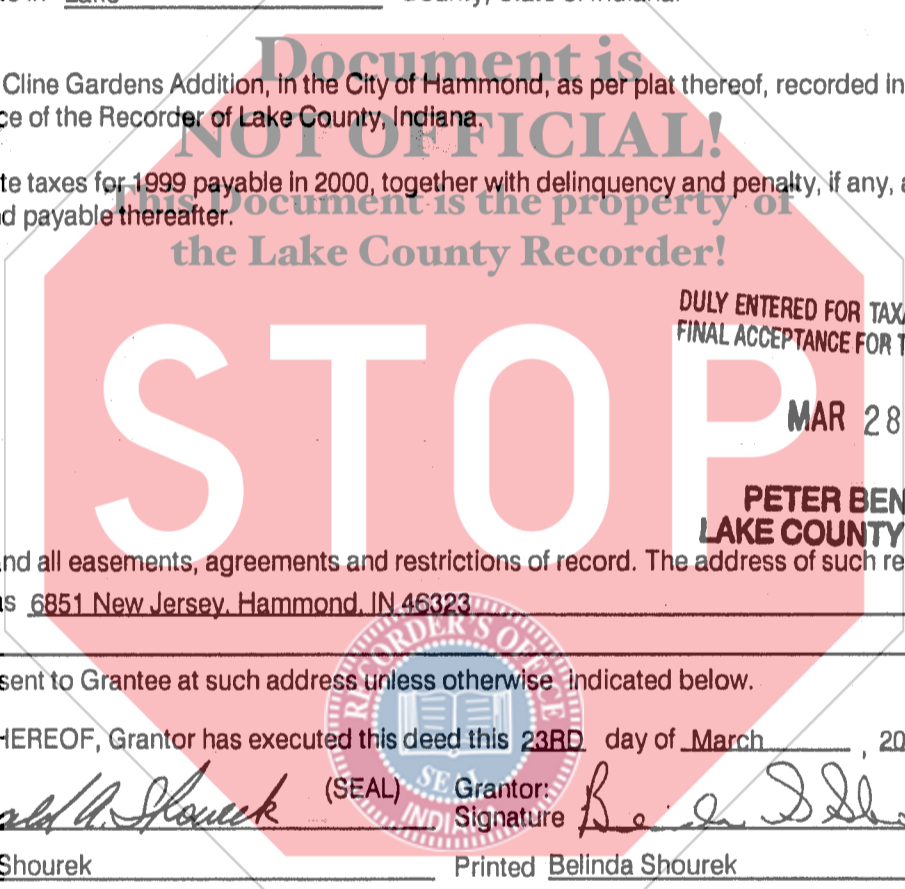

Subject to any and all easements, agreements and restrictions of record. The address of such real estate is
commonly known as 6851 New Jersey, Hammond, IN 46323

Tax bills should be sent to Grantee at such address unless otherwise indicated below.

IN WITNESS WHEREOF, Grantor has executed this deed this 23RD day of March, 2000.

Grantor: Donald A. Shourek (SEAL) Grantor: Belinda Shourek (SEAL)
Signature _____ Signature _____

Printed Donald A. Shourek Printed Belinda Shourek

STATE OF INDIANA }
COUNTY OF Lake } SS: ACKNOWLEDGEMENT

Before me, a Notary Public in and for said County and State, personally appeared _____
Donald A. Shourek and Belinda Shourek, husband and wife
who acknowledge the execution of the foregoing Warranty Deed, and who, having been duly sworn, stated that
any representation therein contained are true.

Witness my hand and Notarial Seal this 23RD day of March, 2000.

My commission expires:
OCTOBER 24, 2000

Signature Gloria Miller

Printed Gloria Miller, Notary Name

Resident of Lake County, Indiana.

This instrument prepared by Thomas K. Hoffman 7731-45

Return deed to 6851 New Jersey, Hammond, IN 46323

Send tax bills to 6851 New Jersey, Hammond, IN 46323

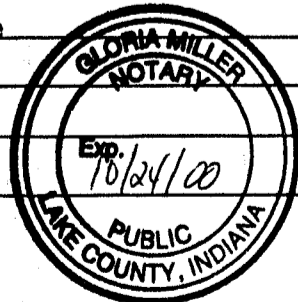

920000613 TIER 5A

14.00
E.P.
71

2113