

2000 019646

2000 MAR 22 PM 3:10

### SWORN STATEMENT OF INTENTION TO HOLD LIEN (NOTICE OF MECHANIC'S LIEN)

To: MAY J. RIGGS  
336 MARSHALL ST. GARY, IN. 46404  
Owner's Name and Address

State of Indiana, County of LAKE SS

The undersigned, being first duly sworn, makes this sworn statement of intention to hold a lien upon the property described below and says that:

1. The undersigned AMERI-CRAFT EXTERIORS INC.  
6139 W. TOUHY AVE. CHICAGO, IL 60646  
intends to hold a lien on land legally described as follows:

RESUB. GARY LAND CO'S. 6TH SUB.  
N. 24 1/2 FT. L. 29 BL. 15

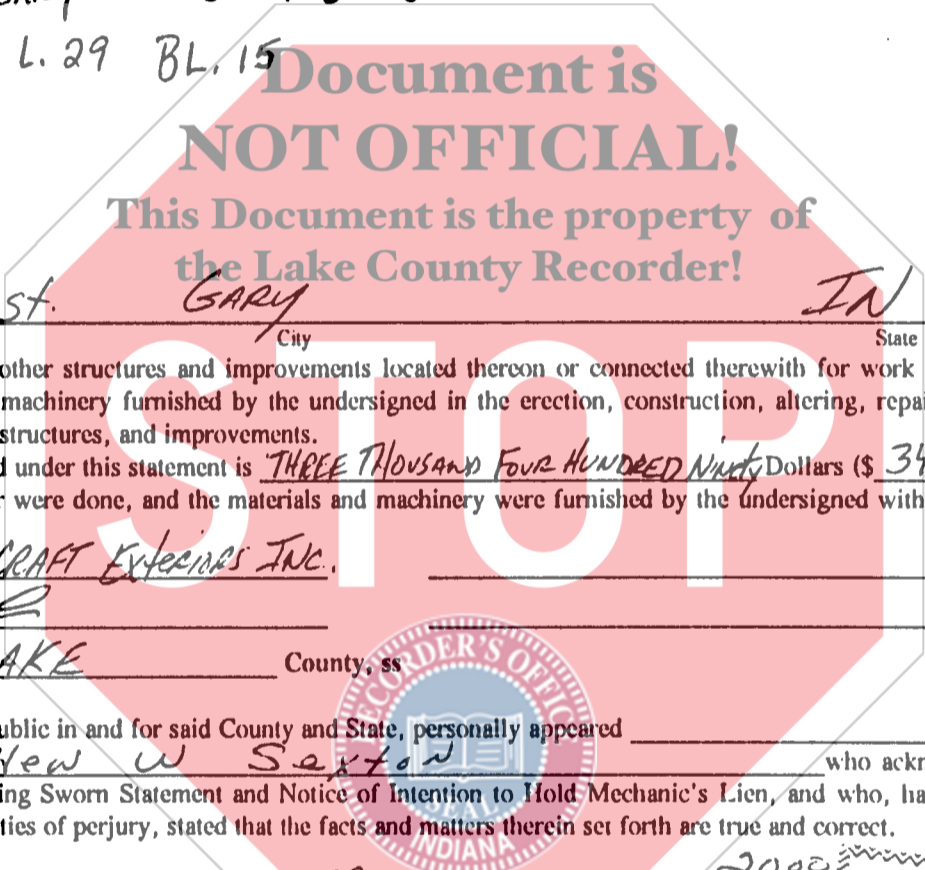

and commonly known as:

336 MARSHALL ST. GARY IN 46404  
Street City State

as well as on all building, other structures and improvements located thereon or connected therewith for work and labor done and/or materials and machinery furnished by the undersigned in the erection, construction, altering, repairing, and removing of said buildings, structures, and improvements.

2. The amount claimed under this statement is THREE THOUSAND FOUR HUNDRED NINETY Dollars (\$ 3490<sup>00</sup>).  
3. The work and labor were done, and the materials and machinery were furnished by the undersigned within the last sixty (60) days.

AMERI-CRAFT EXTERIORS INC.  
\* Matthew W. Sexton  
State of Indiana, LAKE County, ss

Before me, a Notary Public in and for said County and State, personally appeared \_\_\_\_\_  
and Matthew W. Sexton who acknowledged the execution of the foregoing Sworn Statement and Notice of Intention to Hold Mechanic's Lien, and who, having been duly sworn, under the penalties of perjury, stated that the facts and matters therein set forth are true and correct.

Witness my hand and Notarial Seal this date MARCH 22 2000  
My commission expires 4-1-2001

Resident of GARY IN - LAKE County LONNIE P CARTER  
Signature

I hereby certify that I have this date \_\_\_\_\_, 19\_\_\_\_, mailed a duplicate of this notice, first class, postage prepaid, to the within named property owner at (latest address shown on tax records)

Recorder of \_\_\_\_\_ County  
This instrument prepared by: \_\_\_\_\_ Resident of \_\_\_\_\_ County

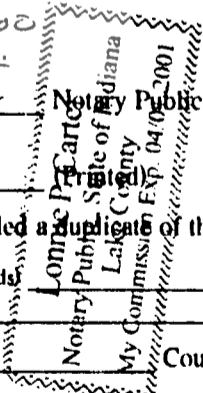

13.00  
CASH

25 x 11