

STATE OF INDIANA
LAKE COUNTY
FILED

2000 019473

2000 MAR 22 AM 10:00

THIS FORM HAS BEEN PREPARED FOR USE IN THE STATE OF INDIANA BY LAWYERS ONLY. THE SELECTION OF A FORM OF INSTRUMENT, FILLING IN BLANK SPACES, STRIKING OUT PROVISIONS, AND INSERTION OF SPECIAL CLAUSES, MAY CONSTITUTE THE PRACTICE OF LAW WHICH SHOULD ONLY BE DONE BY A LAWYER.

MAIL TAX BILLS TO:

QUITCLAIM DEED

THIS INDENTURE WITNESSETH, that RAY EARL HOPPER

GRANTOR(S) of Lake County in the State of Indiana

QUITCLAIM(S) to LAVERNE M. HOPPER

GRANTEE(S) of Lake County in the State of Indiana

in consideration of One Dollar (\$1.00) and other valuable consideration, the receipt and sufficiency of which are hereby acknowledged, the following described real estate in Lake County in the State of Indiana:

Lots 23 and 24, Block 6, Sixth Addition to New Chicago, as shown in Plat Book 6, page 47, Lake County, Indiana, a/k/a 101 Tyler Street, New Chicago, Indiana.

Subject to taxes 1999, payable in 2000 and taxes for all subsequent years.

Subject to all deeds, covenants, easements and restrictions of record.

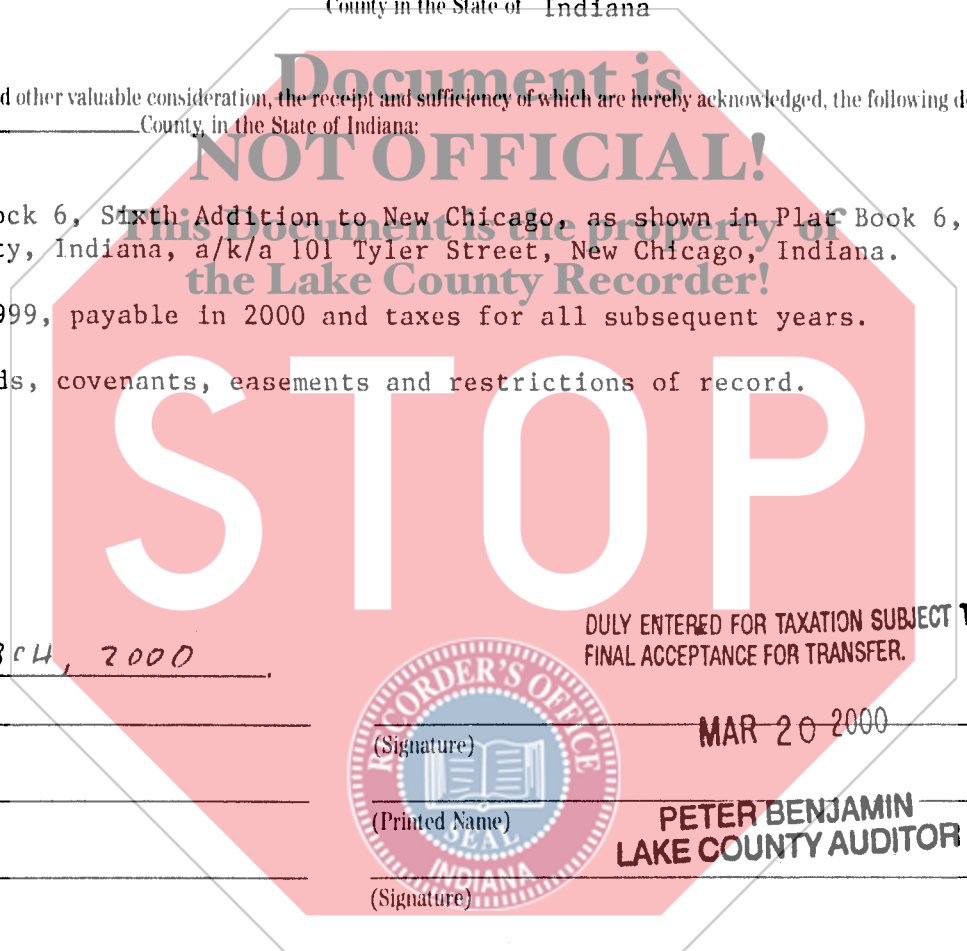

Dated this 7 day of MARCH, 2000

Ray Earl Hopper
(Signature)

RAY EARL HOPPER
(Printed Name)

(Signature)

(Printed Name)

DULY ENTERED FOR TAXATION SUBJECT TO FINAL ACCEPTANCE FOR TRANSFER.

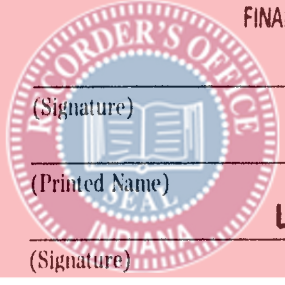

MAR 20 2000

PETER BENJAMIN
LAKE COUNTY AUDITOR

(Signature)

(Printed Name)

STATE OF INDIANA, COUNTY OF LAKE SS:

Before me, the undersigned, a Notary Public in and for said County and State, this 7 day of March, 2000, personally appeared: RAY EARL HOPPER

and acknowledged the execution of the foregoing deed. In witness whereof, I have hereunto subscribed my name and affixed my official seal.

My commission expires: 06-01-2001

Lance N. Williams
Signature

Resident of Porter County

Printed Lance N. Williams, Notary Public

This instrument prepared by Daniel Ostojic, 6287 Central Avenue Attorney at Law, Attorney No. 9975-64 Portage, IN 46368

MAIL TO:

© COPYRIGHT, THE ALLEN COUNTY INDIANA BAR ASSOCIATION, INC (REV 2 97)

14.00
8.11
2860

25 x 10