

2000 018807

2000 MAR 21 AM 9:24

MORRIS W. CARTER
RECORDER

Parcel No. (8) 15-198-15

WARRANTY DEED

ORDER NO. 920000521 - MD

THIS INDENTURE WITNESSETH, That Jeffrey K. Fleeger and Debra A. Fleeger, husband and wife
(Grantor)

of Lake County, in the State of INDIANA CONVEY(S) AND WARRANT(S)
to Bennie M. Conner, Jr. and Deborah A. Kirklen, as Joint Tenants, with rights of survivorship
(Grantee)

of Lake County, in the State of INDIANA, for the sum of _____
TEN AND 00/100 Dollars (\$ 10.00)

and other valuable consideration, the receipt and sufficiency of which is hereby acknowledged, the following
described real estate in Lake County, State of Indiana:

Lot 15 in Brookwood, in the Town of Merrillville, as per plat thereof, recorded in Plat Book 27 page 42, in the Office
of the Recorder of Lake County, Indiana.

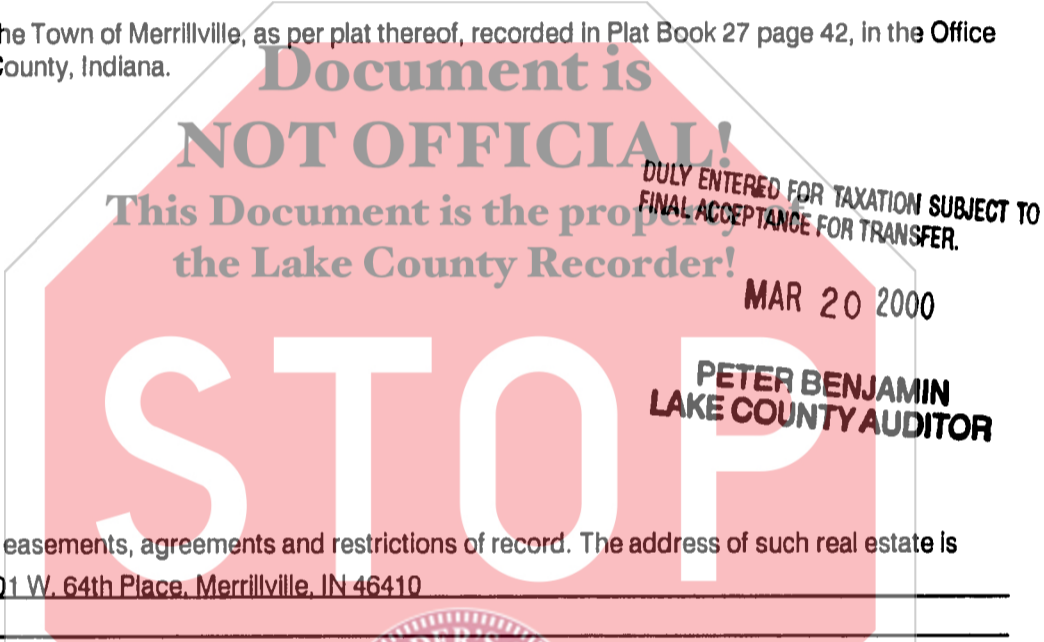

Subject to any and all easements, agreements and restrictions of record. The address of such real estate is
commonly known as 1901 W. 64th Place, Merrillville, IN 46410

Tax bills should be sent to Grantee at such address unless otherwise indicated below.

IN WITNESS WHEREOF, Grantor has executed this deed this 15TH day of March, 2000.

Grantor: [Signature] (SEAL) Grantor: [Signature] (SEAL)
Signature _____ Signature _____
Printed Jeffrey K. Fleeger Printed Debra A. Fleeger

STATE OF INDIANA }
COUNTY OF Lake } SS: ACKNOWLEDGEMENT

Before me, a Notary Public in and for said County and State, personally appeared _____
Jeffrey K. Fleeger and Debra A. Fleeger, Husband and Wife
who acknowledge the execution of the foregoing Warranty Deed, and who, having been duly sworn, stated that
any representation therein contained are true.
Witness my hand and Notarial Seal this 15TH day of March, 2000.

My commission expires: OCTOBER 2, 2001
Signature [Signature]
Printed Paula Barrick, Notary Name
Resident of Lake County, Indiana.

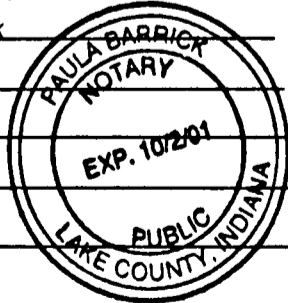

This instrument prepared by Jeffrey K. Fleeger
Return deed to 1901 W. 64th Place, Merrillville, IN 46410
Send tax bills to 1901 W. 64th Place, Merrillville, IN 46410

01200 14 gm