

2000 018787

STATE OF INDIANA  
LAKE COUNTY  
FILED FOR RECORD

2

2000 MAR 21 AM 9:20

MORRIS W. CARTER  
RECORDER

Parcel No. (27) 17-319-55

**WARRANTY DEED**

ORDER NO. 920000949 *Hwt.*

THIS INDENTURE WITNESSETH, That JAMES D. WRIGHT

(Grantor)

of Lake County, in the State of INDIANA CONVEY(S) AND WARRANT(S)  
to BRIAN L. HOWERTON & JULIET A. HOWERTON, HUSBAND AND WIFE

(Grantee)

of Lake County, in the State of INDIANA, for the sum of \_\_\_\_\_  
TEN AND 00/100 Dollars (\$ 10.00 )

and other valuable consideration, the receipt and sufficiency of which is hereby acknowledged, the following  
described real estate in Lake County, State of Indiana:

Lot 55 in Hillman Heights, as per plat thereof, recorded in Plat Book 80 page 54, in the Office of the Recorder of  
Lake County, Indiana.

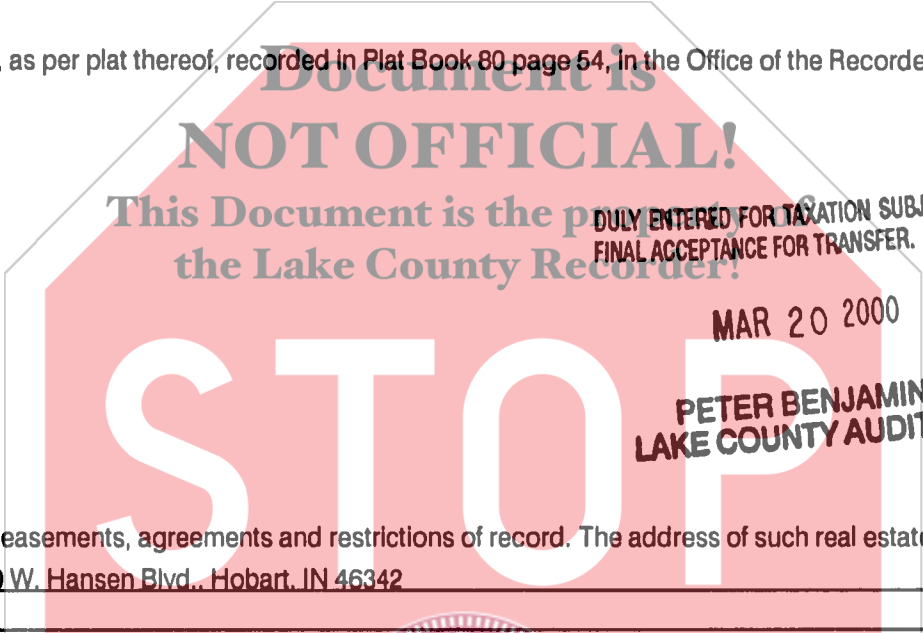

Subject to any and all easements, agreements and restrictions of record. The address of such real estate is  
commonly known as 430 W. Hansen Blvd., Hobart, IN 46342

Tax bills should be sent to Grantee at such address unless otherwise indicated below.

IN WITNESS WHEREOF, Grantor has executed this deed this 16TH day of March, 2000.

Grantor: *[Signature]* (SEAL) Grantor: *[Signature]* (SEAL)  
Signature Signature

Printed JAMES D. WRIGHT Printed \_\_\_\_\_

STATE OF INDIANA }  
COUNTY OF Lake } SS: \_\_\_\_\_ ACKNOWLEDGEMENT

Before me, a Notary Public in and for said County and State, personally appeared \_\_\_\_\_  
JAMES D. WRIGHT

who acknowledge the execution of the foregoing Warranty Deed, and who, having been duly sworn, stated that  
any representation therein contained are true.  
Witness my hand and Notarial Seal this 16TH day of December, 2007.

My commission expires DECEMBER 8, 2007 Signature *[Signature]*  
Printed JACALYN L. SMITH, Notary Name  
Resident of LAKE County, Indiana.

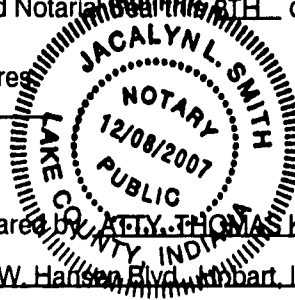

This instrument prepared by ATTY. THOMAS K. HOFFMAN 7731-45

Return deed to 430 W. Hansen Blvd., Hobart, IN 46342

Send tax bills to 430 W. Hansen Blvd., Hobart, IN 46342

*31339*  
*14-AM*  
*TI*