

STATE OF INDIANA
LAKE COUNTY
FILED FOR RECORD

2000 018334

2000 MAR 17 AM 9:50

MORRIS CENTER
REC'D

MEMORANDUM OF LEASE

C199005658 LD

5

THIS MEMORANDUM OF LEASE is entered into by and between DR VENTURE I, LLC, an Indiana limited liability company (hereinafter referred to as "Lessor"), and CANCER HEALTH ASSOCIATES, P.C., an Indiana professional corporation (hereinafter referred to as "Lessor").

1. Lessor hereby leases to Lessee certain premises contained within real estate in Lake County, Indiana, the legal description of which is as follows:

Part of the Northwest Quarter of the Southeast Quarter of Section 21, Township 35 North, Range 8 West of the 2nd P.M., described as: Commencing at a point 602.95 feet South of the Northeast corner thereof; thence West parallel to the half section line a distance of 554.66 feet, more or less to a point on the center line of the public road; thence Southwesterly along said center line a distance of 381.36 feet to a point; thence East parallel to the half section line a distance of 656.78 feet to a point on the East line thereof; thence North a distance of 368.05 feet to the point of beginning, in Lake County, Indiana

and more commonly known as follows: 8127 Merrillville Road, Merrillville, Indiana.

2. This Memorandum of Lease is subject to all of the terms and provisions of a certain lease entered into between the parties effective as of the 14th day of March, 2000, all of the provisions of which are incorporated herein and made a part hereof with the same force and effect as if fully set forth herein.
3. The lease has a term of five (5) years with an option to extend for one (1) additional period of five (5) years.

FILED

MAR 16 2000

PETER BENJAMIN
LAKE COUNTY AUDITOR

01153

13-
km
GT

Chicago Title Insurance Company

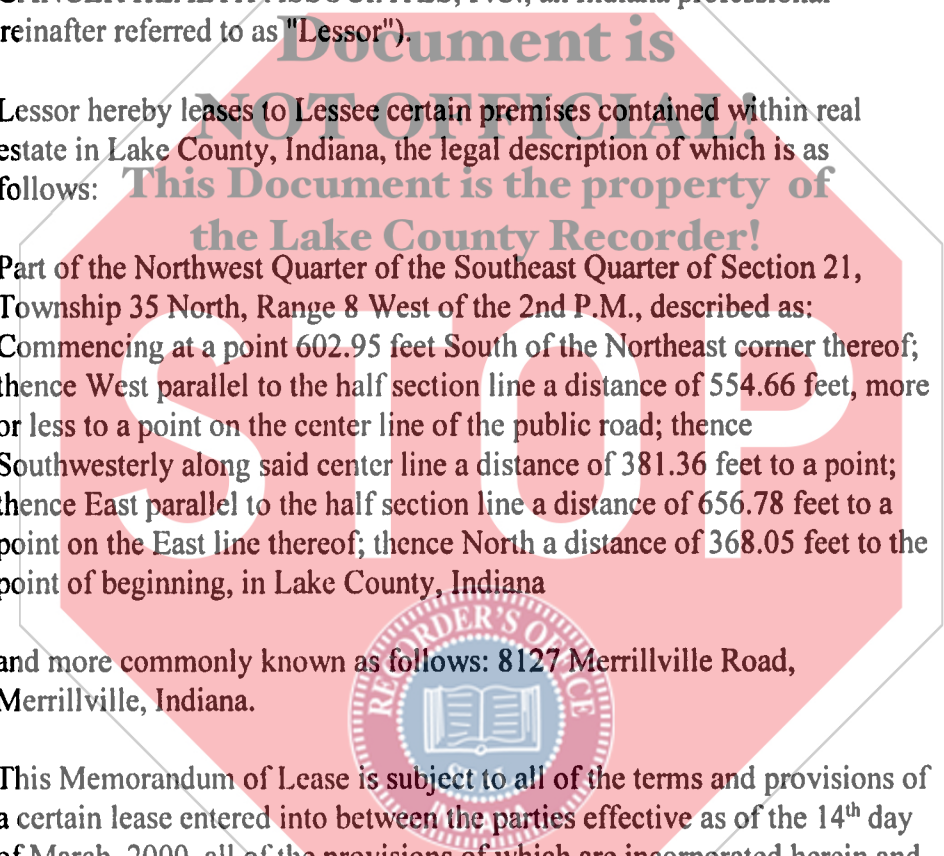

4. The lease commencement date is April 1, 2000 and the original term of the lease terminates on March 31, 2005.

5. Lessee hereby acknowledges and states that the following referenced leases have terminated:

a) Lease by and between Southlake Professional Building, an Indiana partnership, Lessor(s), and Cancer Health Associates, P.C., Lessee(s), as evidenced by a Short Form Lease dated February 1, 1991 and recorded June 27, 1991 as Document No. 91032240; and

b) Lease by and between Southlake Professional Building, an Indiana partnership, Lessor(s), and Cancer Health Associates, P.C., Lessee(s), as evidenced by a Short Form Lease dated February 1, 1991 and recorded June 27, 1991 as Document No. 91032241.

Dated this 14th day of March, 2000.

LESSOR:

DR VENTURE I, LLC,
an Indiana limited liability company

By: *David L. Lamm*

Its: *Manager*

LESSEE:

CANCER HEALTH ASSOCIATES, P.C.,
an Indiana professional corporation

By: *R. Drasz* *Secretary*

Its: _____

STATE OF INDIANA)
) SS:
COUNTY OF LAKE)

BEFORE ME, a Notary Public in and for said County and State, personally appeared DAVID A. LASSER as MANAGER of DR VENTURE I, LLC, an Indiana limited liability company, and acknowledged the execution of the above and foregoing Memorandum of Lease.

WITNESS my hand and Notarial Seal this 14th day of MAY, 2000.

My Commission Expires: JUNE 25, 2007
A resident of LAKE County. Stan Lugo, Notary Public
Printed Name Stan Lugo

STATE OF INDIANA)
) SS:
COUNTY OF LAKE)

BEFORE ME, a Notary Public in and for said County and State, personally appeared DRAGAN M. RAYE as Officer of CANCER HEALTH ASSOCIATES, P.C., an Indiana professional corporation and acknowledged the execution of the above and foregoing Memorandum of Lease.

WITNESS my hand and Notarial Seal this 14th day of March, 2000.

My Commission Expires: _____
A resident of _____ County.
Printed Name Barbara A. Boese
Notary Public
Notary Public, State of Indiana
Porter County
My Commission Exp. 07/06/2001

This document prepared by, and after recording should be returned to, Lora Bechtel, Property Manager, 1st American Management Co., Inc. P.O. Box 1580, Valparaiso, IN 46384-1580