

THIS FORM HAS BEEN APPROVED BY THE INDIANA STATE BAR ASSOCIATION FOR USE BY LAWYERS ONLY. THE SELECTION OF A FORM OF INSTRUMENT, FILLING IN BLANK SPACES, STRIKING OUT PROVISIONS AND INSERTION OF SPECIAL CLAUSES, CONSTITUTES THE PRACTICE OF LAW AND MAY ONLY BE DONE BY A LAWYER.

MAIL TAX BILLS TO:
366 South Hancock Street
Gary, Indiana 46403-2361

QUIT CLAIM DEED

2000 017738

This indenture witnesseth that Mary Kathryn Gustafson

of Lake County in the State of Indiana

Releases and quit claims to Mary Kathryn Gustafson (WROS) and Charles Phillip Isley II (WROS)

of Lake County in the State of Indiana
for and in consideration of \$1.00
the receipt whereof is hereby acknowledged, the following Real Estate in Lake County
in the State of Indiana, to wit:

The North half of Lot Nine (9), Block Twenty Four (BL. 24) in Daly's First (1st) Addition in Miller now the city of Gary. As shown in Plat book 5, Page 34 in Lake County, Indiana.

South twelve and One half feet (S. 12 1/2 ft.) of lot Eight (8), Block Twenty Four (BL 24) in Daly's First (1st) Addition in Miller now in the City of Gary. As shown in Plat book 5, page 34 in Lake County, Indiana.

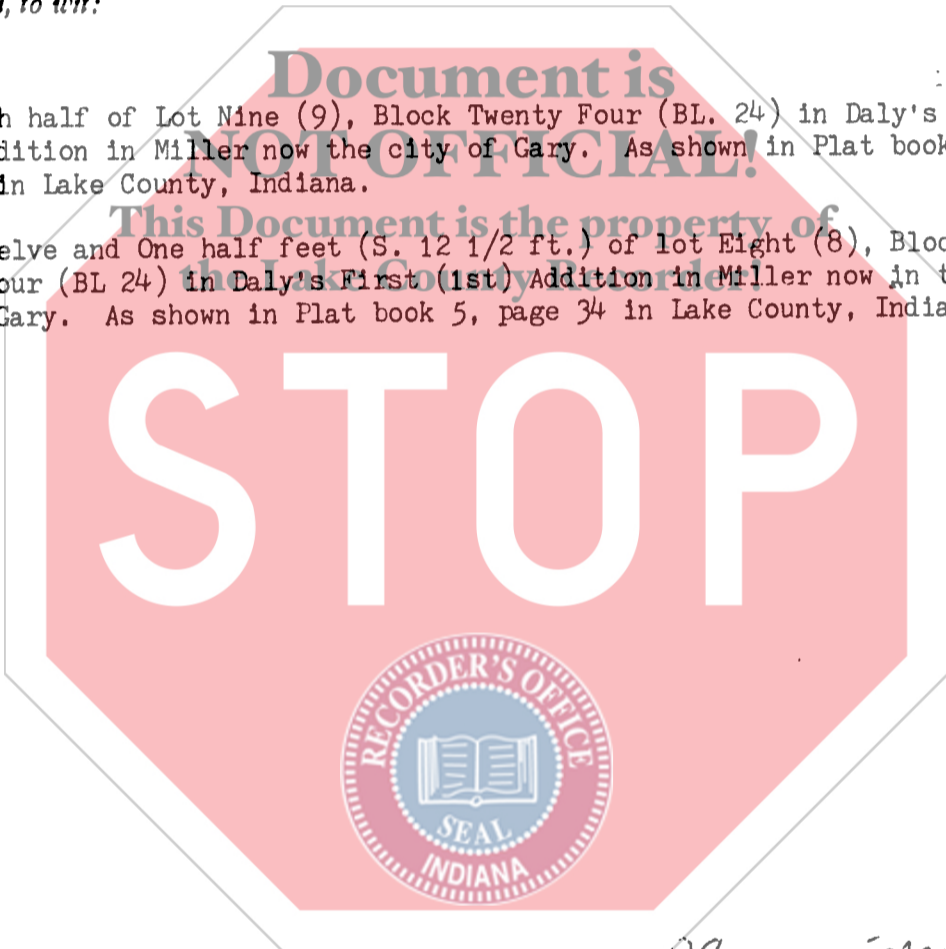

State of Indiana, Lake County, ss:
Before me, the undersigned, a Notary Public in and for said County and State, this 28th day of February, 2000
personally appeared:
Mary Kathryn Gustafson

Dated this 28 Day of FEBRUARY, 2000

Mary Kathryn Gustafson Seal
Mary Kathryn Gustafson

Seal

Seal

DULY ENTERED FOR TAXATION SUBJECT TO
FINAL ACCEPTANCE FOR TRANSFER Seal

MAR 15 2000 Seal

PETER BENJAMIN
LAKE COUNTY AUDITOR Seal

And acknowledged the execution of the foregoing deed. In witness whereof, I have hereunto subscribed my name and affixed my official seal. My commission expires January 18, 2008

Maria R. Hyden
Maria R. Hyden Notary Public

Resident of Porter County

This instrument prepared by Mark H. Holtan 1644 45th Av. Munster, Indiana Attorney at Law
Mary Kathryn Gustafson @ 366 South Hancock St. Gary, IN 46403-2361

MAIL TO:

01094

15-
Su
CS