

2000 017443

2000 MAR 14 AM 10:00

Satisfaction of Mortgage-Individual or Corporation! **CARRIER**

CONSULT YOUR LAWYER BEFORE SIGNING THIS INSTRUMENT-THIS SHOULD BE USED BY LAWYERS ONLY

**KNOW ALL MEN BY THESE PRESENTS,**

that **EAB MORTGAGE COMPANY INC**, a New York banking corporation with an office at 400 Oak Street, Garden City, NY 11530-6552

*Insert residence, if individual or principal office, if corporation, giving street and street number.*

**DOES HEREBY CERTIFY** that the following Mortgage **IS PAID**, and does hereby consent that the same be discharged of record.

Mortgage dated the 21st day of April, 1998 made by Johnny L. Kimbrough premises located at 1033 Baker Street, Gary, Indiana 46404 to STATE STREET MORTGAGE COMPANY

in the principal sum of \$14,600.00 and recorded on the 28th day of April, 1998, in Instrument No. 98030022 in the office of the Clerk of the County of Lake

WHICH MORTGAGE WAS SUBSEQUENTLY ASSIGNED FROM STATE STREET MORTGAGE COMPANY TO EAB MORTGAGE COMPANY INC. BY ASSIGNMENT DATED JUNE 18, 1998 AND RECORDED IN THE COUNTY OF LAKE ON SEPTEMBER 16, 1998 IN INSTRUMENT NO. 98073089

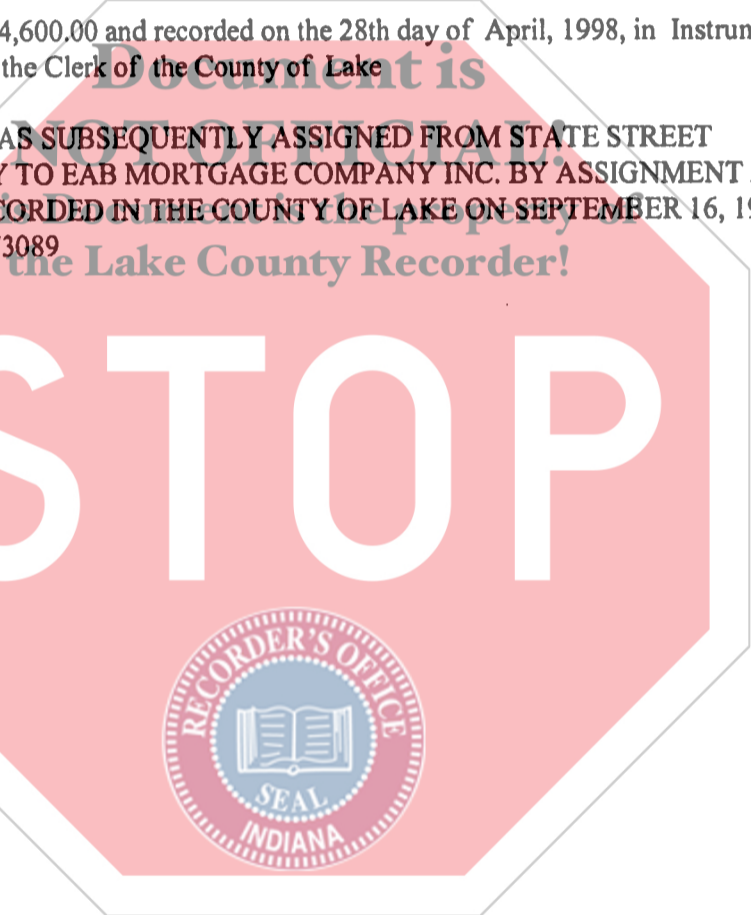

District:

Section:

Block: 21

Lot: 35 And 36

Unit:

*Insert "further" when required.*

which mortgage has not been assigned of record

Dated the 24th day of February 2000

IN PRESENCE OF:

**EAB MORTGAGE COMPANY INC.**

By Colleen McGrath  
Colleen McGrath  
Retail Credit Manager II

*Section 321 of the Real Property Law expressly provides who must execute the certificate of discharge in specific cases and also provides, among other things, that (1) no certificate shall purport to discharge more than one mortgage, (except that mortgages affected by instruments of consolidation, spreader, modification or correction may be included in one certificate if the instruments are set forth in detail in separate paragraphs; (2) if the mortgage has been assigned, in whole or in part, the certificate shall set forth: (a) the date of each assignment in the chain of title of the person or persons signing the certificate, (b) the names of the assignor and assignee, (c) the interest assigned, and (d) if the assignment has been recorded, the book and page where it has been recorded or the serial number of such record, or (e) if the assignment is being recorded simultaneously with the certificate of discharge, the certificate of discharge shall so state, and (f) if the mortgage has not been assigned of record, the certificate shall so state; (3) if the mortgage is held by any fiduciary, including an executor or administrator, the certificate of discharge shall recite the name of the court and the venue of the proceedings in which his appointment was made or in which the order or decree vesting him with such title or authority was entered.*

IN 14/26-1

13-  
\* 12/15 HOLD NETCO

**STATE OF NEW YORK, COUNTY NASSAU SS:**

On the 24th day of February in the year 2000 before me, the undersigned, personally appeared Colleen McGrath personally known to me or proved to me on the basis of satisfactory evidence to be the individual(s) whose name(s) is (are) subscribed to the within instrument and acknowledged to me that he/she/they executed the same in his/her/their capacity(ies), and that by his/her/their signature(s) on the instrument, the individual(s), or the person upon behalf of which the individual(s) acted, executed the instrument.

*Dorfen Moore*

DORFEN MOORE  
Notary Public, State of New York  
No. 30,475-2541  
Qualified in Nassau County 2001  
Commission Expires March 30, 2002

**STATE OF NEW YORK, COUNTY OF SS:**

On the day of 19 , before me personally came to me known to be the individual described in and who executed the foregoing instrument, and acknowledged that executed the same.

**STATE OF NEW YORK, COUNTY OF NASSAU SS:**

On the day of, before me personally came to me known, who, being by me duly sworn, did depose and say that he resides at, that he is the of., the corporation described in and which executed the foregoing instrument; that he knows the seal of said corporation; that the seal affixed to said instrument is such corporate seal; that it was so affixed by order of the board of directors of said corporation, and that she signed her name there to by like order.

**STATE OF NEW YORK, COUNTY OF SS:**

On the day of 19 , before me personally came the subscribing witness to the foregoing instrument, with whom I am personally acquainted, who, being by me duly sworn, did depose and say that he resides at No. ; that he knows to be the individual described in and who executed the foregoing instrument; that he, said subscribing witness, was present and saw execute the same; and that he, said witness, at the same time subscribed his name as witness thereto.

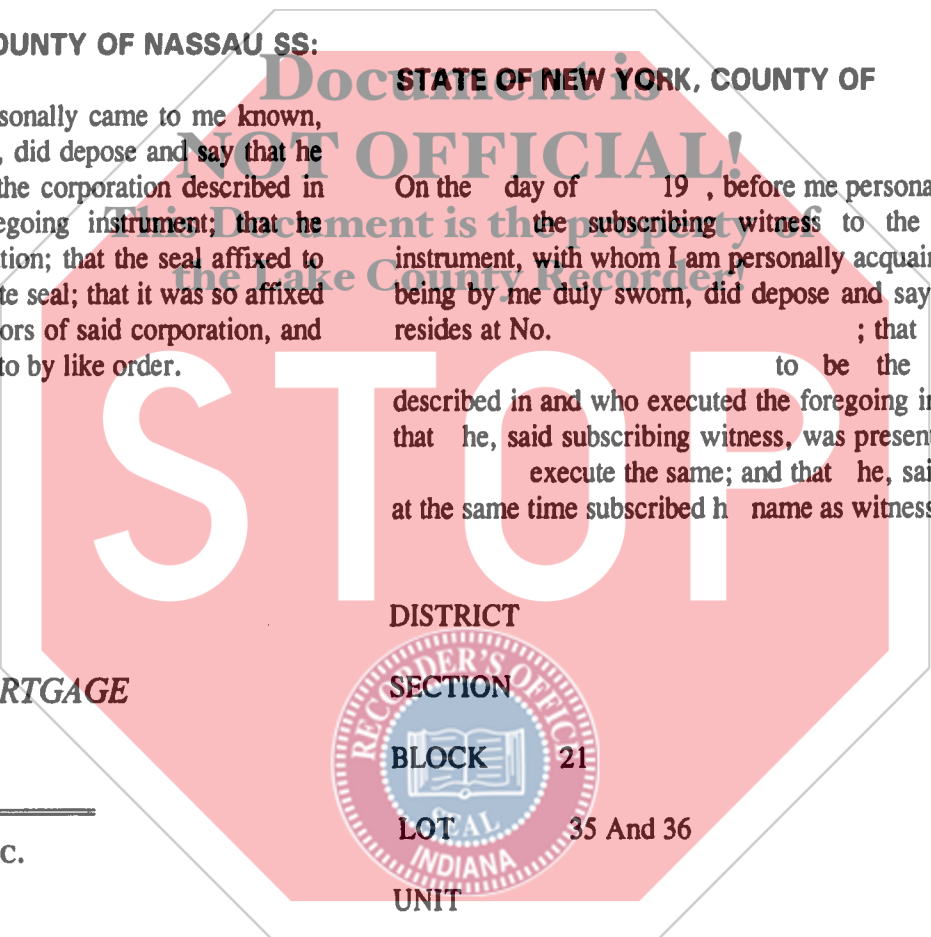

**SATISFACTION OF MORTGAGE**

Title No.

EAB MORTGAGE COMPANY INC.

TO

DISTRICT  
SECTION  
BLOCK 21  
LOT 35 And 36  
UNIT

COUNTY OF Lake

TOWN

Johnny L. Kimbrough

Return by Mail to

EAB Acct. No. 7573355

RECEIPT AND RETURN  
Johnny L. Kimbrough  
1033 Baker Street  
Gary, Indiana  
46404

RESERVE THIS SPACE FOR USE OF RECORDING OFFICE