

Chicago Tide Insurance Company

STATE OF INDIANA
LAKE COUNTY
FILED FOR RECORD

2000 017423

2000 MAR 14 AM 9:45

MICHAEL W. CARTER
RECORDER

①

C620000200LD

THIS FORM HAS BEEN PREPARED FOR USE IN THE STATE OF INDIANA BY LAWYERS ONLY. SELECTING A FORM OF INSTRUMENT, FILLING IN BLANK SPACES, STRIKING OUT PROVISIONS AND INSERTING SPECIAL CLAUSES MAY CONSTITUTE THE PRACTICE OF LAW, WHICH SHOULD BE PERFORMED ONLY BY A LAWYER.

Mail tax bills to:

1430 St Andrews Dr
Schererville, IN 46375

WARRANTY DEED

THIS INDENTURE WITNESSETH, That John C. Lahey and Carole J. Lahey, husband and wife ("Grantor")

of Lake County in the State of Indiana

CONVEY(S) AND WARRANT(S) TO Lawrence C. Ellis and Jody L. Ellis, husband and wife ("Grantee")

of Lake County in the State of Indiana

in consideration of One Dollar and other valuable consideration, the receipt and sufficiency of which are hereby acknowledged, the following described real estate in Lake County, in the State of Indiana:

Lot 22 in Block 1, Briar Ridge Country Club Addition, Unit 2, as per plat thereof, recorded in Plat Book 55, page 39, in the Office of the Recorder of Lake County, Indiana, and commonly known as 1430 St. Andrews Drive, Schererville, Indiana 46375.

Key No. 13-352-22

Subject to special assessments, 1999 taxes payable 2000, and all real estate taxes due and payable thereafter.

Subject to easements, restrictions and covenants of record, if any.

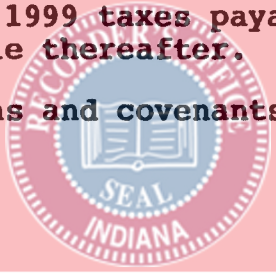
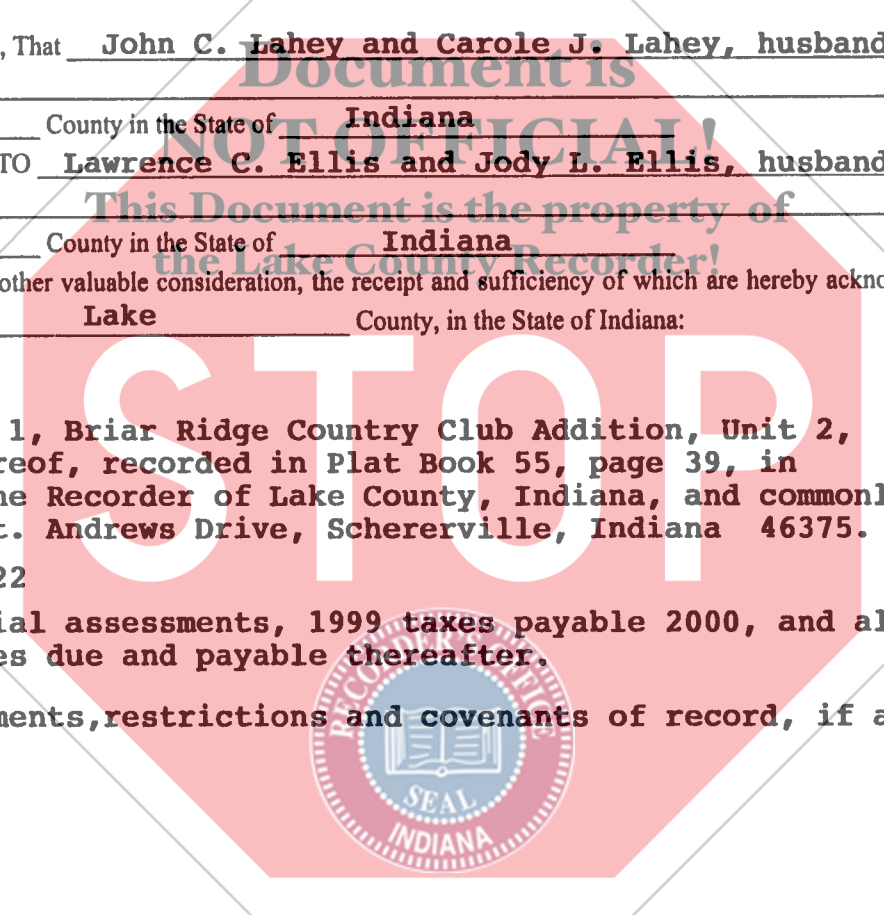

00811

(Do not mark below this line) DULY ENTERED FOR TAXATION SUBJECT TO FINAL ACCEPTANCE FOR TRANSFER.

MAR 13 2000

PETER BENJAMIN
LAKE COUNTY AUDITOR

16.3.0
PMA

Dated this 9th day of March, 2000

John C. Lahey
(Signature)

John C. Lahey
(Printed Name)

Carole J. Lahey
(Signature)

Carole J. Lahey
(Printed Name)

(Signature)

(Printed Name)

(Signature)

(Printed Name)

STATE OF Indiana COUNTY OF Lake SS:

Before me, the undersigned, a Notary Public in and for said County and State, this 9th day of March, 2000 personally appeared: John C. Lahey and Carole J. Lahey

and acknowledged the execution of the foregoing deed. In witness whereof, I have hereunto subscribed my name and affixed my official seal.

My commission expires: 2/2/01 Signature *Scott E. Yahne*

Resident of Lake County Printed Scott E. Yahne, Notary Public

STATE OF _____ COUNTY OF _____ SS:

Before me, the undersigned, a Notary Public in and for said County and State, this _____ day of _____ personally appeared: _____

and acknowledged the execution of the foregoing deed. In witness whereof, I have hereunto subscribed my name and affixed my official seal.

My commission expires: _____ Signature _____

Resident of _____ County Printed _____, Notary Public

This instrument prepared by Scott E. Yahne, 5246 Hohman Avenue, Hammond IN 46320, Attorney at Law
Attorney No. 16912-53

MAIL TO: Lawrence C. Ellis and Jody L. Ellis
1430 St. Andrews Drive
Schererville, Indiana 46375

