

2000 016617

2000 MAR -9 AM 9:50

MORRIS W. CARTER  
RECORDER

*N*

RECORDING REQUESTED BY:

WHEN RECORDED MAIL TO:

MSN SV-79 / DOCUMENT CONTROL DEPT.  
P.O. BOX 10266  
VAN NUYS, CALIFORNIA 91410-0266

Prepared by: R. GENKINA

LOAN #: 3246328

ESCROW/CLOSING #:

**ASSIGNMENT OF DEED OF TRUST/MORTGAGE**

For Value Received, the undersigned hereby grants, assigns and transfers to  
**COUNTRYWIDE HOME LOANS, INC.** the Lake County Recorder!  
all beneficial interest under that certain Deed of Trust/Mortgage dated 02/16/2000  
executed by IRA L COLLINS,

\_\_\_\_\_, Trustor/Borrower  
to \_\_\_\_\_, Trustee/Mortgagee

and recorded as Instrument No. \_\_\_\_\_ (CONCURRENTLY HEREWITH) on \_\_\_\_\_  
in Book/Reel \_\_\_\_\_ Page/Image \_\_\_\_\_, of Official Records in the County Recorder's office  
of LAKE, IN describing land therein as:

ALL THAT CERTAIN PARCEL OF LAND SITUATE IN THE CITY OF GARY, COUNTY OF  
LAKE AND STATE OF INDIANA, BEING LOTS 29 AND 30, BLOCK 4, PATTERSON AND  
STOUT'S FIRST SUBDIVISION, AS SHOWN IN PLAT BOOK 9, PAGE 25, LAKE COUNTY  
RECORDS.  
TAX ID # 46-346-30

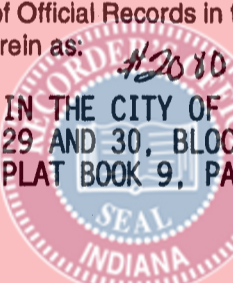
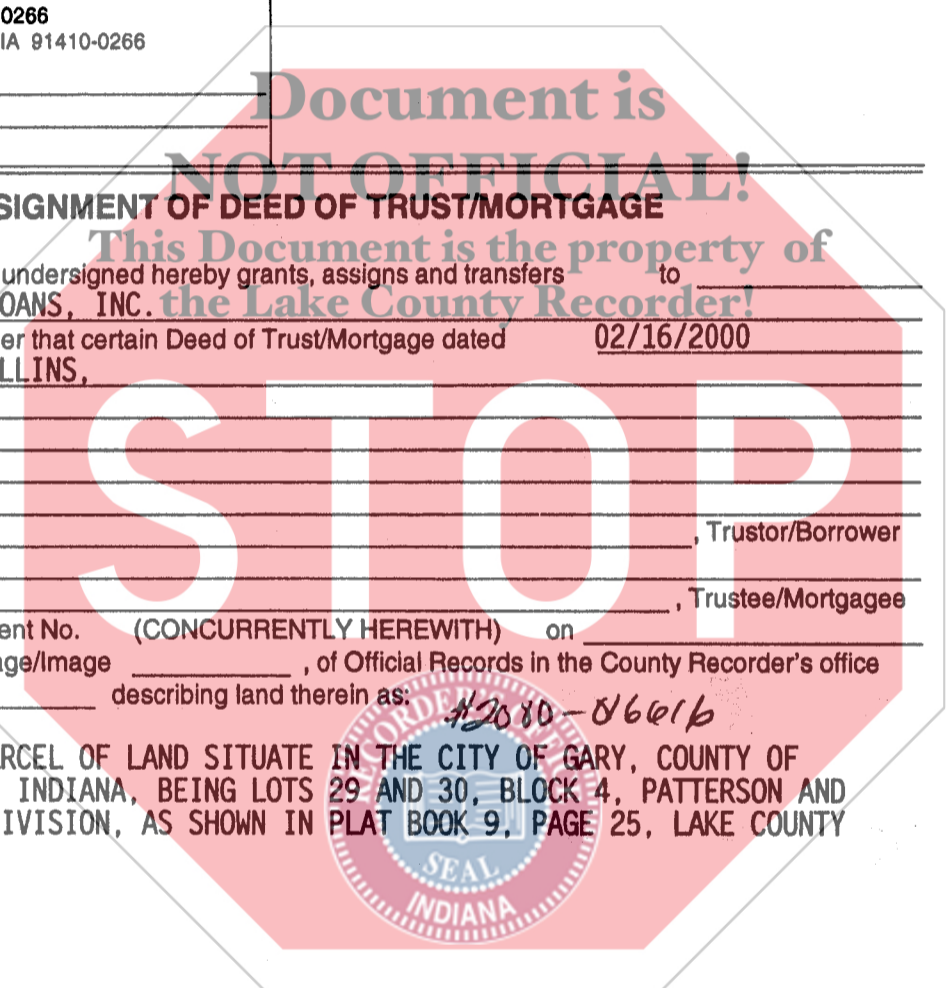

Initials: *ILC*

\*23991\*

\*003246328000002C253\*

*12.50  
pm  
4279*

25 x 10

LOAN # 3246328

Together with the note therein described or referred to, the money due and to become due thereon with interest, and all rights accrued or to accrue thereunder.

FULL SPECTRUM LENDING, INC.

Dated February 16, 2000

Maria Aldama  
Maria Aldama

Rebecca Kennedy  
REBECCA KENNEDY  
Branch Manager

Sandra Turner  
Sandra Turner

ACKNOWLEDGMENT

Document is  
**NOT OFFICIAL!**

This Document is the property of  
the Lake County Recorder!

State of ILLINOIS  
County of COOK

On February 16, 2000, before me, the undersigned, a Notary Public in and for said County and State personally appeared Rebecca Kennedy, Maria Aldama, Sandra Turner personally known to me (or proved to me on the basis of satisfactory evidence) to be the person(s) whose name(s) is/are subscribed to the within instrument as the principal(s) and acknowledged to me that said principal(s) executed it.

Witness My Hand and Official Seal

OFFICIAL SEAL  
DENISE M. PETERS  
NOTARY PUBLIC, STATE OF ILLINOIS  
MY COMMISSION EXPIRES 12-3-2001

Denise M. Peters  
Notary Public in and for said County and State

My Commission expires 12-3-2001