

Warranty Deed

This Indenture Witnesseth, That Carolyn Cannon

2000 015611

of Lake County, in the State of Indiana
Convey and Warrant to Mercantile National Bank U/T# 6228

of Lake County, in the State of Indiana, for and in consideration
of Ten dollars and no/100----- Dollars,
the receipt whereof is hereby acknowledged, the following described Real Estate in
Lake County in the State of Indiana, to-wit:

Lot 20, Block 7, Aetna Manor Fourth Subdivision as shown in Plat
Book 29, page 99, Lake County, Indiana

Commonly known as: 1126 Floyd St., Gary, IN

Key#41-0281-0020

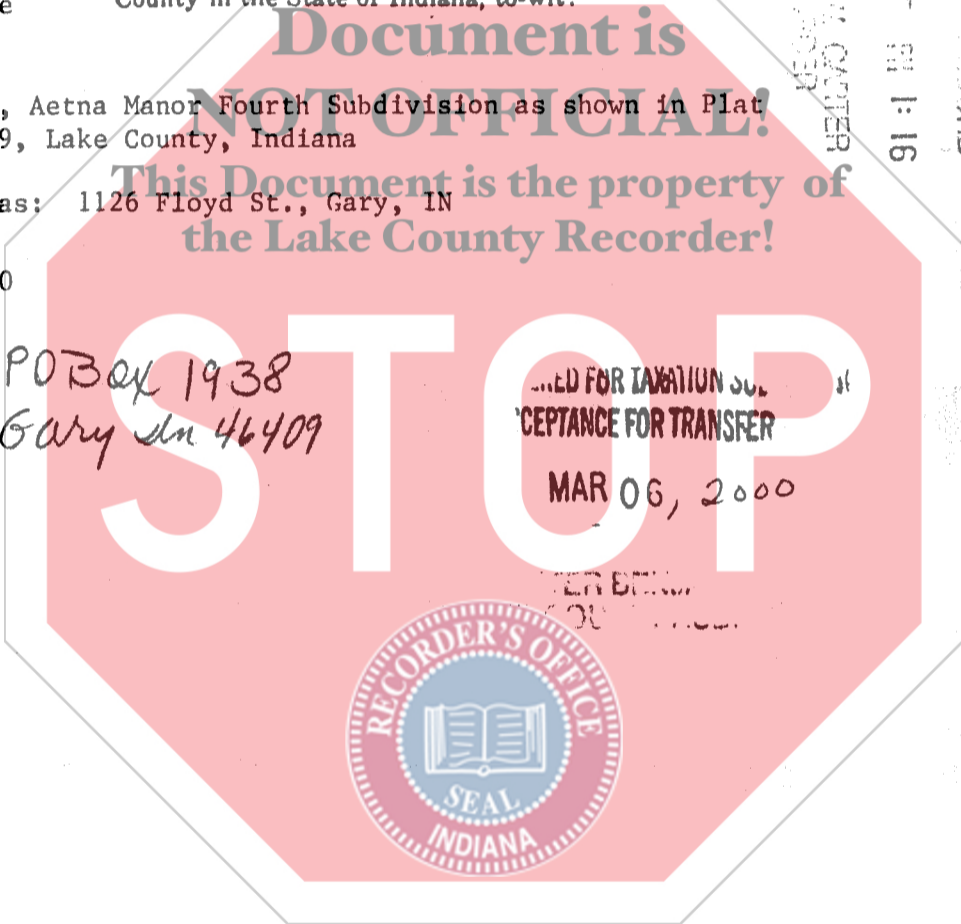

2000 MAR 06 PM 1:16
MERCANTILE NATIONAL BANK
RECORDING CENTER
GARY, IN 46409

TAX BILL to: PO Box 1938
Gary In 46409

...ED FOR TAXATION SUB
CEPTANCE FOR TRANSFER
MAR 06, 2000

In Witness Whereof, The said Carolyn Cannon

has hereunto set hand and seal, this 20th day of January 2000

_____(Seal) Carolyn Cannon _____(Seal)
Carolyn Cannon
_____(Seal) _____(Seal)
_____(Seal) _____(Seal)

002 2 (Seal) # 97021



STATE OF INDIANA, Lake COUNTY, SS:

Before me, the undersigned, a Notary Public, in and for said County and State, this..... 20th
 day of..... January A.D., 19..... 2000, personally appeared the within named.....
 Carolyn Cannon

.....Grantor.....in the above conveyance, and acknowledged
 the execution of the same to be..... hervoluntary act and deed, for the uses and purposes herein mentioned.
 IN WITNESS WHEREOF, I have hereunto subscribed my name and affixed my official seal.
 My Commission expires..... 11-16-2001 *Delipa Ortez*Notary Public.
 Resident of Lake County

STATE OF INDIANA, COUNTY, SS:

Before me, the undersigned, a Notary Public, in and for said County and State, this.....
 day of....., A.D., 19....., personally appeared the within named.....

.....Grantor.....in the above conveyance, and acknowledged
 the execution of the same to be.....voluntary act and deed, for the uses and purposes herein mentioned
 IN WITNESS WHEREOF, I have hereunto subscribed my name and affixed my official seal.
 My Commission expires.....Notary Public.
 Resident of County

