

2000 015332 2000 MAR -3 AM 10: 28
MORTGAGE/DEED OF TRUST ASSIGNMENT

MORRIS W. CARTER
RECORDER

6903568126

For value received, CONSECO BANK, INC. ("Assignor"), a corporation organized and existing under the laws of the State of Utah, hereby assigns to GREEN TREE FINANCIAL SERVICING CORPORATION, its successors and assigns, all right, title and interest in an to a certain Mortgage/Deed of Trust dated May 15, 1999, made by William Kelly and Iris Kelly, as mortgagor(s), to Conseco Bank, Inc., as mortgagee, as filed in the offices of the County Recorder, County of Lake, State of Indiana, Book _____ Page _____, together with the Note secured by such mortgage/deed of trust on the following described property situated in the above county and state, to wit:



Mtg. Rec. Bk. ___ Pg. ___
See attached exhibit A for legal description.
Instrument # 99049229

Dated this day of JUN 30 1999

CONSECO BANK, INC

By: Julie Larson
Julie Larson, Authorized Agent

State of Arizona)
)ss
County of Maricopa)

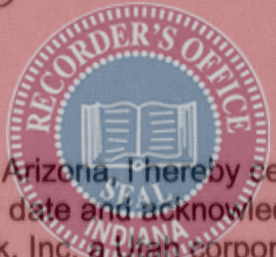

As a Notary Public for the State of Arizona, I hereby certify that Julie Larson personally came before me on this date and acknowledged that she is an Authorized Agent of Conseco Bank, Inc. a Utah corporation, and that by authority duly given and as act of the corporation, the foregoing instrument was signed in its name by him/her.

JUN 30 1999

Witness my hand and official seal dated this day of _____

[WHEN RECORDED RETURN TO]
NTC ATTN: DARRELL COLON
101 N. BRAND BLVD., SUITE #1800
GLENDALE, CALIFORNIA 91203
GREENTREE LOAN: 6903568126



[Signature]
Notary Public

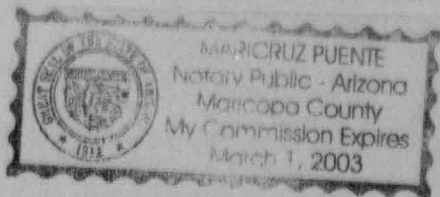

13.00
E.P.
488632

EXHIBIT A

Legal Description:

Lot 22 in Westfield Estates Unit One, as per plat thereof, Recorded in Plat Book 80, Page 74, in the Office of the Recorder of Lake County, Indiana.

Parcel ID: 15-26-490-22

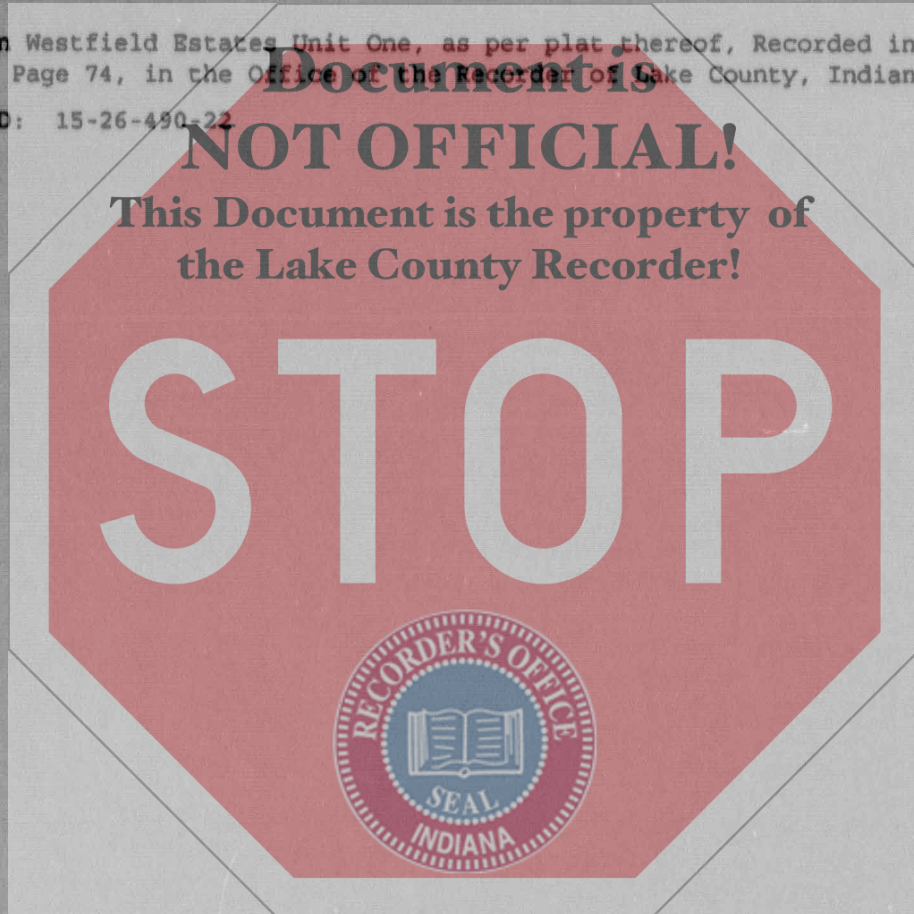

W.K. QK