

199100347740

GEORGE E. COLE®  
LEGAL FORMS

No. 804  
November 1994

18-28-599-8

**WARRANTY DEED**  
**Statutory (Illinois)**  
**(Corporation to Individual)**

CAUTION: Consult a lawyer before using or acting under this form. Neither the publisher nor the seller of this form makes any warranty with respect thereto, including any warranty of merchantability or fitness for a particular purpose.

THE GRANTOR

C.M.S. DEVELOPERS, INC.

a corporation created and existing under and by virtue of the laws of the State of ILLINOIS and duly authorized to transact

business in the State of INDIANA, for and in consideration

of the sum of \_\_\_\_\_  
TFN DOLLARS DOLLARS,

and other good and valuable considerations \_\_\_\_\_ in hand paid,

and pursuant to authority given by the Board of DIRECTORS of said corporation, CONVEYS and WARRANTS to

<sup>Keshari</sup>  
BIMAL KUMAR & PRITI KESHARI, HUSBAND AND WIFE  
~~3210 WASHINGTON STREET~~ 1621 Thistle Lane  
~~EAST CHICAGO, IN 46312~~ Munster, IN 46321

(Name and Address of Grantee)

the following described Real Estate situated in the County of LAKE

IN STATE OF INDIANA \_\_\_\_\_, to wit:

LOT 39, MEADOWS OF ST. GEORGE SUBDIVISION, UNIT TWO, TO THE TOWN OF MUNSTER LAKE COUNTY, INDIANA AS RECORDED IN PLAT BOOK 82, PAGE 43 IN THE OFFICE OF THE RECORDER OF LAKE COUNTY, INDIANA.

DULY ENTERED FOR TAXATION SUBJECT TO FINAL ACCEPTANCE FOR TRANSFER.

mail tax bills to: 1621 Thistle Lane, Munster, IN 46321

FEB 16 2000

Permanent Real Estate Index Number(s): \_\_\_\_\_

Address(es) of Real Estate: 1621 THISTLE LANE, MUNSTER, IN 46321

**PETER BENJAMIN**  
**LAKE COUNTY AUDITOR**

SUBJECT TO: covenants, conditions, and restrictions of record,

Document No.(s) \_\_\_\_\_; \_\_\_\_\_; and to General Taxes

for \_\_\_\_\_ and subsequent years.

In Witness Whereof, said Grantor has caused its corporate seal to be hereto affixed, and has caused its name to be signed to these presents by its \_\_\_\_\_ President, and attested by its \_\_\_\_\_ Secretary, this 14th

day of February, 192000

Impress  
Corporate Seal  
Here

By \_\_\_\_\_  
C.M.S. DEVELOPERS, INC.  
(Name of Corporation)

Attest: Lorraine D. Sana  
LORRAINE D. SANA

Mad  
President  
su  
Secretary

98892

Chicago Title Insurance Company

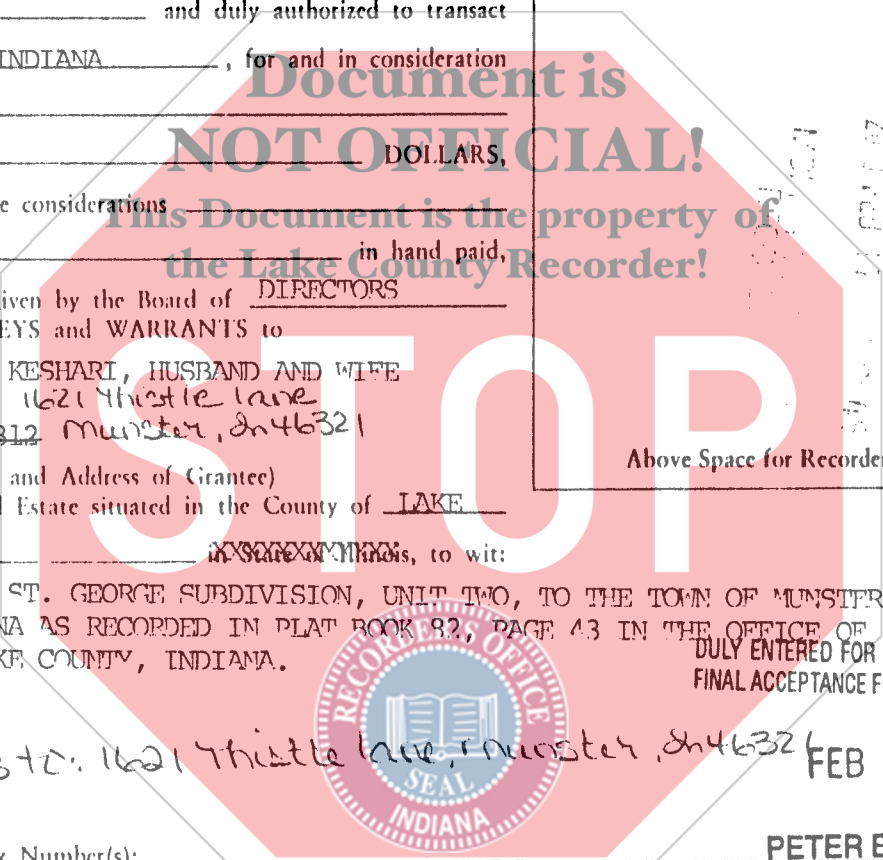

2000 011146

GEORGE E. COLE  
LEGAL FORMS

WARRANTY DEED  
Corporation to Individual

C.M.S. DEVELOPERS, INC.

BIMAL KUMAR & PRITI KESHARI

TO

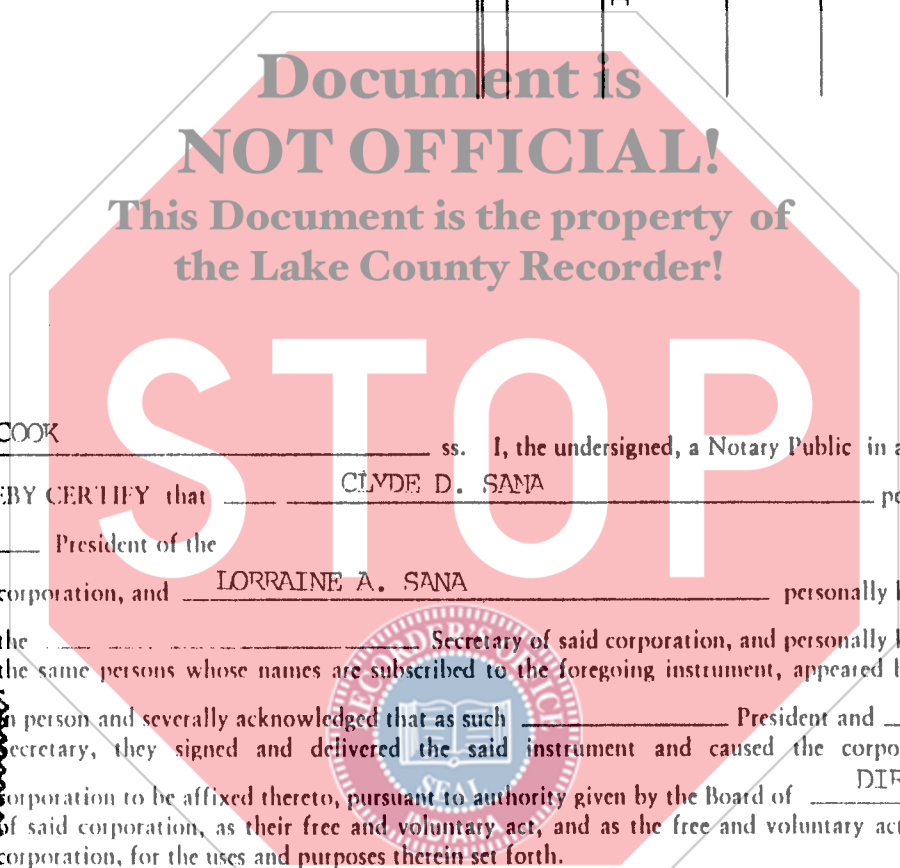

State of Illinois, County of COOK ss. I, the undersigned, a Notary Public in and for the County and State aforesaid, DO HEREBY CERTIFY that CLYDE D. SANA personally known to me to be the \_\_\_\_\_ President of the \_\_\_\_\_ corporation, and LORRAINE A. SANA personally known to me to be the \_\_\_\_\_ Secretary of said corporation, and personally known to me to be the same persons whose names are subscribed to the foregoing instrument, appeared before me this day in person and severally acknowledged that as such \_\_\_\_\_ President and \_\_\_\_\_ Secretary, they signed and delivered the said instrument and caused the corporate seal of said corporation to be affixed thereto, pursuant to authority given by the Board of \_\_\_\_\_ DIRECTORS of said corporation, as their free and voluntary act, and as the free and voluntary act and deed of said corporation, for the uses and purposes therein set forth.

OFFICIAL SEAL  
ARACELI REYES  
NOTARY PUBLIC  
MY COMMISSION EXPIRES 04/27/00

Given under my hand and official seal, this 3RD day of FEBRUARY 19 2000  
Commission expires \_\_\_\_\_ 19 \_\_\_\_\_  
Araceli Reyes  
NOTARY PUBLIC

This instrument was prepared by C.M.S. DEVELOPERS, INC. 7630 HARVEST DRIVE, SCHERERVILLE, IN 46375  
(Name and Address)

MAIL TO: Keshari  
(Name)  
1621 Thistle Lane  
(Address)  
Munster, IN 46321  
(City, State and Zip)

SEND SUBSEQUENT TAX BILLS TO:  
BIMAL KUMAR & PRITI KESHARI  
(Name)  
1621 THISTLE LANE  
(Address)  
MUNSTER, IN 46321  
(City, State and Zip)

OR RECORDER'S OFFICE BOX NO. \_\_\_\_\_  
(City, State and Zip)