

STATE OF INDIANA
LAKE COUNTY
FILED FOR RECORD

2000 010817

2000 FEB 16 AM 9:05

Parcel No. 41-276-26

MORRIS W. CANTER
RECORDER

WARRANTY DEED

ORDER NO. 920000351 - *Hut*

THIS INDENTURE WITNESSETH, That William H. Westmoreland

(Grantor)
of Lake County, in the State of INDIANA CONVEY(S) AND WARRANT(S)
to ALONZO BROWN AND RHONDA R. BROWN, HUSBAND AND WIFE

(Grantee)

of Lake County, in the State of INDIANA, for the sum of _____
TEN AND 00/100 Dollars (\$ 10.00)

and other valuable consideration, the receipt and sufficiency of which is hereby acknowledged, the following
described real estate in Lake County, State of Indiana:

Lot 26 in Block 2 in Aetna Manor Fourth Subdivision, in the City of Gary, as per plat thereof, recorded in Plat Book
29 page 99, in the Office of the Recorder of Lake County, Indiana.

SUBJECT TO PAST AND CURRENT YEAR REAL ESTATE TAXES
This Document is the property of the Lake County Recorder!

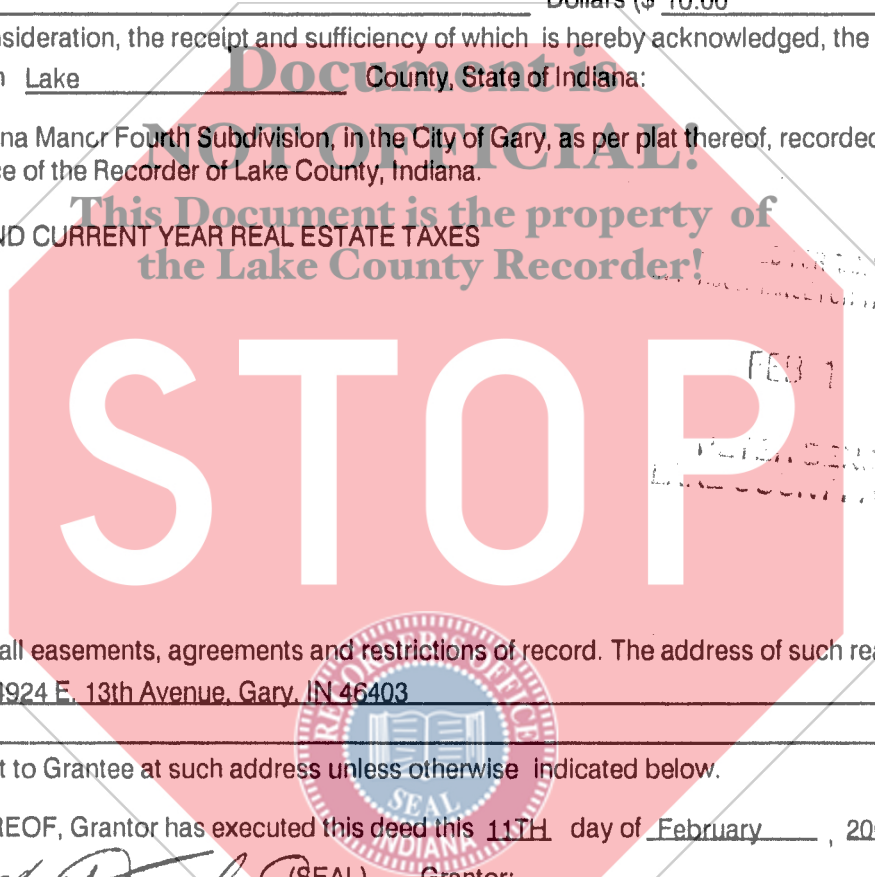

Subject to any and all easements, agreements and restrictions of record. The address of such real estate is
commonly known as 4924 E. 13th Avenue, Gary, IN 46403

Tax bills should be sent to Grantee at such address unless otherwise indicated below.

IN WITNESS WHEREOF, Grantor has executed this deed this 11TH day of February, 2000.
Grantor: *William H. Westmoreland* (SEAL) Grantor: _____ (SEAL)
Signature _____ Signature _____
Printed William H. Westmoreland Printed _____

STATE OF INDIANA }
COUNTY OF Lake } SS: ACKNOWLEDGEMENT

Before me, a Notary Public in and for said County and State, personally appeared _____
WILLIAM H. WESTMORELAND
who acknowledge the execution of the foregoing Warranty Deed, and who, having been duly sworn, stated that
any representation therein contained are true.
Witness my hand and Notarial Seal this 11TH day of February, 2000.

My commission expires: 3-14-07 Signature *Shannon Stienner*
Printed SHANNON STIENER, Notary Name
Resident of LAKE County, Indiana.

This instrument prepared by ATTY. THOMAS K. HOFFMAN
Return deed to *Hut*
Send tax bills to 658 Gillen St Gary IN 46403

*14.00
1/11*