

STATE OF INDIANA  
LAKE COUNTY  
FILED FOR RECORD

2000 002281

2000 JAN 11 PM 4:03

MORRIS W. CARTER  
RECORDER

A298-10  
R298-04

### QUITCLAIM DEED

THIS QUITCLAIM DEED, Executed this \_\_\_\_\_ day of \_\_\_\_\_, (year),

by first party, Grantor, Miller Doty  
whose post office address is 412 N Parke St. Gary In 46403  
to second party, Grantee, Earlean Doty and Delores Mayes  
whose post office address is 412 N. Parke St Gary In 46403

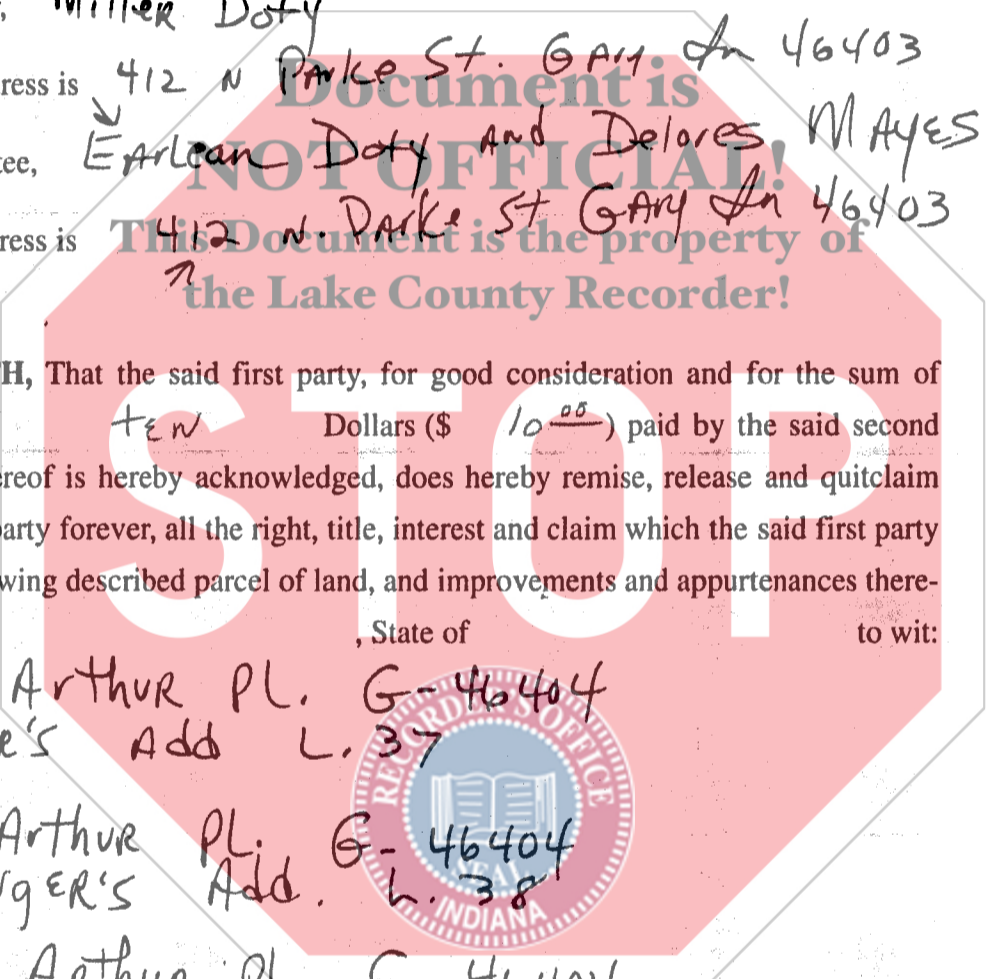

WITNESSETH, That the said first party, for good consideration and for the sum of ten Dollars (\$ 10<sup>00</sup>) paid by the said second party, the receipt whereof is hereby acknowledged, does hereby remise, release and quitclaim unto the said second party forever, all the right, title, interest and claim which the said first party has in and to the following described parcel of land, and improvements and appurtenances there- to in the County of \_\_\_\_\_, State of \_\_\_\_\_ to wit:

- ① 1563-65 Arthur Pl. G-46404  
L. GERLINGER'S Add L. 37
  - ② 1559-61 Arthur Pl. G-46404  
L. GERLINGER'S Add. L. 38
  - ③ 1555-57 Arthur Pl. G-46404  
L. GERLINGER'S Add. L. 39
- # 43-254-38, 39, 40

ZAHH (1)

Rev. 4/99

If your state requires 8 1/2" x 11" forms, cut off the bottom of this page at the dotted line.

DULY ENTERED FOR TAXATION SUBJECT TO  
FINAL ACCEPTANCE FOR TRANSFER.

JAN 11 2000

00612

PETER BENJAMIN  
LAKE COUNTY AUDITOR

16.00  
CASH



IN WITNESS WHEREOF, The said first party has signed and sealed these presents the day and year first above written. Signed, sealed and delivered in presence of:

Donita K Brewer  
Signature of Witness

[Signature]  
Signature of First Party

Donita K Brewer  
Print name of Witness

Miller Doty  
Print name of First Party

Gwendolyn C. Storey RA  
Signature of Witness

\_\_\_\_\_  
Signature of First Party

Gwendolyn C. Storey RA  
Print name of Witness

\_\_\_\_\_  
Print name of First Party

State of Indiana )  
County of Lake  
On 11th January, 2000 before me,  
appeared

personally known to me (or proved to me on the basis of satisfactory evidence) to be the person(s) whose name(s) is/are subscribed to the within instrument and acknowledged to me that he/she/they executed the same in his/her/their authorized capacity(ies), and that by his/her/their signature(s) on the instrument the person(s), or the entity upon behalf of which the person(s) acted, executed the instrument.

WITNESS my hand and official seal.

Hilda H. Rosain  
Signature of Notary

Affiant        Known        Produced ID  
Type of ID 7-23-00 (Seal)

State of Indiana )  
County of Lake  
On        before me,  
appeared

personally known to me (or proved to me on the basis of satisfactory evidence) to be the person(s) whose name(s) is/are subscribed to the within instrument and acknowledged to me that he/she/they executed the same in his/her/their authorized capacity(ies), and that by his/her/their signature(s) on the instrument the person(s), or the entity upon behalf of which the person(s) acted, executed the instrument.

WITNESS my hand and official seal.

Hilda H. Rosain  
Signature of Notary

Affiant        Known        Produced ID  
Type of ID        (Seal)



[Signature]  
Signature of Preparer

Miller Doty  
Print Name of Preparer

412 N. Park St  
Address of Preparer

(2)

If your state requires 8 1/2" x 11" forms, cut off the bottom of this page at the dotted line.