

STATE OF INDIANA  
LAKE COUNTY  
FILED FOR RECORD

2000 001559

2000 JAN -7 PM 1:00

MORRIS W. CARTER  
RECORDER

A298-10  
R298-04

### QUITCLAIM DEED

THIS QUITCLAIM DEED, Executed this \_\_\_\_\_ day of \_\_\_\_\_, (year),

by first party, Grantor, Dominic Bernardi

whose post office address is 7100 Birch Ave., Gary, IN 46403

to second party, Grantee, Gina Bernardi & Dominic Bernardi

whose post office address is 7100 Birch Ave., Gary, IN 46403

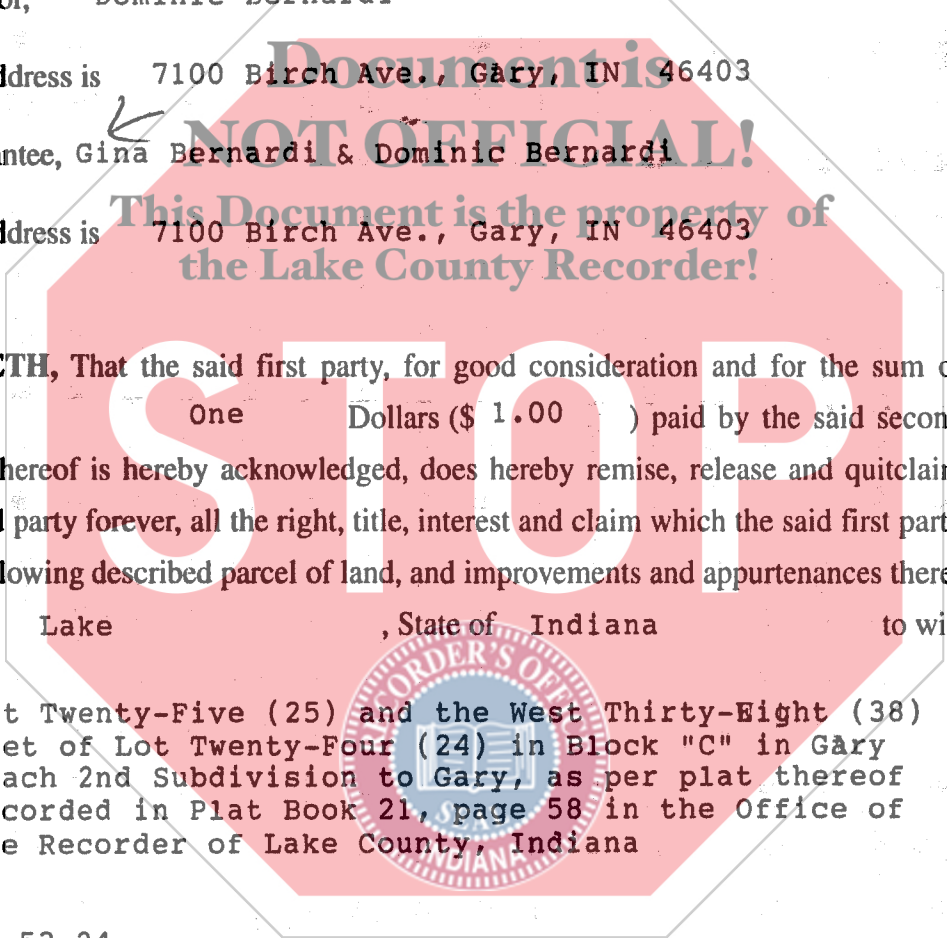

WITNESSETH, That the said first party, for good consideration and for the sum of One Dollars (\$ 1.00 ) paid by the said second party, the receipt whereof is hereby acknowledged, does hereby remise, release and quitclaim unto the said second party forever, all the right, title, interest and claim which the said first party has in and to the following described parcel of land, and improvements and appurtenances there- to in the County of Lake, State of Indiana to wit:

Lot Twenty-Five (25) and the West Thirty-Eight (38) feet of Lot Twenty-Four (24) in Block "C" in Gary Beach 2nd Subdivision to Gary, as per plat thereof recorded in Plat Book 21, page 58 in the Office of the Recorder of Lake County, Indiana

Key No: 43-53-24

ACCEPTANCE FOR TRANSFER

JAN 07, 2000

PETER BENJAMIN  
COUNTY CLERK

ZZHF  
(1)

Rev. 6/98

If your state requires 8 1/2" x 11" forms, cut off the bottom of this page at the dotted line.

00002



© E-Z Legal Forms. Before you use this form, read it, fill in all blanks, and make whatever changes are necessary to your particular transaction. Consult a lawyer if you doubt the form's fitness for your purpose and use. E-Z Legal Forms and the retailer make no representation or warranty, express or implied, with respect to the merchantability of this form for an intended use or purpose.

05  
1600  
AB

IN WITNESS WHEREOF, The said first party has signed and sealed these presents the day and year first above written. Signed, sealed and delivered in presence of:

\_\_\_\_\_  
Signature of Witness

*Romina Bernardi*  
Signature of First Party

\_\_\_\_\_  
Print name of Witness

DOMINIC BERNARDI  
Print name of First Party

\_\_\_\_\_  
Signature of Witness

\_\_\_\_\_  
Signature of First Party

\_\_\_\_\_  
Print name of Witness

\_\_\_\_\_  
Print name of First Party

State of INDIANA )  
County of LAKE  
On Dec 29, 1999 before me,  
appeared DOMINIC BERNARDI

personally known to me (or proved to me on the basis of satisfactory evidence) to be the person(s) whose name(s) is/are subscribed to the within instrument and acknowledged to me that he/she/they executed the same in his/her/their authorized capacity(ies), and that by his/her/their signature(s) on the instrument the person(s), or the entity upon behalf of which the person(s) acted, executed the instrument.  
WITNESS my hand and official seal.

*[Signature]*  
Signature of Notary

Affiant \_\_\_\_\_ Known \_\_\_\_\_ Produced ID \_\_\_\_\_  
Type of ID \_\_\_\_\_ (Seal)

State of )  
County of )  
On before me,  
appeared

personally known to me (or proved to me on the basis of satisfactory evidence) to be the person(s) whose name(s) is/are subscribed to the within instrument and acknowledged to me that he/she/they executed the same in his/her/their authorized capacity(ies), and that by his/her/their signature(s) on the instrument the person(s), or the entity upon behalf of which the person(s) acted, executed the instrument.  
WITNESS my hand and official seal.

\_\_\_\_\_  
Signature of Notary

Affiant \_\_\_\_\_ Known \_\_\_\_\_ Produced ID \_\_\_\_\_  
Type of ID \_\_\_\_\_ (Seal)

*[Signature]*  
Signature of Preparer

Gina Bernardi  
Print Name of Preparer

7100 Birch Ave  
Address of Preparer

(2)

-----  
If your state requires 8 1/2" x 11" forms, cut off the bottom of this page at the dotted line.