

2000 000317

STATE OF INDIANA  
LAKE COUNTY  
FILED FOR RECORD

2000 JAN -4 PM 12: 34

MORRIS W. CARTER  
RECORDER

THIS FORM HAS BEEN PREPARED FOR USE IN THE STATE OF INDIANA BY LAWYERS ONLY. THE SELECTION OF A FORM OF INSTRUMENT, FILLING IN BLANK SPACES, STRIKING OUT PROVISIONS, AND INSERTION OF SPECIAL CLAUSES, MAY CONSTITUTE THE PRACTICE OF LAW WHICH SHOULD ONLY BE DONE BY A LAWYER.

MAIL TAX BILLS TO:

### QUITCLAIM DEED

THIS INDENTURE WITNESSETH, that **Helen L. Rueth**

GRANTOR(S) of **Lake** County in the State of **Indiana**

QUITCLAIM(S) to **Herbert Rueth and/or Robert Rueth, as Trustees**

GRANTEE(S) of **Lake** County in the State of **Indiana**

in consideration of One Dollar (\$1.00) and other valuable consideration, the receipt and sufficiency of which are hereby acknowledged, the following described real estate in **Lake** County, in the State of Indiana:

**Woodmar Unit 14 all lots 33 and 34, Block 47,  
South Half lot 35, Block 47**

**commonly known as 7441 Knickerbocker, Hammond, Indiana 46323**

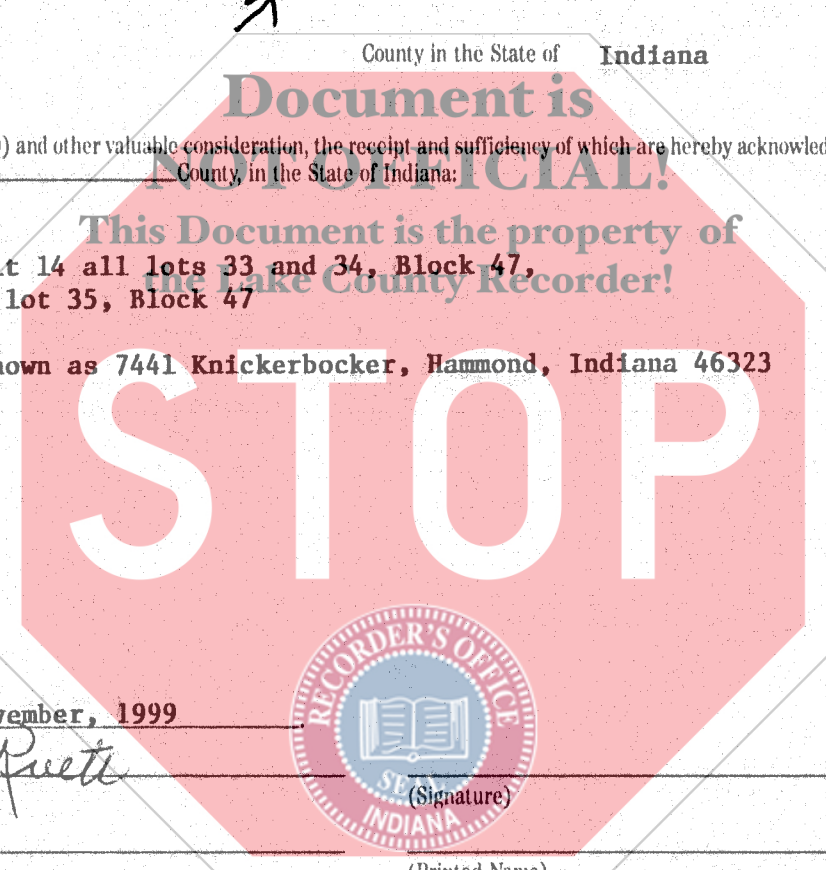

Dated this 30 day of **November, 1999**

*Helen L. Rueth*  
(Signature)

**HELEN L. RUETH**  
(Printed Name)

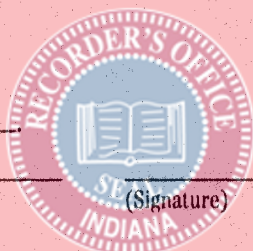

(Signature)

(Printed Name)

(Signature)

(Signature)

(Printed Name)

(Printed Name)

STATE OF INDIANA, COUNTY OF **LAKE** SS:

Before me, the undersigned, a Notary Public in and for said County and State, this 30 day of **November, 1999**, personally appeared:

**Helen L. Rueth** and acknowledged the execution of the foregoing deed. In witness whereof, I have hereunto subscribed my name and affixed my official seal.

My commission expires: 4-7-08 Signature Barbara A. Rueth

Resident of Lake County Printed Barbara A. Rueth, Notary Public

This instrument prepared by William H. Robinson, 5261 Hohman Ave, Hammond, IN Attorney at Law, Attorney No. 1832-45

FINAL ACCEPTANCE FOR TRANSFER. **46320**

MAIL TO:

© COPYRIGHT, THE ALLEN COUNTY INDIANA BAR ASSOCIATION, INC. (REV 2/97)

JAN 04 2000

PETER BENJAMIN  
LAKE COUNTY AUDITOR

9855 Swin Creek Blvd. Munster 46321 ←

1400  
su  
W