

2

99088671

STATE OF INDIANA
LAKE COUNTY
FILED FOR RECORD

99 OCT 27 PM 2:09

M. J. CARTER
RECORDER

A298-10
R298-04

QUITCLAIM DEED

THIS QUITCLAIM DEED, Executed this 13 day of OCTOBER , 19 99 ,

by first party, Grantor, HELEN KIRBY

whose post office address is 14 INDIAN TRAIL
MERRILLVILLE, IN 46410

to second party, Grantee, HELEN KIRBY, BETSY KIRBY, CINDY KIRBY, TAMMY KIRBY, AND
ZORINE KIRBY J/T WITH R/S

whose post office address is HELEN KIRBY RESERVES A LIFE ESTATE,
14 INDIAN TRAIL
MERRILLVILLE, IN 46410

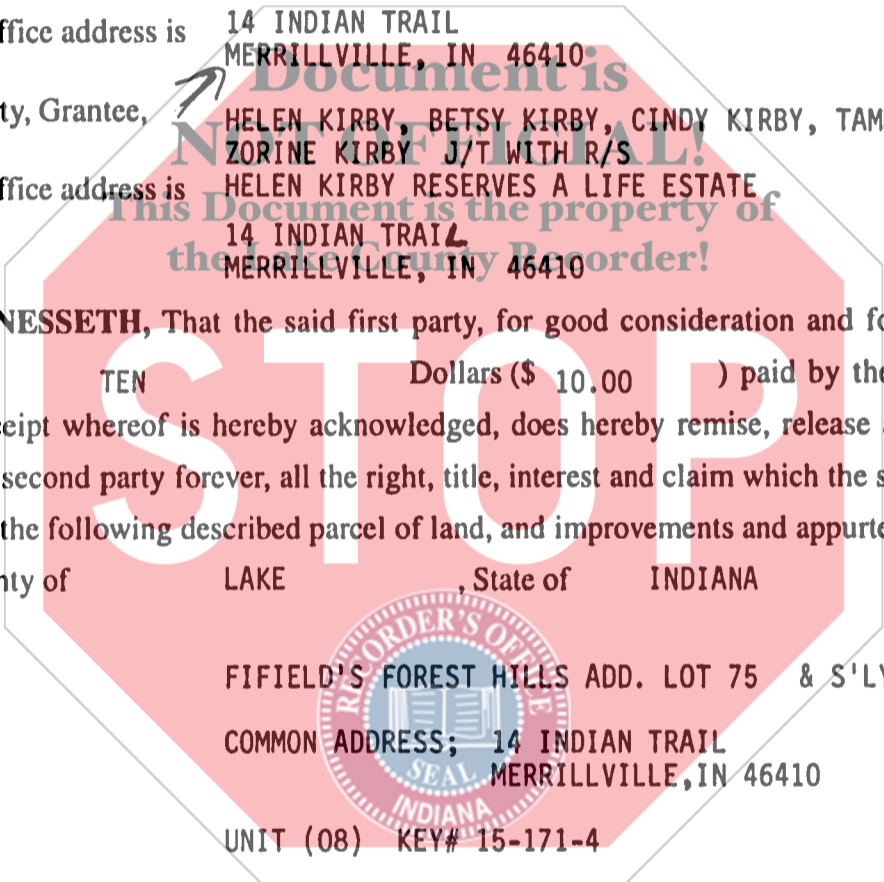

WITNESSETH, That the said first party, for good consideration and for the sum of TEN Dollars (\$ 10.00) paid by the said second party, the receipt whereof is hereby acknowledged, does hereby remise, release and quitclaim unto the said second party forever, all the right, title, interest and claim which the said first party has in and to the following described parcel of land, and improvements and appurtenances there- to in the County of LAKE , State of INDIANA to wit:

FIFIELD'S FOREST HILLS ADD. LOT 75 & S'LY PT. OF LOT 76
COMMON ADDRESS; 14 INDIAN TRAIL
MERRILLVILLE, IN 46410
UNIT (08) KEY# 15-171-4

TAX MAILING ADDRESS
14 INDIAN TRAIL
MERRILLVILLE, IN 46410

DULY ENTERED FOR TAXATION SUBJECT TO
FINAL ACCEPTANCE FOR TRANSFER.

OCT 27 1999

PETER BENJAMIN
LAKE COUNTY AUDITOR

ATHE
(1)

(Revised 3/97)

If your state requires 8 1/2" x 11" forms, cut off the bottom of this page at the dotted line.

001867

12.06
E.P.
CS



IN WITNESS WHEREOF, The said first party has signed and sealed these presents the day and year first above written. Signed, sealed and delivered in presence of:

Julie McLaughlin
Signature of Witness

Helen Kirby
Signature of First Party HELEN KIRBY

JULIE McLAUGHLIN
Print name of Witness

Print name of First Party

Signature of Witness

Signature of First Party

Print name of Witness

Print name of First Party

State of Indiana)
County of State
On October 27, 1998 before me,
appeared Helen Kirby

personally known to me (or proved to me on the basis of satisfactory evidence) to be the person(s) whose name(s) is/are subscribed to the within instrument and acknowledged to me that he/she/they executed the same in his/her/their authorized capacity(ies), and that by his/her/their signature(s) on the instrument the person(s), or the entity upon behalf of which the person(s) acted, executed the instrument.
WITNESS my hand and official seal.

Joanne Chang
Signature of Notary

NOTARY PUBLIC, Lake County, Indiana
My Commission Expires March 25, 2000

Affiant Known Produced ID
Type of ID _____
(Seal)

State of Indiana)
County of State
On October 27, 1998 before me,
appeared Helen Kirby

personally known to me (or proved to me on the basis of satisfactory evidence) to be the person(s) whose name(s) is/are subscribed to the within instrument and acknowledged to me that he/she/they executed the same in his/her/their authorized capacity(ies), and that by his/her/their signature(s) on the instrument the person(s), or the entity upon behalf of which the person(s) acted, executed the instrument.
WITNESS my hand and official seal.

Joanne Chang
Signature of Notary

NOTARY PUBLIC, Lake County, Indiana
My Commission Expires March 25, 2000

Affiant Known Produced ID
Type of ID _____
(Seal)

Helen Kirby
Signature of Preparer HELEN KIRBY

Helen Kirby
Print Name of Preparer HELEN KIRBY

14 INDIAN TRAIL MERRILLVILLE, IN 46410
Address of Preparer

(2)

If your state requires 8 1/2" x 11" forms, cut off the bottom of this page at the dotted line.