

2

STATE OF INDIANA
LAKE COUNTY
FILED FOR RECORD

99086403

99 OCT 20 AM 11:51

MORRIS W. CARTER
RECORDER

A298-10
R298-04

QUITCLAIM DEED

THIS QUITCLAIM DEED, Executed this 1st day of June, 1999 (year),

by first party, Grantor, Belinda Johnson

whose post office address is 5149 E. 13th Pl.
Gary, Indiana 46403

to second party, Grantee, Alced Lafitte and Ivette Lafitte *H&W*

whose post office address is 1040 Decatur St.
Gary, Indiana 46403

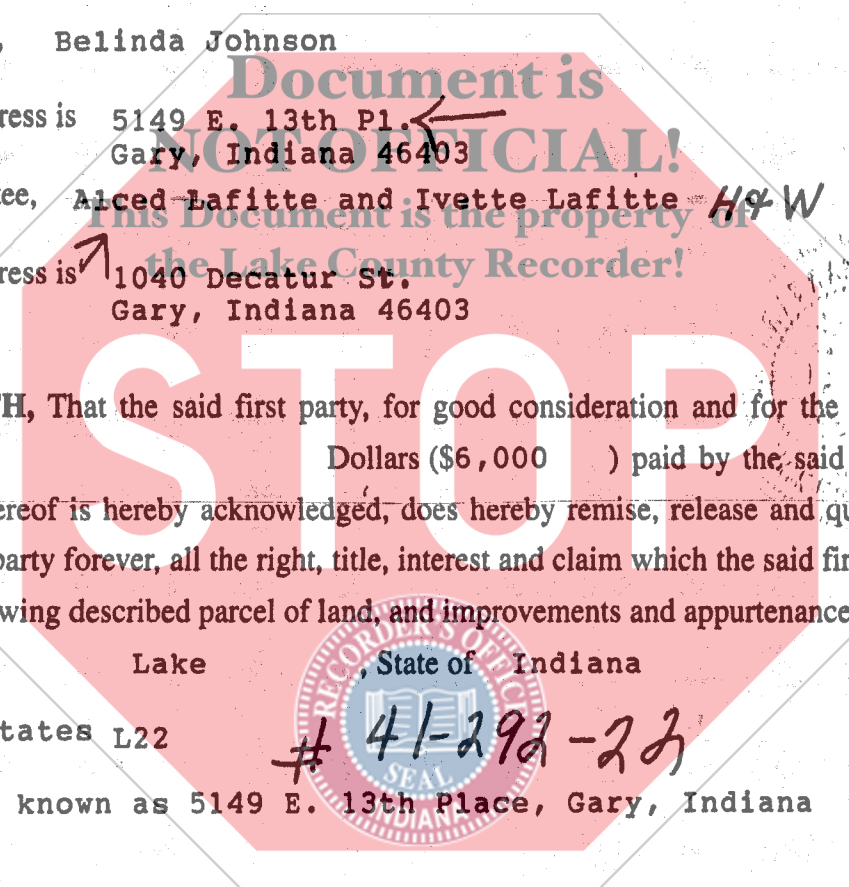

WITNESSETH, That the said first party, for good consideration and for the sum of Six Thousand Dollars (\$6,000) paid by the said second party, the receipt whereof is hereby acknowledged, does hereby remise, release and quitclaim unto the said second party forever, all the right, title, interest and claim which the said first party has in and to the following described parcel of land, and improvements and appurtenances there-

to in the County of Lake, State of Indiana to wit:

Aetna Estates L22
Commonly known as 5149 E. 13th Place, Gary, Indiana

41-292-22

AKHH

(1)

Rev. 6/98

If your state requires 8 1/2" x 11" forms, cut off the bottom of this page at the dotted line.
DULY ENTERED FOR TAXATION SUBJECT TO FINAL ACCEPTANCE FOR TRANSFER.

OCT 20 1999

PETER BENJAMIN
LAKE COUNTY AUDITOR

001331



© E-Z Legal Forms. Before you use this form, read it, fill in all blanks, and make whatever changes are necessary to your particular transaction. Consult a lawyer if you doubt the form's fitness for your purpose and use. E-Z Legal Forms and the retailer make no representation or warranty, express or implied, with respect to the merchantability of this form for an intended use or purpose.

Handwritten initials: SU, CS

IN WITNESS WHEREOF, The said first party has signed and sealed these presents the day and year first above written. Signed, sealed and delivered in presence of:

Shirley Lafitte
Signature of Witness

Belinda Johnson
Signature of First Party

Shirley Lafitte
Print name of Witness

Belinda Johnson
Print name of First Party

Alced Lafitte, Sr.
Signature of Witness

Alced Lafitte Ivette Lafitte
Signature of First Party

ALCED LAFITTE, Sr.
Print name of Witness

ALCED LAFITTE Ivette Lafitte
Print name of First Party

State of INDIANA
County of LAKE
On August 2-99 before me, Ivette Lafitte
appeared

personally known to me (or proved to me on the basis of satisfactory evidence) to be the person(s) whose name(s) is/are subscribed to the within instrument and acknowledged to me that he/she/they executed the same in his/her/their authorized capacity(ies), and that by his/her/their signature(s) on the instrument the person(s), or the entity upon behalf of which the person(s) acted, executed the instrument.
WITNESS my hand and official seal.

Document is
Not for
Distribution
This Document is the property of
the Lake County Recorder!

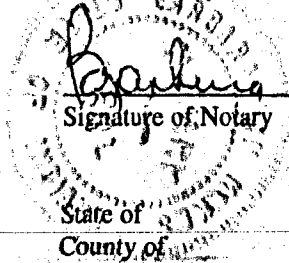
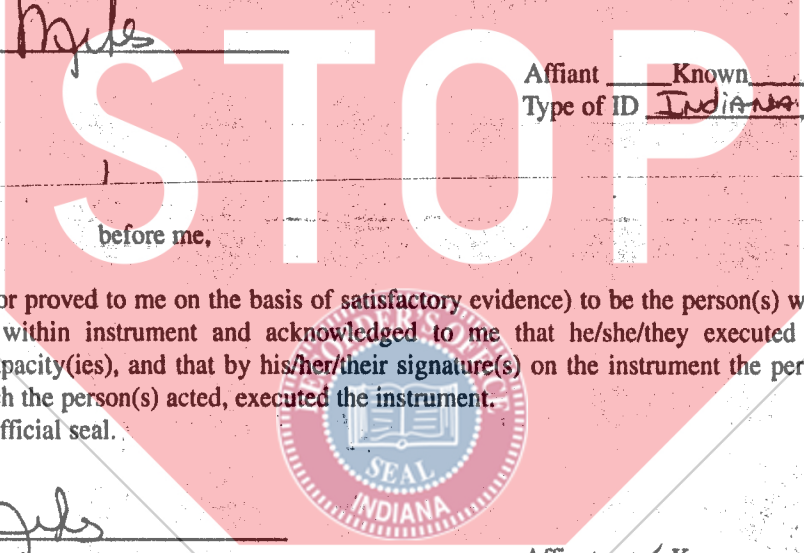

Barbara Ables
Signature of Notary

Affiant Known Produced ID
Type of ID Indiana Drivers License
(Seal)

State of INDIANA
County of LAKE
On August 2-99 before me,
appeared

personally known to me (or proved to me on the basis of satisfactory evidence) to be the person(s) whose name(s) is/are subscribed to the within instrument and acknowledged to me that he/she/they executed the same in his/her/their authorized capacity(ies), and that by his/her/their signature(s) on the instrument the person(s), or the entity upon behalf of which the person(s) acted, executed the instrument.
WITNESS my hand and official seal.

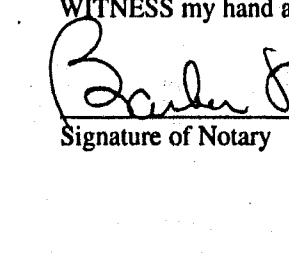

Barbara Ables
Signature of Notary

Affiant Known Produced ID
Type of ID Drivers License
(Seal)

Belinda Johnson
Signature of Preparer

Belinda Johnson
Print Name of Preparer

5149 E. 13th Place-Gary, Ind.
Address of Preparer

(2)

If your state requires 8 1/2" x 11" forms, cut off the bottom of this page at the dotted line.